

01 Section 01  
Scale: 1:200

NOTES: Do not scale this drawing. All dimensions to be checked on site prior to commencement or manufacture.

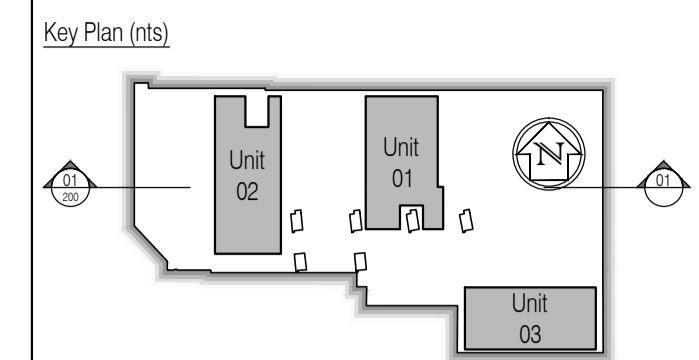

All existing building fabric, services, structural steelwork, etc. shown indicative only acquired from McD.L Surveys Ltd information

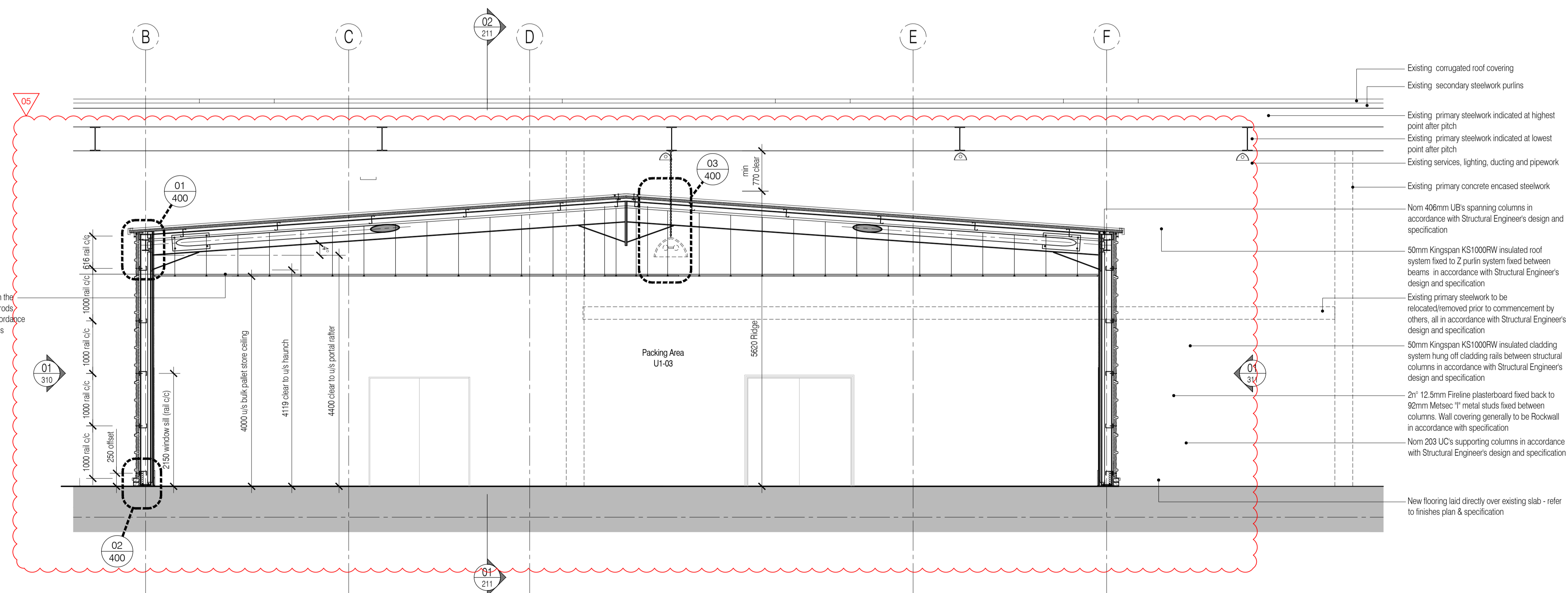

Suspended ceiling grid in accordance with the reflected ceiling plan, hung on adjustable rods system from sub rails below purlins in accordance with Manufacturer's design and instructions

- Existing corrugated roof covering
- Existing secondary steelwork purlins
- Existing primary steelwork indicated at highest point after pitch
- Existing primary steelwork indicated at lowest point after pitch
- Existing services, lighting, ducting and pipework
- Existing primary concrete encased steelwork
- Nom 406mm UB's spanning columns in accordance with Structural Engineer's design and specification
- 50mm Kingspan KS1000RW insulated roof system fixed to Z purlin system fixed between beams in accordance with Structural Engineer's design and specification
- Existing primary steelwork to be relocated/removed prior to commencement by others, all in accordance with Structural Engineer's design and specification
- 50mm Kingspan KS1000RW insulated cladding system hung off cladding rails between structural columns in accordance with Structural Engineer's design and specification
- 2x 12.5mm Fireline plasterboard fixed back to 92mm Metsec 'T' metal studs fixed between columns. Wall covering generally to be Rockwall in accordance with specification
- Nom 203 UC's supporting columns in accordance with Structural Engineer's design and specification
- New flooring laid directly over existing slab - refer to finishes plan & specification

CONSTRUCTION ISSUE

Rev	Date	By	CHK	Comment
05	08.03.11	RKC	JAS	Revised to suit structural redesign
04	21.12.10	JAS	HL	Issued for Construction
03	22.11.10	JAS	AC	Issued for Construction
02	06.10.10	RKC	JAS	Issued for Tender
01	01.10.10	RKC	JAS	Refs added

BRINGING IDEAS TO LIFE

**FRANKHAM**

Frankham Consultancy Group Limited  
21 Perrymount Road  
Haywards Heath RH16 3TP  
t 01444 444900 f 01444 455642  
enquire@frankham.com  
www.frankham.com

Client

Project Title

Euston Station  
Parcel Deck  
Rail Gourmet Facility

Drawing Title

General Arrangement  
Section 02  
Unit 1

Drawn by: RKC	Scale: 1:200, 1:50@A1	Date: 15.09.10
Designed by: FCG	Checked by: JAS	Approved by: AC

File Ref.:	X:\FRANKHAM\CG\444900\1\01444\2010\MARCH2010_SECTION02	20.06.11.14.25.01
Drawing No.	440272-A-210	Rev. 05

02 Unit 01 Section 01  
Scale: 1:50