

NOTES: Do not scale this drawing. All dimensions to be checked on site prior to commencement or manufacture.

Key Plan (nts)

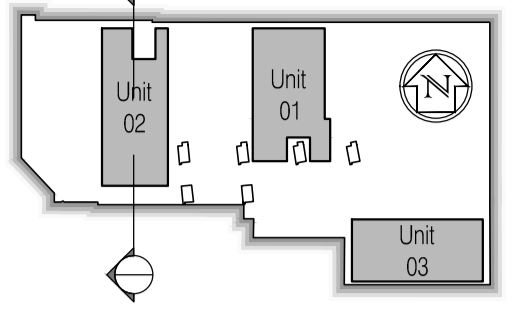

All existing building fabric, services, structural steelwork, etc. shown indicative only acquired from McDL Surveys Ltd information

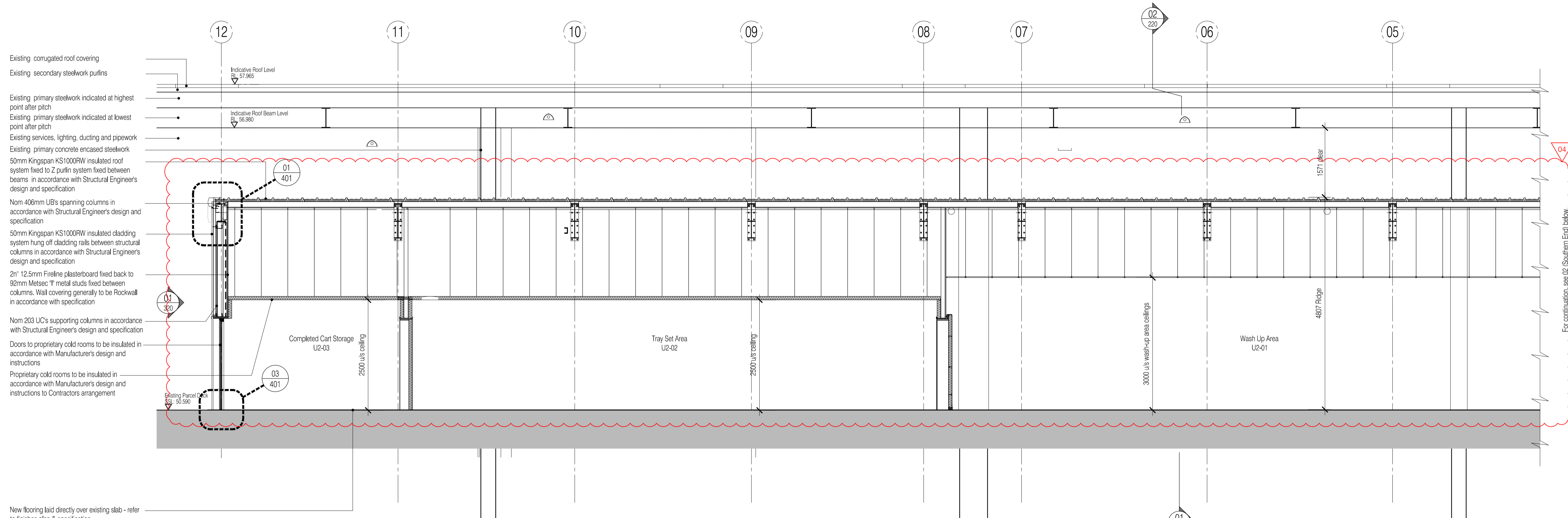

- Existing corrugated roof covering
- Existing secondary steelwork purlins
- Existing primary steelwork indicated at highest point after pitch
- Existing primary steelwork indicated at lowest point after pitch
- Existing services, lighting, ducting and pipework
- Existing primary concrete encased steelwork
- 50mm Kingspan KS1000RW insulated roof system fixed to Z purlin system fixed between beams in accordance with Structural Engineer's design and specification
- Nom 406mm UB's spanning columns in accordance with Structural Engineer's design and specification
- 50mm Kingspan KS1000RW insulated cladding system hung off cladding rails between structural columns in accordance with Structural Engineer's design and specification
- 2m<sup>2</sup> 12.5mm Fireline plasterboard fixed back to 92mm Metsec T<sup>1</sup> metal studs fixed between columns. Wall covering generally to be Rockwall in accordance with specification
- Nom 203 UC's supporting columns in accordance with Structural Engineer's design and specification
- Doors to proprietary cold rooms to be insulated in accordance with Manufacturer's design and instructions
- Proprietary cold rooms to be insulated in accordance with Manufacturer's design and instructions to Contractors arrangement

New flooring laid directly over existing slab - refer to finishes plan & specification

01 Section 02 (South End)  
Scale: 1:50

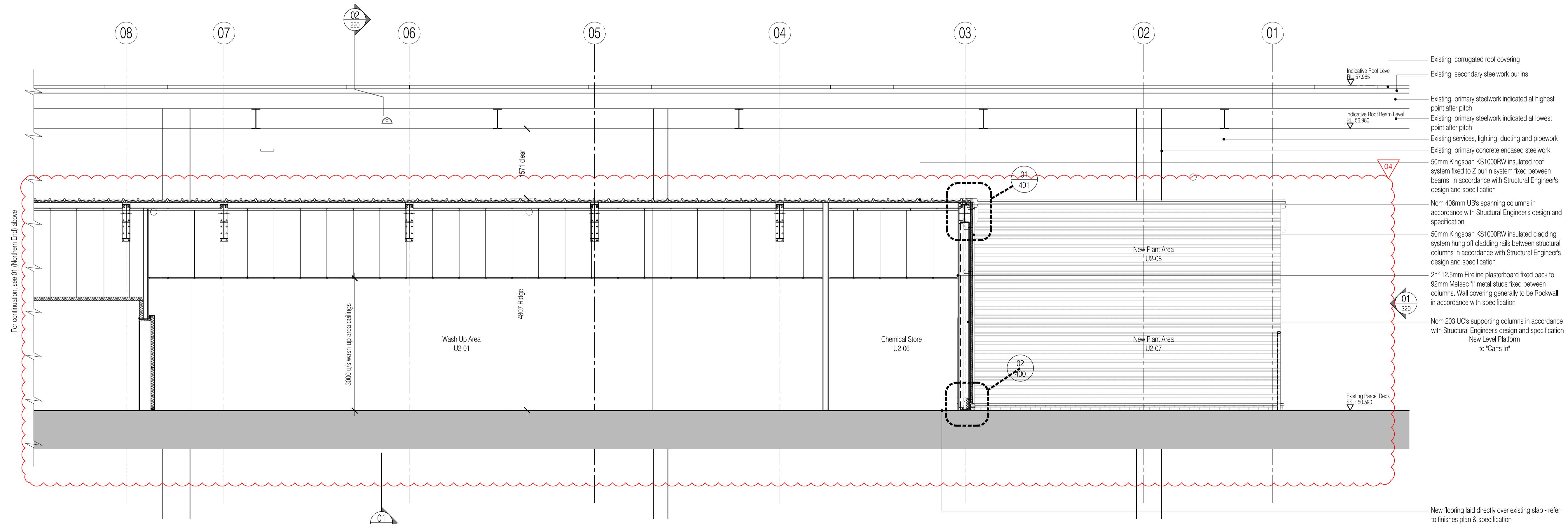

- Existing corrugated roof covering
- Existing secondary steelwork purlins
- Existing primary steelwork indicated at highest point after pitch
- Existing primary steelwork indicated at lowest point after pitch
- Existing services, lighting, ducting and pipework
- Existing primary concrete encased steelwork
- 50mm Kingspan KS1000RW insulated roof system fixed to Z purlin system fixed between beams in accordance with Structural Engineer's design and specification
- Nom 406mm UB's spanning columns in accordance with Structural Engineer's design and specification
- 50mm Kingspan KS1000RW insulated cladding system hung off cladding rails between structural columns in accordance with Structural Engineer's design and specification
- 2m<sup>2</sup> 12.5mm Fireline plasterboard fixed back to 92mm Metsec T<sup>1</sup> metal studs fixed between columns. Wall covering generally to be Rockwall in accordance with specification
- Nom 203 UC's supporting columns in accordance with Structural Engineer's design and specification
- New Level Platform to 'Carts In'

New flooring laid directly over existing slab - refer to finishes plan & specification

02 Section 02 (North End)  
Scale: 1:50

**CONSTRUCTION ISSUE**

Rev	Date	By	CHK	Comment
04	28.02.11	RKC	JAS	Revised to suit structural design
03	22.11.10	JAS	AC	Issued for Construction
02	06.10.10	RKC	JAS	Issued for Tender
01	05.10.10	RKC	JAS	General revisions

BRINGING IDEAS TO LIFE



**FRANKHAM**

**Frankham Consultancy Group Limited**  
21 Parnham Road  
Haywards Heath RH16 3TP  
t 01444 444900 f 01444 455642  
enquire@frankham.com  
www.frankham.com

Client

Project Title

Euston Station  
Parcel Deck  
Rail Gourmet Facility

Drawing Title

General Arrangements  
Section 02  
Unit 2

Drawn by: RKC	Scale: 1:50@A1	Date: 23.09.10
Designed by: FCG	Checked by: JAS	Approved by: AC

File Ref.: 444900-02-EUSTON-PARCEL-DECK-ARCH-02-02-SECTION2 13.11.09.15.14.20

Drawing No. 440272-A-221	Rev. 04
-----------------------------	------------