

NB: All information based on supplied third party survey information. All discrepancies to be reported to RDJW immediately upon discovery.

All Services, M&E and Structural information shown indicative only. Please refer to relevant Specialist Consultant documentation.

NB: All levels are approximate and are subject to further site investigation prior to construction. All discrepancies to be reported to RDJW immediately.

It is the responsibility of the Client to manage the Health and Safety aspects of the project or nominate and agree a "Principle Designer".

- xref's loaded in file

1. CONTRACTOR IS RESPONSIBLE FOR ALL SETTING OUT AND MUST CHECK DIMENSIONS ON SITE BEFORE WORK IS PUT IN HAND
2. WRITTEN DIMENSIONS ONLY TO BE TAKEN THIS DRAWING MUST NOT BE SCALED
3. ARCHITECT TO BE IMMEDIATELY NOTIFIED OF SUSPECTED OMISSIONS OR DISCREPANCIES

REVISIONS	DATE	BY
C1 ISSUED FOR CONSTRUCTION	24.10.16	rkc

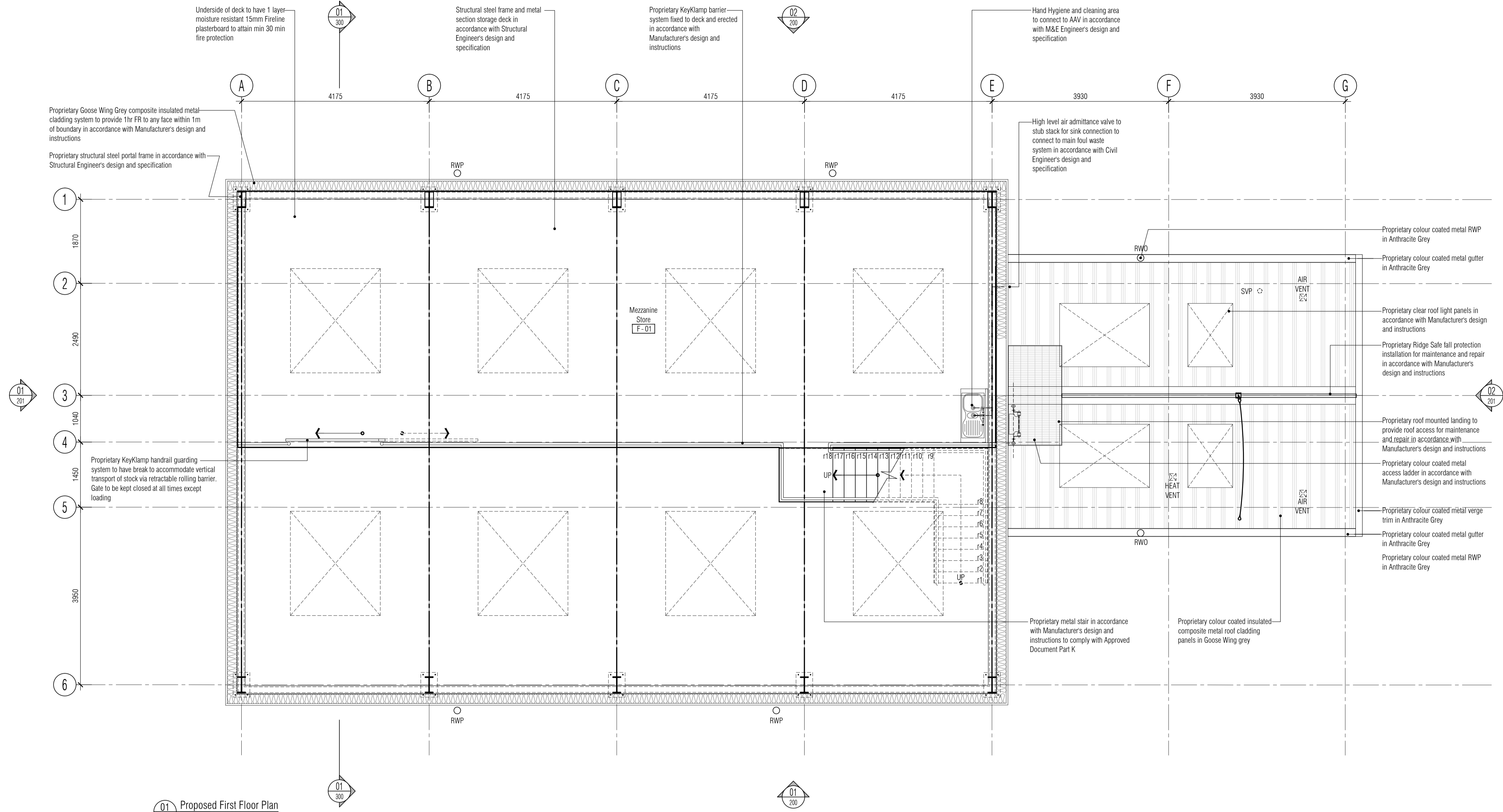

STAIRCASE CRITERIA		Storage Deck Stair
Ground to First	floor total rise	= 3000 mm
18 number of RISERS	@	= 166.66 mm
17 number of GOINGS	@	= 250 mm
PITCH of stair to be		= 33.7 °
Overall STRINGS to be		= 1180 mm

Height to top of handrail to be min 900mm
Height to top of guarding to be max 1100mm
Min 2000mm clear headroom above stair pitch line.

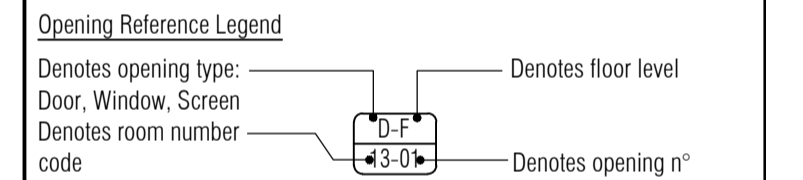

ISSUED FOR CONSTRUCTION

RDJW
ARCHITECTS



RDJW ARCHITECTS LIMITED
QUOIN HOUSE . 9-11 EAST PARK
CRAWLEY . WEST SUSSEX . RH10 6AN
TEL: 01293 404300 . FAX: 01293 404299
E M A I L : info@rdjwarchitects.co.uk
W E B S I T E : www.rdjwarchitects.co.uk

PROJECT
**NEW SHOWROOM
HORSHAM FLOORINGS
AND FURNISHINGS
HORSHAM**

PROPOSED
FIRST FLOOR
PLAN

DATE	04.01.16	SCALE	1:50 @ A1
DRAWN	RKC	DRG. NO.	4817-122
CHECKED		REV.	C1