

NB: All levels are approximate and are subject to further site investigation prior to construction. All discrepancies to be reported to RDJW immediately

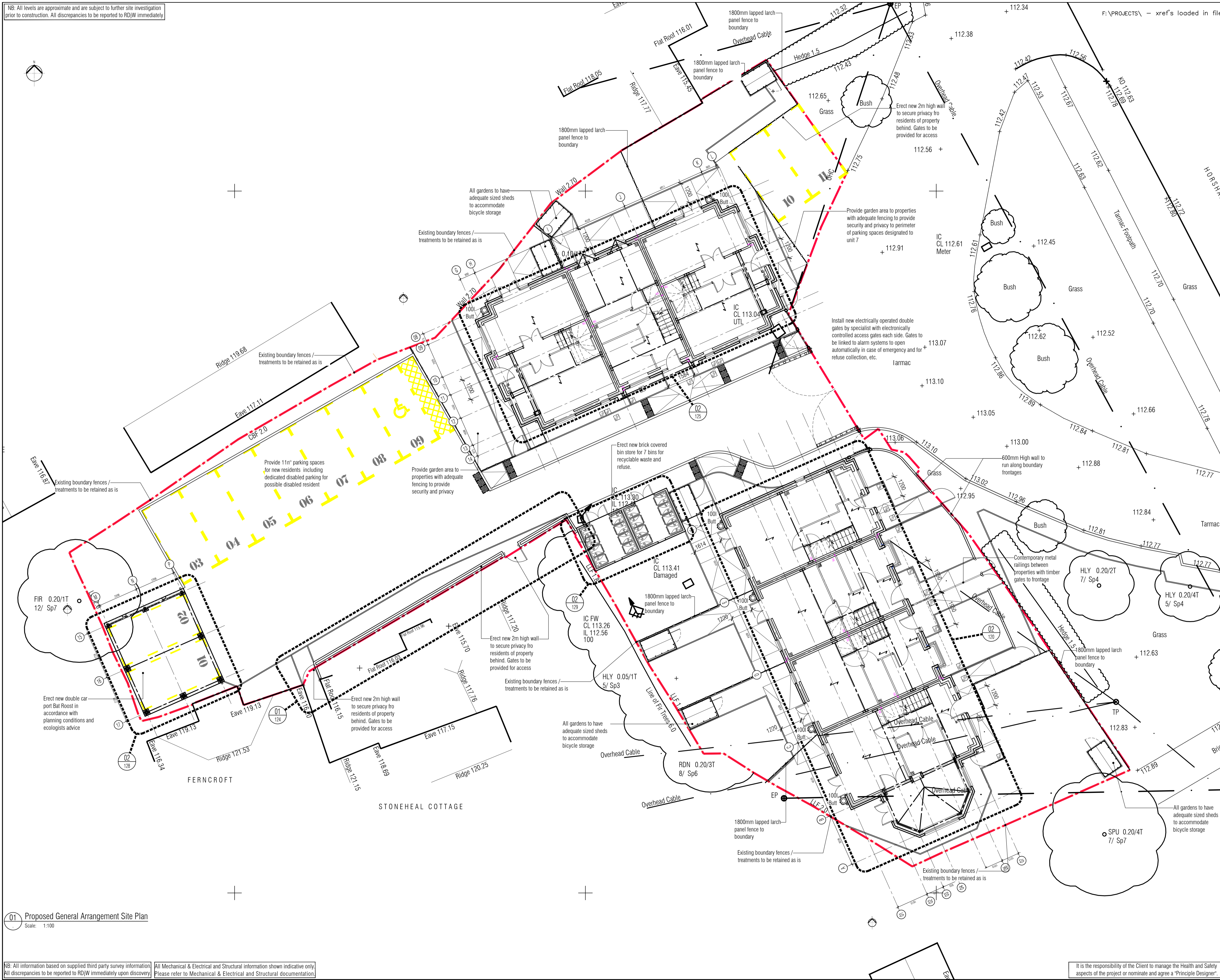

1. CONTRACTOR IS RESPONSIBLE FOR ALL SETTING OUT AND MUST CHECK DIMENSIONS ON SITE BEFORE WORK IS PUT IN HAND
2. WRITTEN DIMENSIONS ONLY TO BE TAKEN THIS DRAWING MUST NOT BE SCALED
3. ARCHITECT TO BE IMMEDIATELY NOTIFIED OF SUSPECTED OMISSIONS OR DISCREPANCIES

REVISIONS	DATE	BY
ISSUED FOR CONSTRUCTION	24.10.16	rkc

01 Proposed General Arrangement Site Plan
Scale: 1:100

NB: All information based on supplied third party survey information. All Mechanical & Electrical and Structural information shown indicative only. All discrepancies to be reported to RDJW immediately upon discovery. Please refer to Mechanical & Electrical and Structural documentation.

It is the responsibility of the Client to manage the Health and Safety aspects of the project or nominate and agree a 'Principle Designer'.

RDJW ARCHITECTS



RDJW ARCHITECTS LIMITED
QUOIN HOUSE, 9-11 EAST PARK CRAWLEY, WEST SUSSEX, RH10 6AN
TEL: 01293 404300 . FAX: 01293 404299
EMAIL: info@rdjwarchitects.co.uk
WEBSITE: www.rdjwarchitects.co.uk

PROJECT
Devon House
Horsham Road
South Holmwood
RH5 4NG
Luminar
DEVELOPMENTS

Proposed
General Arrangement
Site Plan

DATE	06.04.16	SCALE	1:100 @ A1
DRAWN	RKC	DRG. NO.	4834-020
CHECKED		REV.	C1