

1. CONTRACTOR IS RESPONSIBLE FOR ALL SETTING OUT AND MUST CHECK DIMENSIONS ON SITE BEFORE WORK IS PUT IN HAND
2. WRITTEN DIMENSIONS ONLY TO BE TAKEN THIS DRAWING MUST NOT BE SCALED
3. ARCHITECT TO BE IMMEDIATELY NOTIFIED OF SUSPECTED OMISSIONS OR DISCREPANCIES

REVISIONS	DATE	BY
ISSUED FOR CONSTRUCTION	24.10.16	rkc

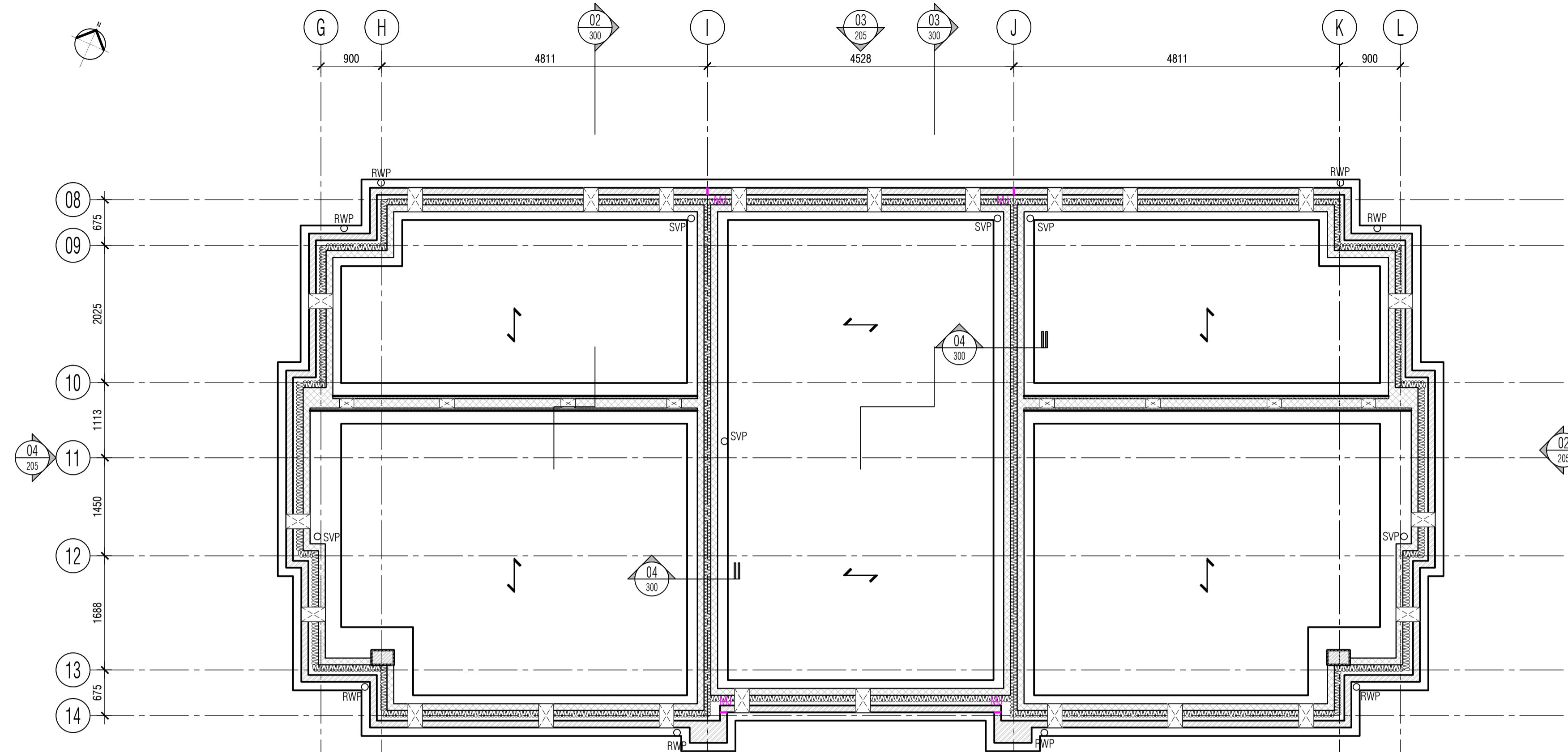

01 Proposed Foundation General Arrangement Plan  
Scale: 1:50

Dimensions to under floor ventilators/periscope ventilators/air bricks are indicative and subject to brick work setting out on site. Brickwork Specialist to use best practice to place ventilators. Care should be taken to read and comply with the specification

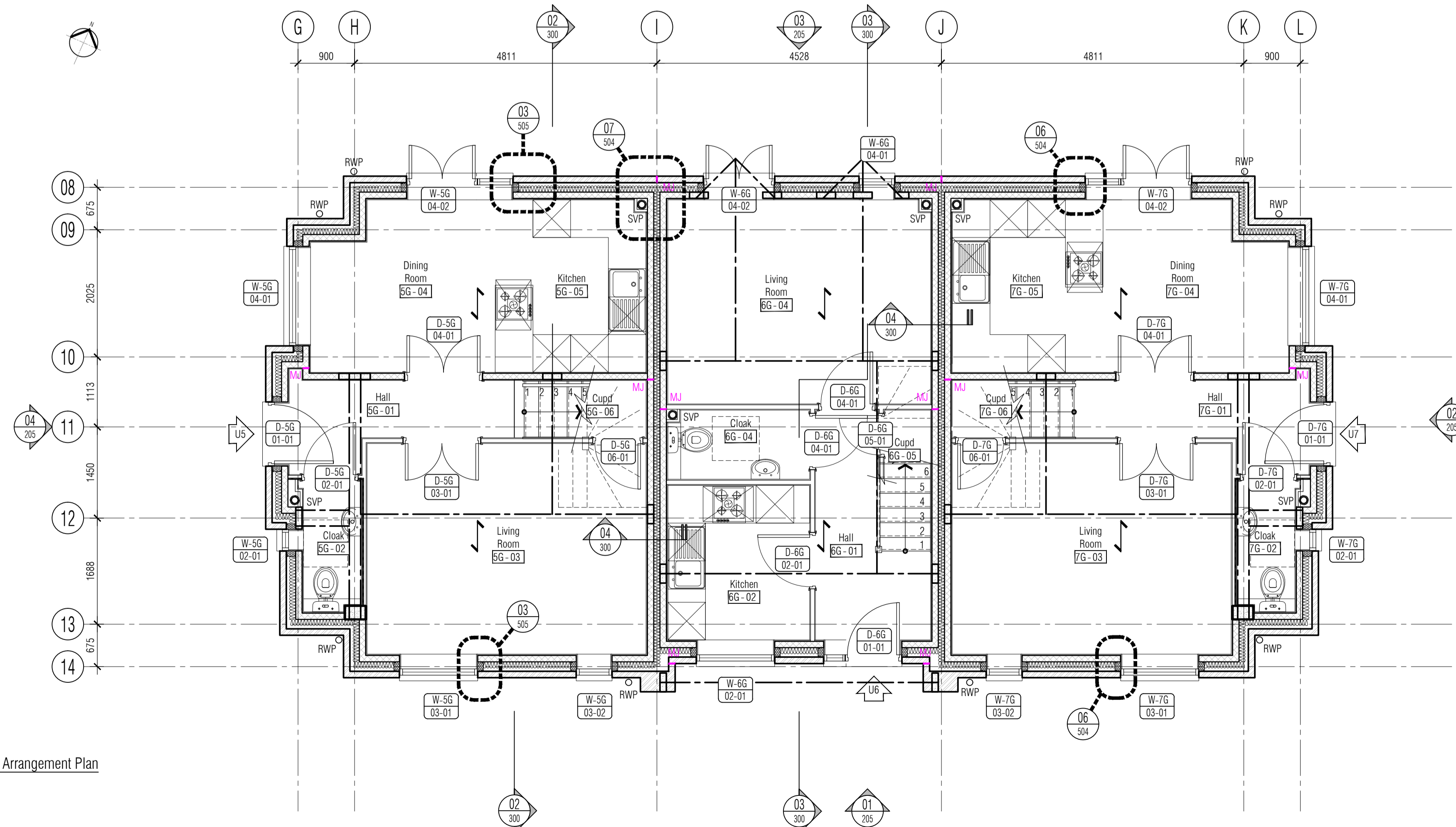

02 Proposed Ground Floor General Arrangement Plan  
Scale: 1:50

Opening Reference Legend

Denotes house type	Denotes floor level
Denotes opening type:	Denotes opening / fenestration / aperture
Door, Window, Screen	- D-16
Denotes room n°	- 05-02

ISSUED FOR CONSTRUCTION

**RDJW**  
ARCHITECTS



RDJW ARCHITECTS LIMITED  
QUIN HOUSE . 9-11 EAST PARK  
CRAWLEY . WEST SUSSEX . RH10 6AN  
TEL: 01293 404300 . FAX: 01293 404299  
E M A I L : info@rdjwarchitects.co.uk  
W E B S I T E : www.rdjwarchitects.co.uk

PROJECT  
Devon House  
Horsham Road  
South Holmwood  
RH5 4NG  
**Luminar**  
DEVELOPMENTS

Proposed Units 5 - 7  
Foundation and Ground Floor  
General Arrangement Plans

DATE	18.03.16	SCALE	1:50 @ A1
DRAWN	RKC	DRG. NO.	4834-125
CHECKED		REV.	C1