

For continuation, please refer to dwg: 521185-A-113

These drawings have been edited in accordance with Willmott Dixon's instructions. All material, product, volume, dimension and performance information is indicative only. FCG repudiates any and all liability for failure or non performance of any of the above mentioned items as indicated on this or any other FCG documentation.

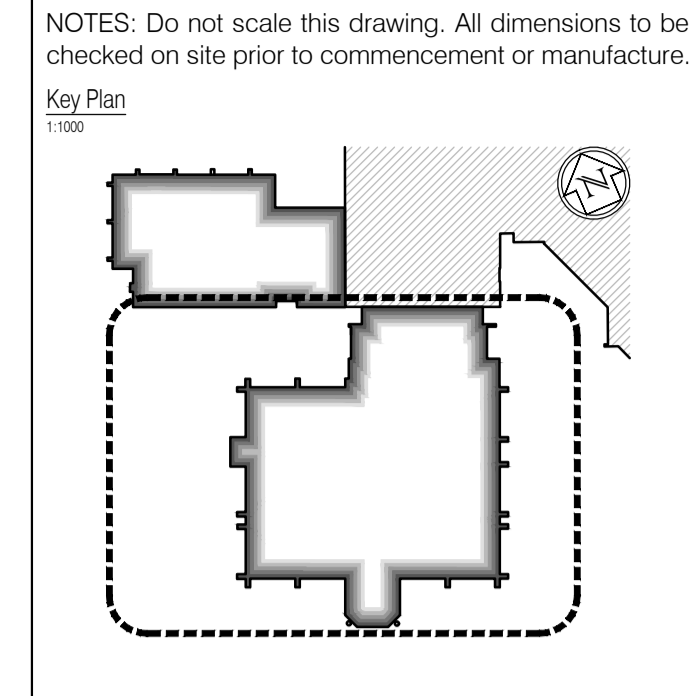
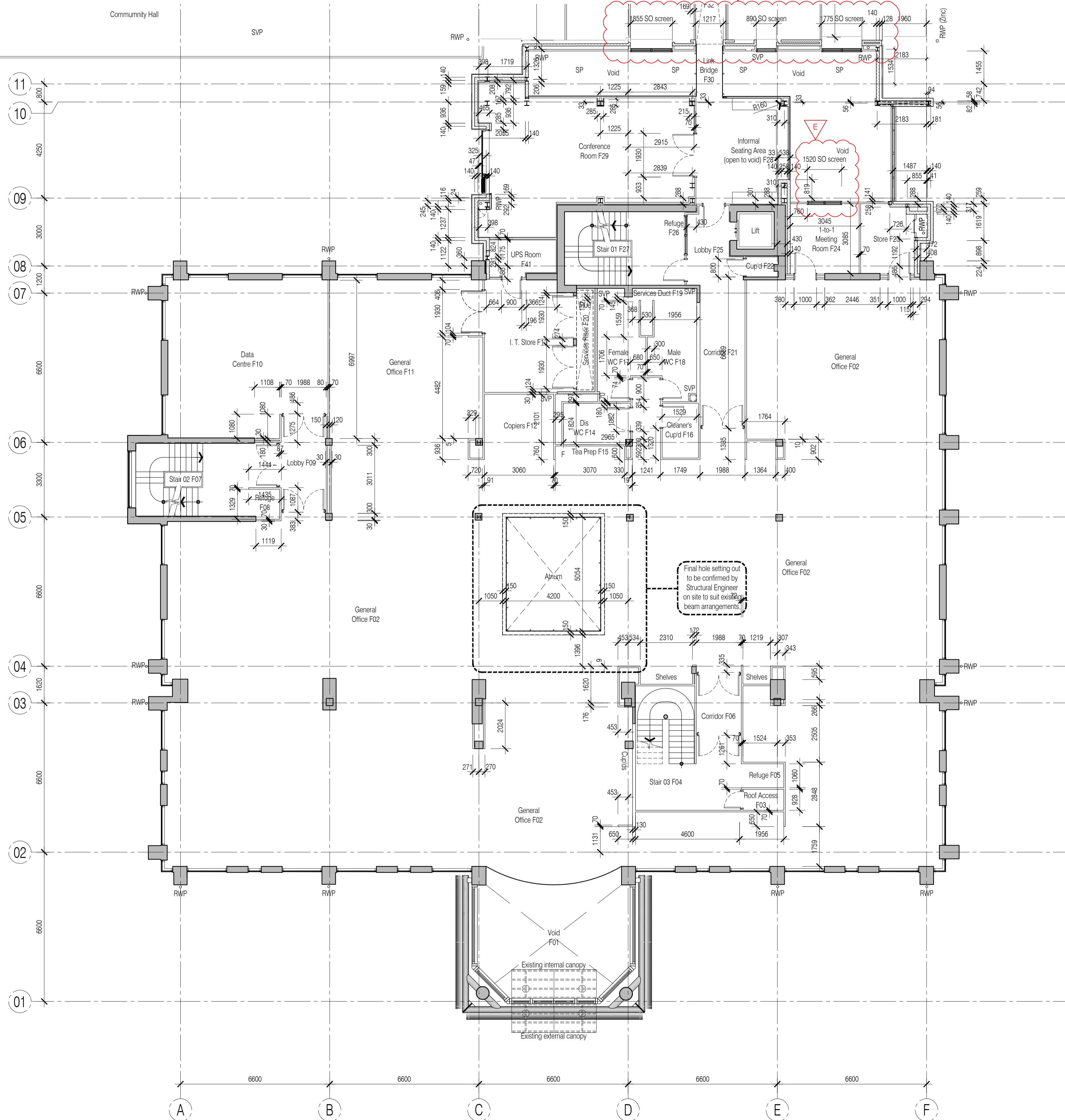

NOTES: Do not scale this drawing. All dimensions to be checked on site prior to commencement or manufacture.

Key Plan
1:1000

ISSUED FOR CONSTRUCTION

NB: - Solid gray hatch denotes existing building fabric.

Rev	Date	By	Chk	Comment
E	23.03.12	JAS	AC	Internal screen details / set-out finalised
D	22.12.11	JAS	AC	Minor setting-out amendments, as clouded
C	25.11.11	RKC	JAS	Gen revs
B	21.10.11	RKC	JAS	Meeting Room Suite revd
A	16.09.11	RKC	JAS	Status change - Issued for CONSTRUCTION

BRINGING IDEAS TO LIFE

FRANKHAM

Frankham Consultancy Group Limited
21 Perrywood Road
Haywards Heath RH16 3TP
t 01444 444900 f 01444 455642
enquiries@frankham.com
www.frankham.com

Client

WILLMOTT DIXON CONSTRUCTION

Project Title

Wealden District Council
Hailsham Head Quarters
Refurbishments and Alterations

Drawing Title

Proposed First Floor Plan
Council Offices Building
Setting Out Plan

Drawn by: RKC	Scale: 1:100@A1	Date: 22.11.10
Designed by: FCG	Checked by: JAS	Approved by: AC

File Ref.: X:\FRANKHAM\02012\16\WEALDEN\04\ARCH\10_16_LOCATION_PLAN_R02.DWG 521185-A-112 (REV) - 20081108201	20.06.11:16.02.42
Drawing No. 521185-A-112	Rev. E

NB: All information based on supplied third party survey information. All discrepancies to be reported to FCG immediately upon discovery.

All Mechanical & Electrical and Structural information shown indicative only. Please refer to Mechanical & Electrical and Structural documentation.