

NOTES: Do not scale this drawing. All dimensions to be checked on site prior to commencement or manufacture.

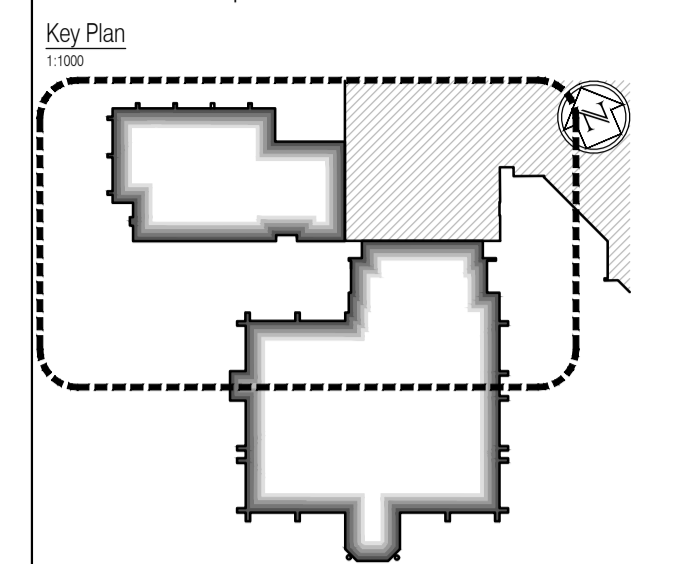

ISSUED FOR CONSTRUCTION

NB: - Solid gray hatch denotes existing building fabric.

Rev	Date	By	Chk	Comment
D	28.11.11	RKC	JAS	Sumpipes set out added.
C	21.10.11	RKC	JAS	Room created. Sumpipes, Layout revd.
B	05.10.11	RKC	JAS	Setting out added.
A	16.09.11	RKC	JAS	Status change - Issued for CONSTRUCTION

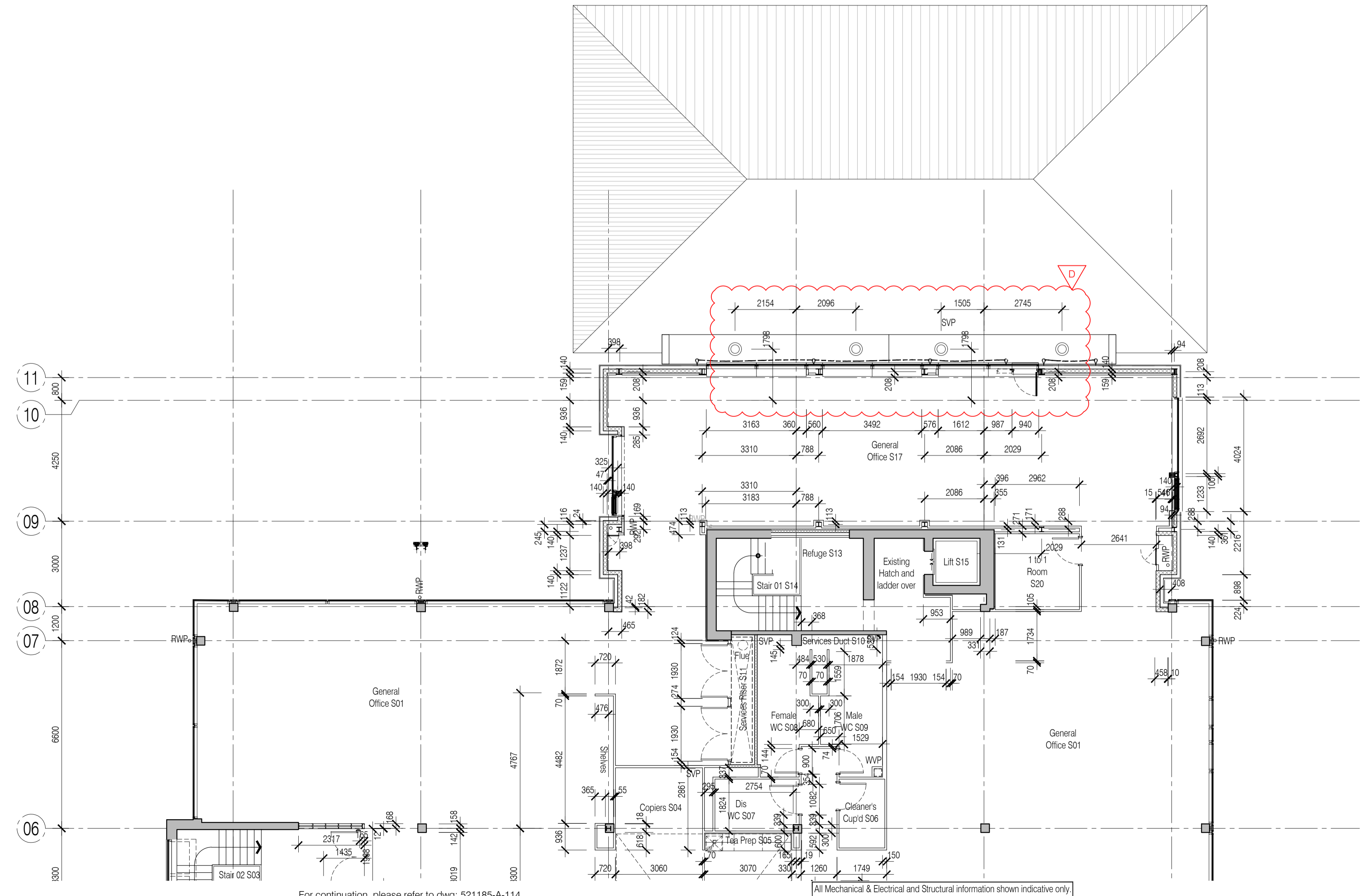

For continuation, please refer to dwg: 521185-A-114

All Mechanical & Electrical and Structural information shown indicative only. Please refer to Mechanical & Electrical and Structural documentation.

BRINGING IDEAS TO LIFE

FRANKHAM

Frankham Consultancy Group Limited
21 Pymons Road
Haywards Heath RH16 3TP
t 01444 444900 f 01444 455642
enquire@frankham.com
www.frankham.com

Client

WILMOTT DIXON CONSTRUCTION

Project Title

Wealden District Council
Hailsham Head Quarters
Refurbishments and Alterations

Drawing Title

Proposed Second Floor Plan
Community Hall Building and Link Block
Setting Out Plan

Drawn by: RKC	Scale: 1:100@A1	Date: 22.11.10
Designed by: FCG	Checked by: JAS	Approved by: AC

File Ref.: 521185-A-115

Drawing No. 521185-A-115	Rev. D
------------------------------------	------------------