

NOTES: Do not scale this drawing. All dimensions to be checked on site prior to commencement or manufacture.

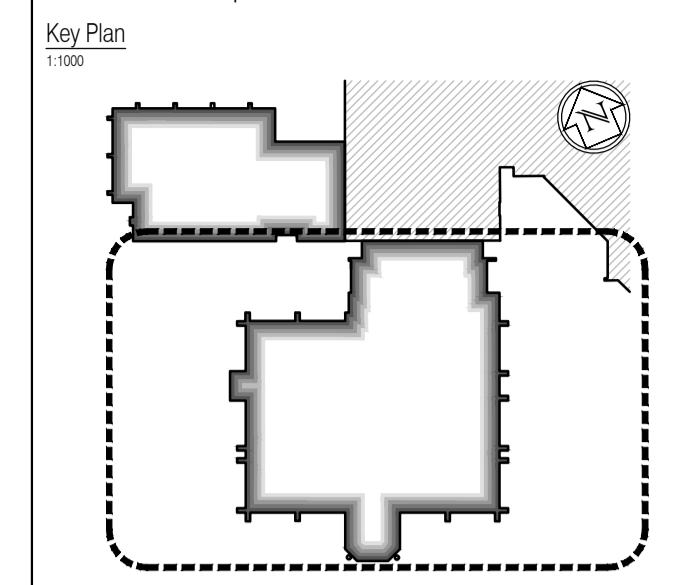

- Fixed Furniture & Equipment Legend**
- FH Denotes Tambou unit 4N' shelves - 470mm deep x 1000mm wide x 1968mm high (Department Storage)
 - LL Denotes Tambou unit 2N' shelves - 470mm deep x 1000mm wide x 1016mm high (Department Storage)
 - BCL Denotes Book case 3N' shelves - 434mm deep x 1000mm wide x 1155mm high (Department Storage)
 - BCH Denotes Book case 5N' shelves - 434mm deep x 1000mm wide x 1887mm high (Department Storage)
 - L Denotes Staff locker - 457mm deep x 305mm wide x 1703mm high
 - FHC Denotes full height cupboards TBC(Department Storage)
 - S Denotes Chubb Europlanet 150 safe - 756mm deep x 536mm wide x 326mm high
 - LLPS Denotes Tambou unit 2N' shelves - 470mm deep x 1000mm wide x 1016mm high (Personal Storage)
 - FHPS/DS Denotes Tambou unit 4N' shelves - 475mm deep x 1000mm wide x 1968mm high (Shared Department/Personal Storage)
 - FC Filing Cabinet
 - PC Plan Chest
 - F Fridge
 - FF Lockable Fridge Freezer
 - FL Lockable Fridge Freezer
 - LC Lockable Cupboard
 - LLDS Denotes Tambou unit 2N' shelves - 470mm deep x 1000mm wide x 1016mm high (Personal Storage)
 - FHLS Denotes Tambou unit 4N' shelves - 470mm deep x 1000mm wide x 1968mm high (Legal Library Storage)

AS BUILT DRAWING

NB: - Solid gray hatch denotes existing building fabric.

Rev	Date	By	Chk	Comment

BRINGING IDEAS TO LIFE

FRANKHAM

Frankham Consultancy Group Limited
 21 Perryman Road
 Heywards Heath RH16 3TP
 t 01444 444900 f 01444 455642
 enquiry@frankham.com
 www.frankham.com

Client

WILLMOTT DIXON CONSTRUCTION

Project Title

Wealden District Council
 Hailsham Head Quarters
 Refurbishments and Alterations

Drawing Title

Proposed Ground Floor Plan
 Council Offices Building
 Fixed Furniture & Equipment Arrangement

Drawn by: RKC	Scale: 1:100@A1	Date: 22.11.10
Designed by: FCG	Checked by: JAS	Approved by: AC

File Ref.:	X:\FRANKHAM\CG\2010\16\WEALDEN\DO\ARCH\10_16_LOCATION_PLAN_RFC_GA_021814-03.DWG - 20081109.DWG	20.06.11.16.03.48
Drawing No.	521185-A-120	Rev. -

NB: All information based on supplied third party survey information. All discrepancies to be reported to FCG immediately upon discovery.

All Mechanical & Electrical and Structural information shown indicative only. Please refer to Mechanical & Electrical and Structural documentation.