

NOTES: Do not scale this drawing. All dimensions to be checked on site prior to commencement or manufacture.

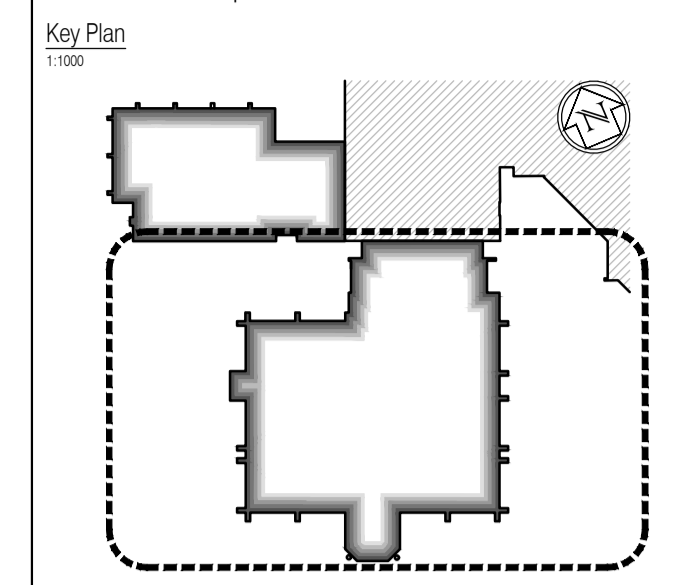

- Fixed Furniture & Equipment Legend**
- FH Denotes Tambou unit 4N' shelves - 470mm deep x 1000mm wide x 1968mm high (Department Storage)
 - LL Denotes Tambou unit 2N' shelves - 470mm deep x 1000mm wide x 1016mm high (Department Storage)
 - BCL Denotes Book case 3N' shelves - 434mm deep x 1000mm wide x 1155mm high (Department Storage)
 - BCH Denotes Book case 5N' shelves - 434mm deep x 1000mm wide x 1887mm high (Department Storage)
 - L Denotes Staff locker - 457mm deep x 305mm wide x 1703mm high
 - FHC Denotes full height cupboards TBC(Dept/Personal Storage)
 - S Denotes Chubb Europlanet 150 safe - 756mm deep x 536mm wide x 526mm high
 - LLPS Denotes Tambou unit 2N' shelves - 470mm deep x 1000mm wide x 1016mm high (Personal Storage)
 - FHPS/DS Denotes Tambou unit 4N' shelves - 475mm deep x 1000mm wide x 1968mm high (Shared Dept/Personal Storage)
 - FC Filing Cabinet
 - PC Plan Chest
 - F Fridge
 - FF Lockable Fridge Freezer
 - FL Lockable Fridge Freezer
 - LC Lockable Cupboard
 - LLDS Denotes Tambou unit 2N' shelves - 470mm deep x 1000mm wide x 1016mm high (Personal Storage)
 - FHLS Denotes Tambou unit 4N' shelves - 470mm deep x 1000mm wide x 1968mm high (Legal Library Storage)

AS BUILT DRAWING

NB: - Solid gray hatch denotes existing building fabric.

Rev	Date	By	Chk	Comment

BRINGING IDEAS TO LIFE



FRANKHAM

Frankham Consultancy Group Limited
 21 Perryman Road
 Hayward Heath RH16 3TP
 t 01444 444900 f 01444 455642
 enquiry@frankham.com
 www.frankham.com

Client



WILLMOTT DIXON CONSTRUCTION

Project Title

Wealden District Council
 Hailsham Head Quarters
 Refurbishments and Alterations

Drawing Title

Proposed Second Floor Plan
 Council Offices Building
 Fixed Furniture & Equipment Arrangement

Drawn by: RKC	Scale: 1:100@A1	Date: 22.11.10
Designed by: FCG	Checked by: JAS	Approved by: AC

File Ref.: X:\FRANKHAM\CG02\16\WEALDEN\DOARCH\16_16_LOCATION_PLAN_162.DWG 20/06/11 16:04:38

Drawing No. 521185-A-124	Rev. -
-----------------------------	-----------

NB: All information based on supplied third party survey information. All discrepancies to be reported to FCG immediately upon discovery.

All Mechanical & Electrical and Structural information shown indicative only. Please refer to Mechanical & Electrical and Structural documentation.