

NOTES: Do not scale this drawing. All dimensions to be checked on site prior to commencement or manufacture.

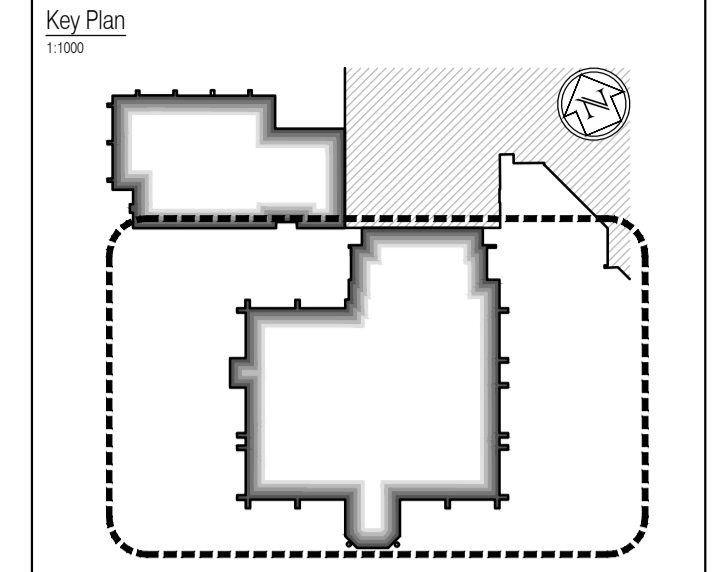

- Reflected Ceiling Plan Legend**
All colours to be confirmed.
All unhatched areas are exposed concrete soffits to be made good and painted.
- Plasterboard bulkhead with downlights
 - Suspended Armstrong Diploma E24 suspended 600x600 grid - meeting rooms + general areas
 - Suspended Armstrong BioGuard Acoustic E24 suspended 600x600 grid - hygienic areas
 - Plasterboard ceiling
 - Rockfon Alaska D Acoustic Suspended 600 x 600 grid - High sound absorption
 - Existing ceiling made good and painted white
 - Underside of concrete slab made good and painted white
 - Phase change plasterboard bulkhead
 - Exposed waffle slab made good and painted. Colour TBC.
 - Exposed beam and pot floor made good and painted. Colour TBC.
 - Exposed pre-cast slab made good and painted. Colour TBC.
 - Phased change F.E.S. board ceiling material (for thermal mass)
 - 1hr Fire Ceiling: 2m² layers of 12.5mm Fireline plasterboard in accordance with Manufacturer's design and instructions

AS BUILT DRAWING

NB: - Solid gray hatch denotes existing building fabric.

| Rev | Date | By | Clk | Comment |
|-----|------|----|-----|---------|
| | | | | |
| | | | | |
| | | | | |
| | | | | |

BRINGING IDEAS TO LIFE

FRANKHAM

Frankham Consultancy Group Limited
21 Perryman Road
Haywards Heath RH16 3TP
t 01444 444900 f 01444 455642
enquiries@frankham.com
www.frankham.com

Client

WILLMOTT DIXON CONSTRUCTION

Project Title

Wealden District Council
Hailsham Head Quarters
Refurbishments and Alterations

Drawing Title

Proposed First Floor Plan
Council Offices Building
Reflected Ceiling Plan

| | | |
|---------------------|--------------------|--------------------|
| Drawn by: RKC | Scale: 1:100@A1 | Date: 22.11.10 |
| Designed by: FCG | Checked by: JAS | Approved by: AC |

| | |
|--|----------------------------|
| File Ref.: X:\FRANKHAM\021185\HEADQUARTERS\100_LOCATION_PLAN_RCP.dwg 521185-A-142 DWG - 2008110904 | Date: 20.06.11:16:06:05 |
| Drawing No. 521185-A-142 | Rev. - |

NB: All information based on supplied third party survey information. All discrepancies to be reported to FCG immediately upon discovery.

All Mechanical & Electrical and Structural information shown indicative only. Please refer to Mechanical & Electrical and Structural documentation.