

NOTES: Do not scale this drawing. All dimensions to be checked on site prior to commencement or manufacture.

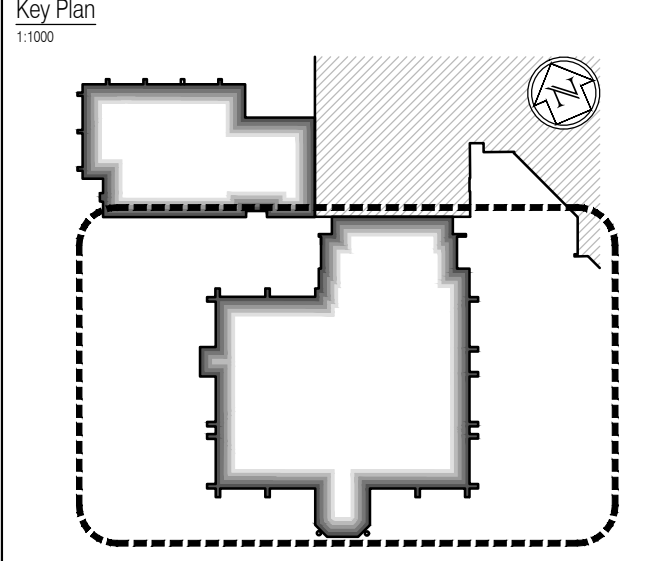

- Reflected Ceiling Plan Legend**
- All colours to be confirmed.  
All unhatched areas are exposed concrete soffits to be made good and painted.
- Plasterboard bulkhead with downlights
  - Suspended Armstrong Diploma E24 suspended 600x600 grid - meeting rooms + general areas
  - Suspended Armstrong BioGuard Acoustic E24 suspended 600x600 grid - hygienic areas
  - Plasterboard ceiling
  - Rockfon Alaska D Acoustic Suspended 600 x 600 grid - High sound absorption
  - Existing ceiling made good and painted white
  - Underside of concrete slab made good and painted white
  - Phase change plasterboard bulkhead
  - Exposed waffle slab made good and painted. Colour TBC.
  - Exposed beam and pot floor made good and painted. Colour TBC.
  - Exposed pre-cast slab made good and painted. Colour TBC.
  - Phased change F.E.S. board ceiling material (for thermal mass)
  - 1hr Fire Ceiling: 2hr layers of 12.5mm Fireline plasterboard in accordance with Manufacturer's design and instructions

# AS BUILT DRAWING

NB: - Solid gray hatch denotes existing building fabric.

Rev	Date	By	Chk	Comment

**BRINGING IDEAS TO LIFE**

**FRANKHAM**

Frankham Consultancy Group Limited  
21 Parnham Road  
Haywards Heath RH16 3TP  
t 01444 444900 f 01444 455642  
enquiries@frankham.com  
www.frankham.com

Client: **WILLMOTT DIXON CONSTRUCTION**

Project Title: Wealden District Council Hailsham Head Quarters Refurbishments and Alterations

Drawing Title: Proposed Second Floor Plan Council Offices Building Reflected Ceiling Plan

Drawn by: RKC	Scale: 1:100@A1	Date: 22.11.10
Designed by: FCG	Checked by: JAS	Approved by: AC

File Ref.: X:\FRANKHAM\CG\21185\HEADQUARTERS\106_LOCATION_PLAN_RFC.dwg	20/06/11 16:06:25
Drawing No. 521185-A-144	Rev. -

NB: All information based on supplied third party survey information. All discrepancies to be reported to FCG immediately upon discovery.

All Mechanical & Electrical and Structural information shown indicative only. Please refer to Mechanical & Electrical and Structural documentation.