

NOTES: Do not scale this drawing. All dimensions to be checked on site prior to commencement or manufacture.

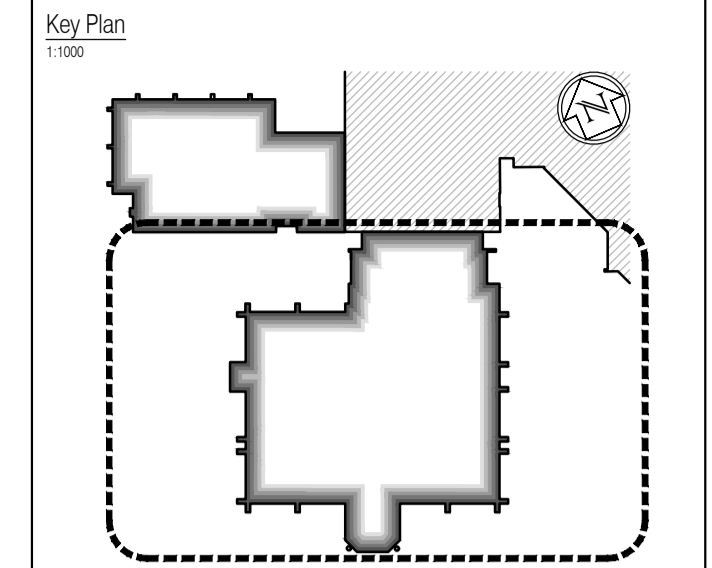

- Reflected Ceiling Plan Legend**  
 All colours to be confirmed.  
 All unhatched areas are exposed concrete soffits to be made good and painted.
- Plasterboard bulkhead with downlights
  - Suspended Armstrong Diploma E24 suspended 600x600 grid - meeting rooms + general areas
  - Suspended Armstrong BioGuard Acoustic E24 suspended 600x600 grid - hygienic areas
  - Plasterboard ceiling
  - Rockfon Alaska D Acoustic Suspended 600 x 600 grid - High sound absorption
  - Existing ceiling made good and painted white
  - Underside of concrete slab made good and painted white
  - Phase change plasterboard bulkhead
  - Exposed waffle slab made good and painted. Colour TBC.
  - Exposed beam and pot floor made good and painted. Colour TBC.
  - Exposed pre-cast slab made good and painted. Colour TBC.
  - Phased change F.E.S. board ceiling material (for thermal mass)
  - 1hr Fire Ceiling: 2x layers of 12.5mm Fireline plasterboard in accordance with Manufacturer's design and instructions

**AS BUILT DRAWING**

NB: - Solid gray hatch denotes existing building fabric.

Rev	Date	By	Chk	Comment

BRINGING IDEAS TO LIFE

**FRANKHAM**

Frankham Consultancy Group Limited  
 21 Perrymount Road  
 Hayward Heath RH16 3TP  
 t 01444 444900 f 01444 455642  
 enquiry@frankham.com  
 www.frankham.com

Client

**WILLMOTT DIXON CONSTRUCTION**

Project Title

Wealden District Council  
 Hailsham Head Quarters  
 Refurbishments and Alterations

Drawing Title

Proposed Third Floor Plan  
 Council Offices Building  
 Reflected Ceiling Plan

Drawn by: RKC	Scale: 1:100@A1	Date: 22.11.10
Designed by: FCG	Checked by: JAS	Approved by: AC

File Ref.: X:\FRANKHAM\CG\21185\HEADQUARTERS\100\_LOCATION\_PLAN\_RCD.dwg  
 20/06/11 16:06:28

Drawing No. <b>521185-A-145</b>	Rev. -
------------------------------------	-----------

NB: All information based on supplied third party survey information. All discrepancies to be reported to FCG immediately upon discovery.

All Mechanical & Electrical and Structural information shown indicative only. Please refer to Mechanical & Electrical and Structural documentation.