

NOTES: Do not scale this drawing. All dimensions to be checked on site prior to commencement or manufacture.

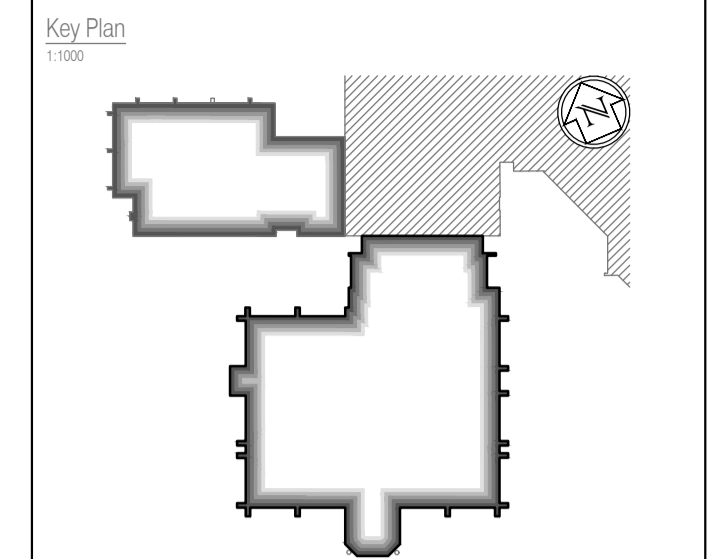

- Partition Strategy Key**
- WA WA WA WA 70mm C-Stud & 2 layers 15mm soundbloc - no quilt
 - WB WB WB WB 70mm C-Stud & 2 layers 15mm soundbloc - 25mm 1200 quilt
 - WC WC WC WC 70mm C-Stud & 2 layers 15mm soundbloc - 50mm 1200 quilt
 - WD WD WD WD IPS Partitions to WCs
 - WE WE WE WE Masonry substrates - generally to have 13mm wet plaster finish
 - WF WF WF WF New glazed elements
 - WG WG WG WG IWL 92/90 Uni-insulated
 - WH WH WH WH 2 layers 15mm soundbloc on Gyproc Gypframe MF10 metal channels secured on adhesive dabs with 6mm parge coat to existing masonry wall
 - WI WI WI WI Glazed balustrade system with vertical posts carrying stainless steel handrail
 - WJ WJ WJ WJ Column encasements

Note
All existing external walls dry-lined using thermal board.
All existing fair-faced internal blockwork partition walls to be dry-lined.

Refer also to the following FCG drawings:
For GA Plans, refer to drawings A-100-Series.
For GA Sections, refer to drawings A-200-Series.
For GA Elevations, refer to drawings A-300-Series.
For Acoustic Strategy, refer to drawings A-150-Series.
For Internal Fire Strategy, refer to drawings A-160-Series.
For Builders Work, refer to drawings A-180-Series.
Refer also to detailed drawings generally - A-400-Series + NBS.

AS BUILT DRAWING

NB: - Solid gray hatch denotes existing building fabric.

| Rev | Date | By | Ck | Comment |
|-----|------|----|----|---------|
| | | | | |
| | | | | |

BRINGING IDEAS TO LIFE

FRANKHAM

Frankham Consultancy Group Limited
21 Perrywood Road
Haywards Heath RH16 3TP
t 01444 444900 f 01444 455642
enquire@frankham.com
www.frankham.com

Client

WILLMOTT DIXON CONSTRUCTION

Project Title

Wealden District Council
Hailsham Head Quarters
Refurbishments and Alterations

Drawing Title

Proposed Ground Floor Plan
Council Offices Building
Partition Strategy Plan

| | | |
|---------------------|--------------------|--------------------|
| Drawn by: RKC | Scale: 1:125@A1 | Date: 18.2.11 |
| Designed by: FCG | Checked by: JAS | Approved by: AC |

| | |
|---|-------------------|
| File Ref.: X:\FRANKHAM\CG02\18\WEALDEN\DOVARCH\02_186_LOCATION_PLAN_RFC.DWG 3/1/10 4:15:29 - 3/31/10 10:27 | 20.06.11:16:07:27 |
| Drawing No. 521185-A-170 | Rev. - |

NB: All information based on supplied third party survey information. All discrepancies to be reported to FCG immediately upon discovery.