

NOTES: Do not scale this drawing. All dimensions to be checked on site prior to commencement or manufacture.

Key Plan
1:1000

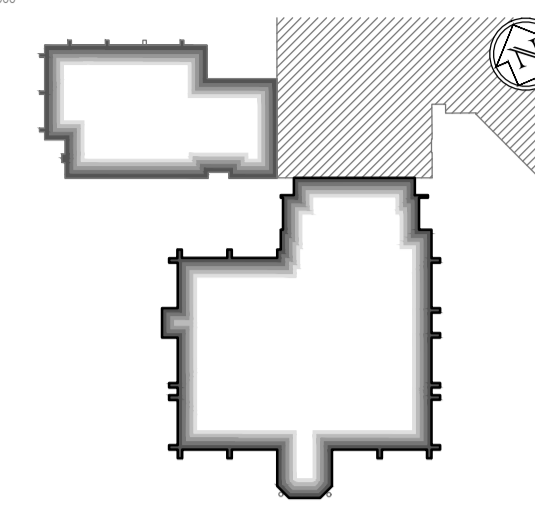

- Partition Strategy Key**
- WA 70mm C-Stud & 2 layers 15mm soundbloc - no quilt
 - WB 70mm C-Stud & 2 layers 15mm soundbloc - 25mm 1200 quilt
 - WC 70mm C-Stud & 2 layers 15mm soundbloc - 50mm 1200 quilt
 - WD IPS Partitions to WCs
 - WE Masonry substrates - generally to have 13mm wet plaster finish
 - WF New glazed elements
 - WG IWL 92/90 Uni-insulated
 - WH 2 layers 15mm soundbloc on Gyproc Gypframe MF10 metal channels secured on adhesive dabs with 6mm parge coat to existing masonry wall
 - WI Glazed balustrade system with vertical posts carrying stainless steel handrail
 - WJ Column encasements

Note
All existing external walls dry-lined using thermal board.
All existing fair-faced internal blockwork partition walls to be dry-lined.

Refer also to the following FCG drawings:
For GA Plans, refer to drawings 'A-100-Series'.
For GA Sections, refer to drawings 'A-200-Series'.
For GA Elevations, refer to drawings 'A-300-Series'.
For Acoustic Strategy, refer to drawings 'A-150-Series'.
For Internal Fire Strategy, refer to drawings 'A-160-Series'.
For Builders Work, refer to drawings 'A-180-Series'.
Refer also to detailed drawings generally - 'A-400-Series' + NBS.

AS BUILT DRAWING

NB: - Solid gray hatch denotes existing building fabric.

Rev	Date	By	Chk	Comment

BRINGING IDEAS TO LIFE



FRANKHAM

Frankham Consultancy Group Limited
21 Perryman Road
Haywards Heath RH16 3TP
t 01444 444900 f 01444 455642
enquire@frankham.com
www.frankham.com

Client



WILLMOTT DIXON CONSTRUCTION

Project Title

Wealden District Council
Hailsham Head Quarters
Refurbishments and Alterations

Drawing Title

Proposed First Floor Plan
Council Offices Building
Partition Strategy Plan

Drawn by: RKC	Scale: 1:125@A1	Date: 18.02.11
Designed by: FCG	Checked by: JAS	Approved by: AC

File Ref.: X:\FRANKHAM\021185\HAILSHAM HEADQUARTERS\186_LOCATION PLAN.RVT 20.06.11:16:07:47

Drawing No. 521185-A-171	Rev. -
------------------------------------	-----------

