

NOTES: Do not scale this drawing. All dimensions to be checked on site prior to commencement or manufacture.

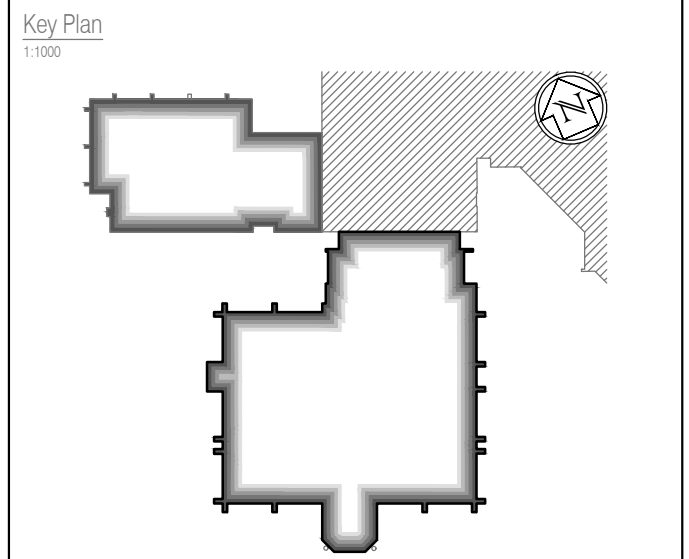

- Partition Strategy Key**
- WA WA WA WA 70mm C-Stud & 2 layers 15mm soundbloc - no quilt
 - WB WB WB WB 70mm C-Stud & 2 layers 15mm soundbloc - 25mm 1200 quilt
 - WC WC WC WC 70mm C-Stud & 2 layers 15mm soundbloc - 50mm 1200 quilt
 - WD WD WD WD IPS Partitions to WCs
 - WE WE WE WE Masonry substrates - generally to have 13mm wet plaster finish
 - WG WG WG WG New glazed elements
 - WH WH WH WH IWL 9290 Un-insulated
 - WI WI WI WI 2 layers 15mm soundbloc on Gyproc Gyplframe MF10 metal channels secured on adhesive dabs with 6mm parge coat to existing masonry wall
 - WJ WJ WJ WJ Glazed balustrade system with vertical posts carrying stainless steel handrail
 - WK WK WK WK Column encasements

Note
 All existing external walls dry-lined using thermal board.
 All existing fair-faced internal blockwork partition walls to be dry-lined.

Refer also to the following FCG drawings:
 For 'GA Plans', refer to drawings 'A-100-Series'.
 For 'GA Sections', refer to drawings 'A-200-Series'.
 For 'GA Elevations', refer to drawings 'A-300-Series'.
 For 'Acoustic Strategy', refer to drawings 'A-150-Series'.
 For 'Internal Fire Strategy', refer to drawings 'A-160-Series'.
 For 'Builders Work', refer to drawings 'A-180-Series'.
 Refer also to detailed drawings generally - 'A-400-Series + NBS'.

AS BUILT DRAWING

NB: - Solid gray hatch denotes existing building fabric.

Rev	Date	By	Chk	Comment

BRINGING IDEAS TO LIFE



FRANKHAM

Frankham Consultancy Group Limited
 21 Perryman Road
 Heywards Heath, RH11 6 3TP
 t 01444 444900 f 01444 455642
 enquiry@frankham.com
 www.frankham.com

Client



WILLMOTT DIXON CONSTRUCTION

Project Title

Wealden District Council
 Hailsham Head Quarters
 Refurbishments and Alterations

Drawing Title

Proposed Third Floor Plan
 Council Offices Building
 Partition Strategy Plan

Drawn by: RKC	Scale: 1:125@A1	Date: 24.02.11
Designed by: FCG	Checked by: JAS	Approved by: AC

File Ref.: X:\FRANKHAM\021185\WEALDEN\DOORCH\02_186_LOCATION_PLAN_RUC.DWG
 20/06/11 16:07:57

Drawing No. 521185-A-173	Rev. -
------------------------------------	-----------

NB: All information based on supplied third party survey information. All discrepancies to be reported to FCG immediately upon discovery.