

NOTES: Do not scale this drawing. All dimensions to be checked on site prior to commencement or manufacture.

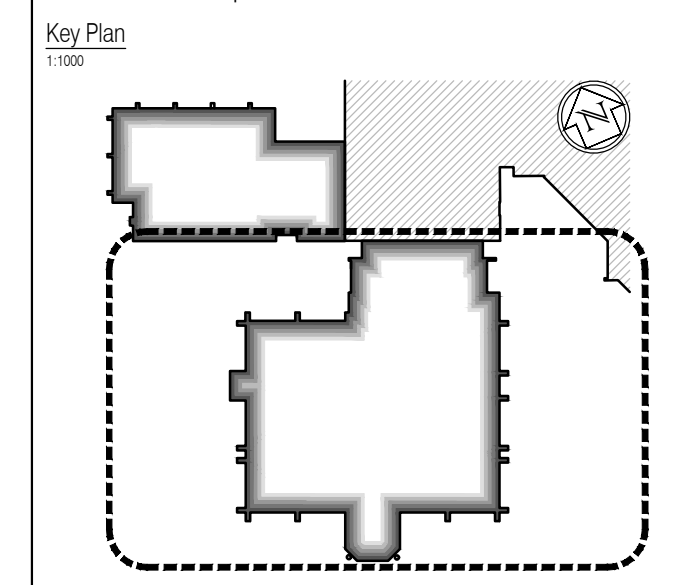

- General Builders Works Notes**
- All square ductwork ventilation holes to be sized and set-out in strict accordance with the Structural Engineers drawings - those shown on this drawing relate to those holes over-head.
 - All holes set-out on this drawing for drainage are dimensioned to the centre of the holes - all hole diameters to be as confirmed by the Mechanical Engineers drawings, and to the satisfaction of the Structural Engineer.
 - Dashed lines indicate pipe-routes tracking from hole / outlet positions at floor above. For final 'exact' routing requirements, refer to Mechanical and Electrical Engineers design drawings.
 - All concrete / steelwork shown indicative sizes / locations only, and to be confirmed by Structural Engineer.
 - All structural information generally to be in accordance with Structural Engineer's design, details and specification.
 - Plant layouts shown here are taken directly from the Mechanical and Electrical Engineers, or Specialist Sub-contractors design drawings; and are therefore included for reference only.
 - All mechanical, electrical, plumbing and ventilation information to be in accordance with Mechanical and Electrical Engineer's design, details and specification.
 - For references to soil + vent pipes / rain water pipes / stub-stacks / gullies / drainage channels / etc; refer to the Mechanical and Electrical Engineer's design drawings.
 - All screed butting existing masonry walls which have been removed, to be made good and level to match existing.

- Denotes MDF raised access floor
- Denotes Metal raised access floor

ISSUED FOR CONSTRUCTION

NB: - Solid gray hatch denotes existing building fabric.

Rev	Date	By	Crk	Comment
A	16.09.11	RKC	JAS	Status change - Issued for CONSTRUCTION

BRINGING IDEAS TO LIFE

FRANKHAM

Frankham Consultancy Group Limited
 21 Perryman Road
 Haywards Heath RH16 3TP
 t 01444 444900 f 01444 455642
 enquiry@frankham.com
 www.frankham.com

Client: **WILLMOTT DIXON CONSTRUCTION**

Project Title: **Wealden District Council
Hailsham Head Quarters
Refurbishments and Alterations**

Drawing Title: **Proposed Ground Floor Plan
Council Offices Building
Builder's Works Plan**

Drawn by: RKC	Scale: 1:100@A1	Date: 21.12.10
Designed by: FCG	Checked by: JAS	Approved by: AC

File Ref.: X:\FRANKHAM\CG02\16\WEALDEN\CGARCH\16\LOC\GND FLOOR PLAN.RVT 521185-A-181 DWG - 2008110802	20.06.11 16:08:03
Drawing No. 521185-A-180	Rev. A

NB: All information based on supplied third party survey information. All discrepancies to be reported to FCG immediately upon discovery.