

NOTES: Do not scale this drawing. All dimensions to be checked on site prior to commencement or manufacture.

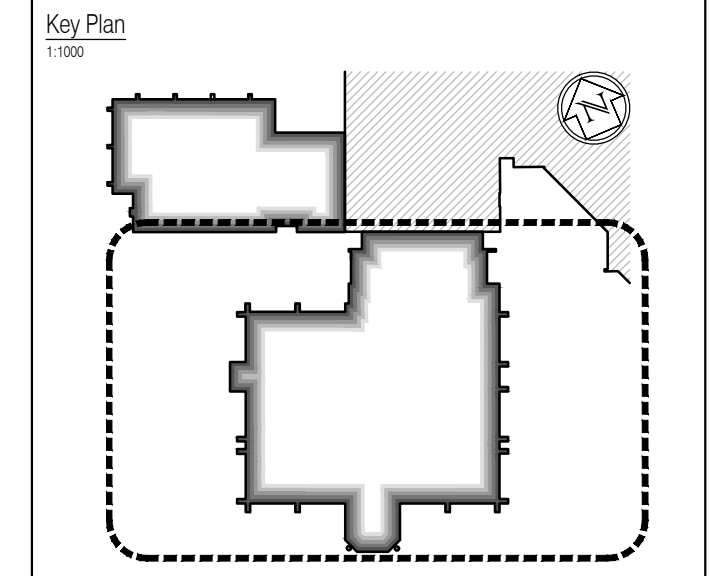

- General Builder's Works Notes**
- All square ductwork ventilation holes to be sized and set-out in strict accordance with the Structural Engineer's drawings - those shown on this drawing relate to those holes over-head.
 - All holes set-out on this drawing for drainage are dimensioned to the centre of the holes - all hole diameters to be as confirmed by the Mechanical Engineer's drawings, and to the satisfaction of the Structural Engineer.
 - Dashed lines indicate pipe-routes tracking from hole / outlet positions at floor above. For final 'exact' routing requirements, refer to Mechanical and Electrical Engineer's design drawings.
 - All concrete / steelwork shown indicative sizes / locations only, and to be confirmed by Structural Engineer.
 - All structural information generally to be in accordance with Structural Engineer's design, details and specification.
 - Plant layouts shown here are taken directly from the Mechanical and Electrical Engineers, or Specialist Sub-contractors design drawings; and are therefore included for reference only.
 - All mechanical, electrical, plumbing and ventilation information to be in accordance with Mechanical and Electrical Engineer's design, details and specification.
 - For references to soil + vent pipes / rain water pipes / stub-stacks / gulleys / drainage channels / etc; refer to the Mechanical and Electrical Engineer's design drawings.
 - All screed butting existing masonry walls which have been removed, to be made good and level to match existing.

- Denotes MDF raised access floor
- Denotes Metal raised access floor

ISSUED FOR CONSTRUCTION

NB: - Solid gray hatch denotes existing building fabric.

Rev	Date	By	Chk	Comment
A	16.09.11	RKC	JAS	Status change - Issued for CONSTRUCTION

BRINGING IDEAS TO LIFE

FRANKHAM

Frankham Consultancy Group Limited
 21 Perryman Road
 Hayward Heath RH16 3TP
 t 01444 444900 f 01444 455642
 enquiry@frankham.com
 www.frankham.com

Client:

Project Title: Wealden District Council
 Hailsham Head Quarters
 Refurbishments and Alterations

Drawing Title: Proposed First Floor Plan
 Council Offices Building
 Builder's Works Plan

Drawn by: RKC	Scale: 1:100@A1	Date: 21.12.10
Designed by: FCG	Checked by: JAS	Approved by: AC
File Ref.: X:\FRANKHAM\CG02\16\WEALDEN\COACH\16_LOCATION_PLAN_RKD.dwg 521185-A-182 DWG - 20081108014		20.06.11 16:08:14
Drawing No. 521185-A-182	Rev. A	

NB: All information based on supplied third party survey information. All discrepancies to be reported to FCG immediately upon discovery.

