

NOTES: Do not scale this drawing. All dimensions to be checked on site prior to commencement or manufacture.

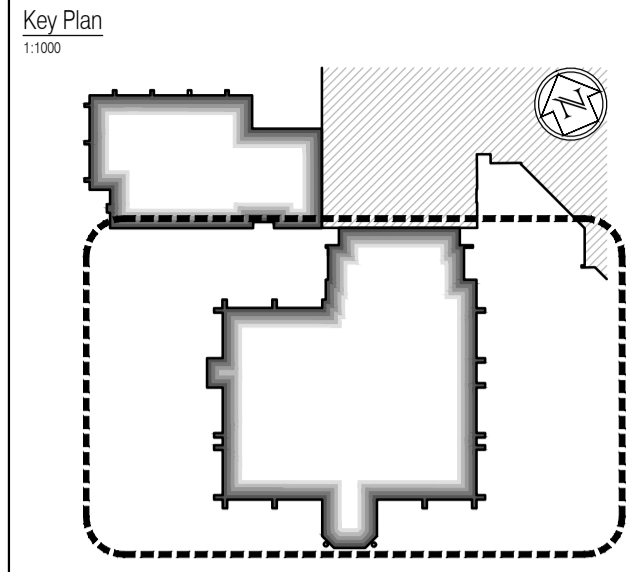

- General Builders Works Notes
- All square ductwork ventilation holes to be sized and set-out in strict accordance with the Structural Engineers drawings - those shown on this drawing relate to those holes over-head.
 - All holes set-out on this drawing for drainage are dimensioned to the centre of the holes - all hole diameters to be as confirmed by the Mechanical Engineers drawings, and to the satisfaction of the Structural Engineer.
 - Dashed lines indicate pipe-routes tracking from hole / outlet positions at floor above. For final 'exact' routing requirements, refer to Mechanical and Electrical Engineer's design drawings.
 - All concrete / steelwork shown indicative sizes / locations only, and to be confirmed by Structural Engineer.
 - All structural information generally to be in accordance with Structural Engineer's design, details and specification.
 - Plant layouts shown here are taken directly from the Mechanical and Electrical Engineers, or Specialist Sub-contractors design drawings, and are therefore included for reference only.
 - All mechanical, electrical, plumbing and ventilation information to be in accordance with Mechanical and Electrical Engineer's design, details and specification.
 - For references to soil + vent pipes / rain water pipes / stub-stacks / gullies / drainage channels / etc; refer to the Mechanical and Electrical Engineer's design drawings.
 - All screed butting existing masonry walls which have been removed, to be made good and level to match existing.

- Denotes MDF raised access floor
- Denotes Metal raised access floor

ISSUED FOR CONSTRUCTION

NB: - Solid gray hatch denotes existing building fabric.

Rev	Date	By	Chk	Comment
A	16.09.11	RKC	JAS	Status change - Issued for CONSTRUCTION

BRINGING IDEAS TO LIFE

FRANKHAM

Frankham Consultancy Group Limited
21 Perryman Road
Haywards Heath RH16 3TP
t 01444 444900 f 01444 455642
enquire@frankham.com
www.frankham.com

Client

WILLMOTT DIXON CONSTRUCTION

Project Title

Wealden District Council
Hailsham Head Quarters
Refurbishments and Alterations

Drawing Title

Proposed Roof Plan
Council Offices Building
Builder's Works Plan

Drawn by: RKC	Scale: 1:100@A1	Date: 22.11.10
Designed by: FCG	Checked by: JAS	Approved by: [Signature]

File Ref.: X:\FRANKHAM\2006\16\WALDEN\DOOR\10_16_LOCATION_PLAN_RUC.DWG
22/11/10 14:25:33 20061116_08_43

Drawing No. 521185-A-187	Rev. A
------------------------------------	------------------

NB: All information based on supplied third party survey information. All discrepancies to be reported to FCG immediately upon discovery.