

Existing area of roof to be removed to accommodate new flat roof/gutter area over link building in accordance with Structural Engineer's design and specification

Existing plant to be removed and roof areas made good in accordance with M&E Engineer's design and specification

Existing area of roof to be removed to accommodate new roof lantern and ventilation strategy in accordance with Structural Engineer's design and specification

All existing roof slates and tiles to be retained, wire brush cleaned and carefully stacked for re-use and reinstallation

Existing area of roof to be removed to accommodate new roof lantern and ventilation strategy in accordance with Structural Engineer's design and specification

Existing plant to be removed and roof areas made good in accordance with M&E Engineer's design and specification

NOTES: Do not scale this drawing. All dimensions to be checked on site prior to commencement or manufacture.

Key Plan
1:1000

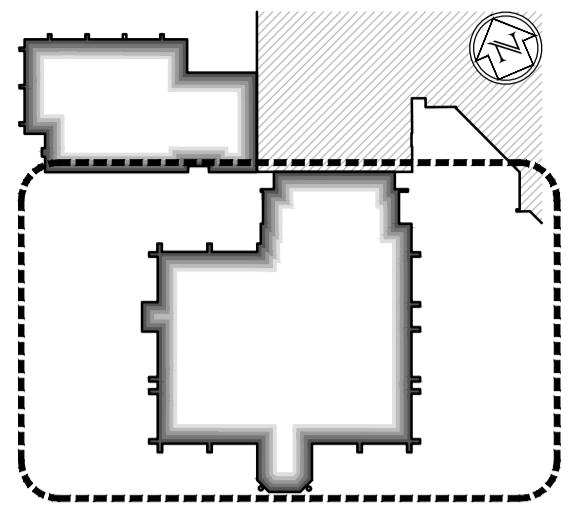

Mechanical and Electrical Strip out

All existing ground floor connections to below ground drainage are to be retained and be capped and sleeved for future re-use (to M&E Subcontractor later design) unless indicated to the contrary. All existing above ground services are deemed redundant (unless specifically required otherwise by M&E Subcontractor) and are to be carefully removed back to the fabric of the building. Stripping to be commenced only after agreement of method statements and safe working protocols. Stripping to be carried out only under a permit process. All fixings to be cut off at surface and made safe. All holes through structure and fabric to have sleeves and existing stopping material removed and holes made good i.e. filled with material appropriate to the fire rating of the original and made flush with existing surfaces. All utility supplies to be stripped back to Utility Supply Point. All stripped material to be sorted and disposed under an environmentally sensitive waste disposal plan to be agreed prior to works commencing. All systems to be made safe prior to stripping commencing. The building is of an age where it is reasonable to anticipate harmful materials may exist and prior to work commencing operatives shall be made aware of the indications within the asbestos register and survey. On discovery or suspicion of any material that may be harmful in the process of the works these shall cease until an agreed action plan is put in place including any necessary testing and licensed removal.

ISSUED FOR CONSTRUCTION

NB: - Solid gray hatch denotes existing building fabric.

Rev	Date	By	Chk	Comment
A	22.06.11	RKC	JAS	Status Change - Issued For Construction

BRINGING IDEAS TO LIFE

FRANKHAM

Frankham Consultancy Group Limited
21 Perrymount Road
Haywards Heath RH16 3TP
t 01444 444900 f 01444 455642
enquire@frankham.com
www.frankham.com

Client

WILLMOTT DIXON CONSTRUCTION

Project Title

Wealden District Council
Hailsham Head Quarters
Refurbishments and Alterations

Drawing Title

Roof Plan
Council Offices Building
Proposed Demolition Plan

Drawn by: RKC	Scale: 1:100@A1	Date: 02.03.11
Designed by: FCG	Checked by: JAS	Approved by: AC

File Ref.: X:\FRANKHAM\2006\16\WDC\ARCH\16_160\CON\PLAN\RD.DWG 20.06.11 16:09:57

Drawing No. 521185-A-197	Rev. A
------------------------------------	------------------

NB: All information based on supplied third party survey information. All discrepancies to be reported to FCG immediately upon discovery.

NB: Contractor to fully investigate and determine load bearing capacity of all building elements and materials and consult with Architect and Structural Engineer prior to commencement of demolition works. All discrepancies to be reported to FCG immediately upon discovery.

All Mechanical & Electrical and Structural information shown indicative only. Please refer to Mechanical & Electrical and Structural documentation.

NB: All waste to be recycled where possible and/or disposed of in accordance with the Contractor's Site Waste Management Plan and all in accordance with current legislation, particularly, but not excluding, all hazardous materials.