

01 Latitudinal Glass Balustrade and Bulkhead Detail
Scale:1:5

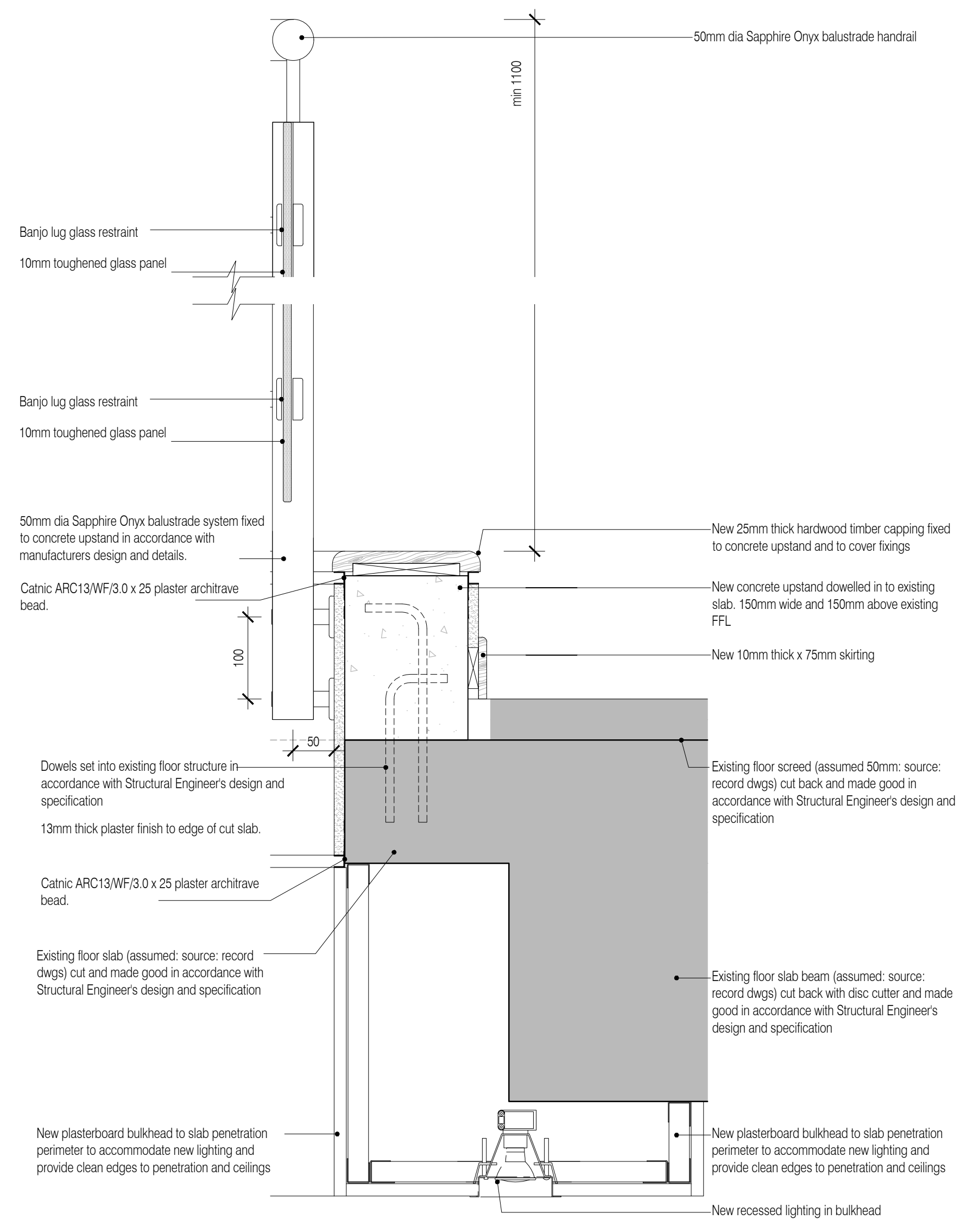

02 Longitudinal Glass Balustrade and Bulkhead Detail
Scale:1:5

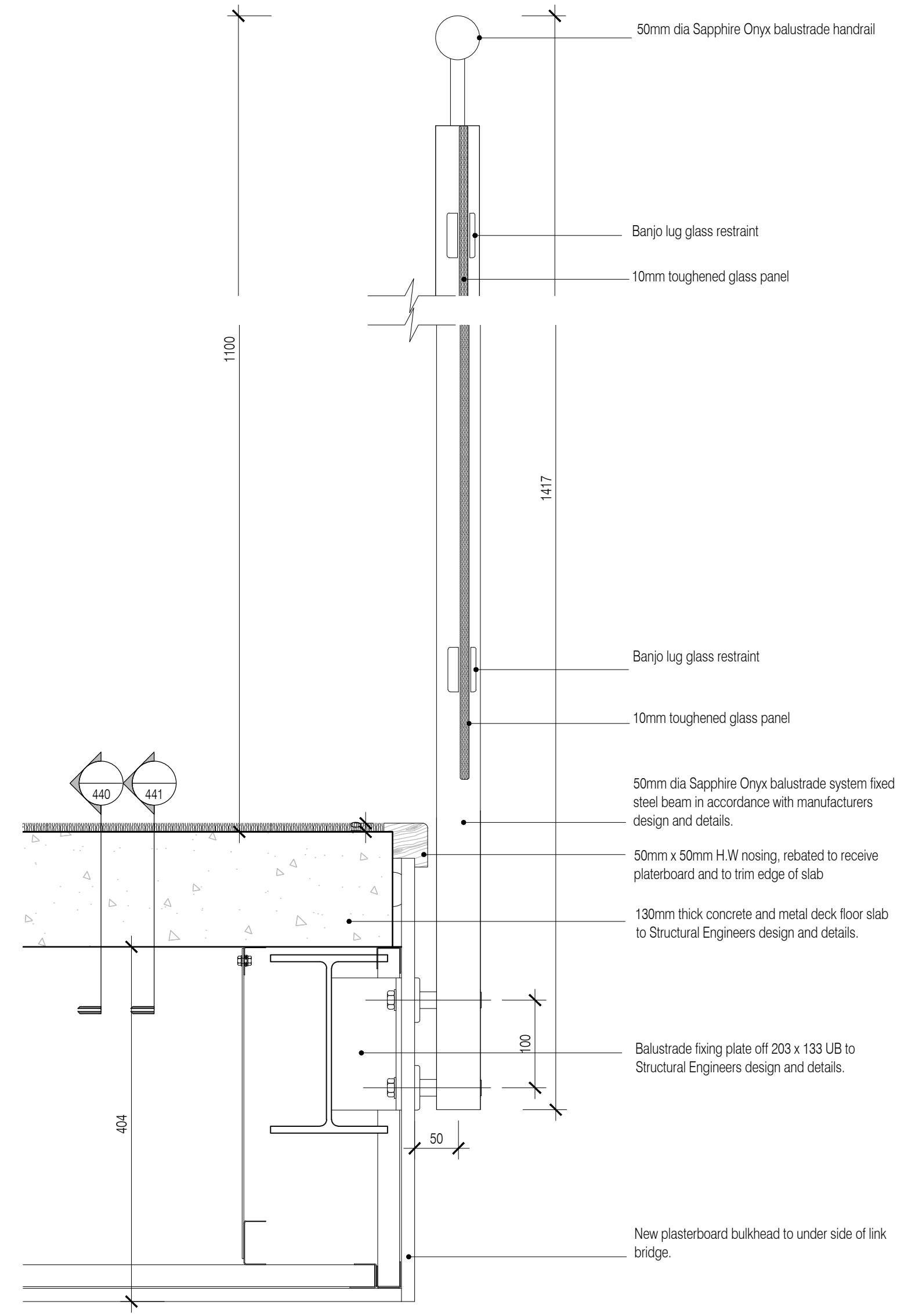

03 Glass Balustrade and Bulkhead Detail Link Bridge
Scale:1:5

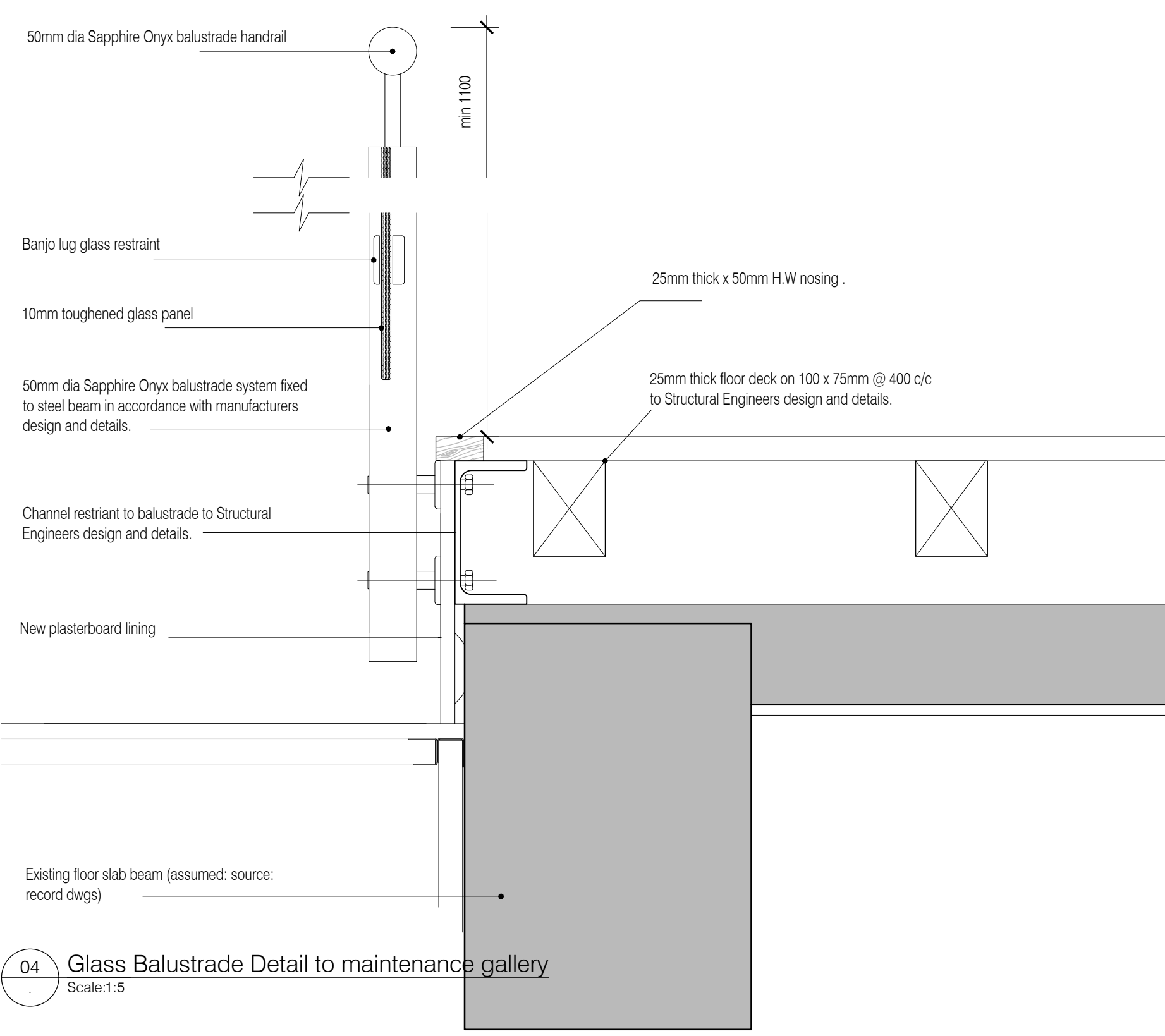

04 Glass Balustrade Detail to maintenance gallery
Scale:1:5

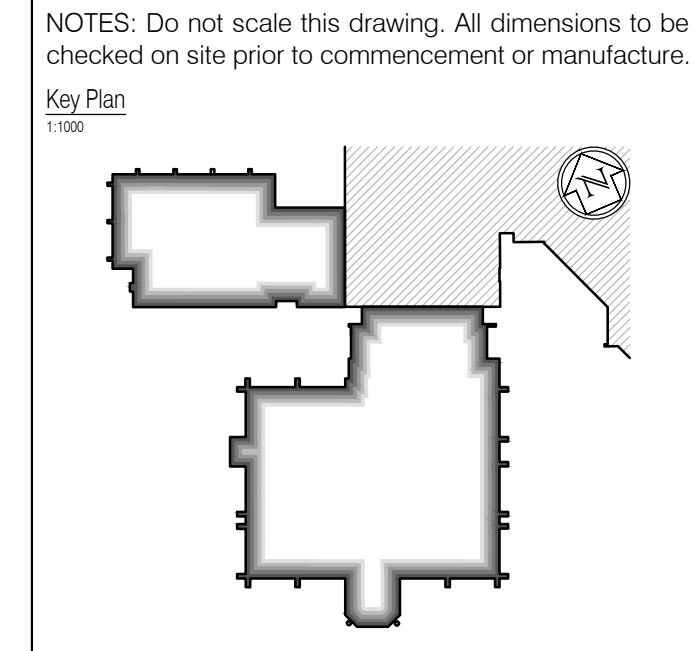

NOTES: Do not scale this drawing. All dimensions to be checked on site prior to commencement or manufacture.

Key Plan
1:1000

ISSUED FOR CONSTRUCTION

NB: - Solid gray hatch denotes existing building fabric.

Rev	Date	By	Chk	Comment
A	16.09.11	RKC	JAS	Status change - Issued for CONSTRUCTION

BRINGING IDEAS TO LIFE



FRANKHAM

Frankham Consultancy Group Limited
21 Perrymount Road
Haywards Heath RH16 3TP
t 01444 444900 f 01444 455642
enquire@frankham.com
www.frankham.com

Client



WILLMOTT DIXON CONSTRUCTION

Project Title

Wealden District Council
Hailsham Head Quarters
Refurbishments and Alterations

Drawing Title

Glass Balustrade and Bulkhead
inc. Upstand
Details

Drawn by: RKC	Scale: 1:5@A1	Date: 04.02.11
Designed by: FCG	Checked by: JAS	Approved by: AC

File Ref.: X:\FRANKHAM\CG\21185\WALDEN\DOORWAY_400_DETAL_S04EM1031_07180-A-04A.DWG - 2008110001	20.06.11:16.20.23
Drawing No. 521185-A-404	Rev. A