

01 Jamb detail  
Scale: 1:5

02 Elevation  
Scale: 1:10

NB: All information based on supplied third party survey information. All discrepancies to be reported to FCG immediately upon discovery.

NOTES: Do not scale this drawing. All dimensions to be checked on site prior to commencement or manufacture.

Key Plan  
1:1000

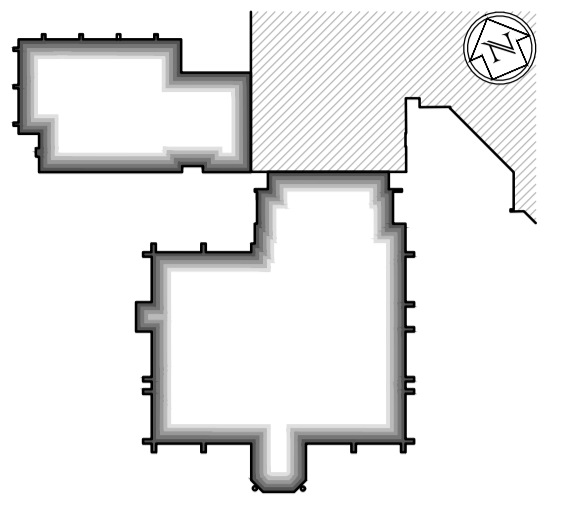

All window details to be in accordance with and finalised by Velfac prior to manufacture and all drawings to be checked on site prior to installation. Architect to be informed on discovery of any discrepancy and work to cease on particular area until resolved with Manufacturer

**ISSUED FOR CONSTRUCTION**

NB: - Solid gray hatch denotes existing building fabric.

Rev	Date	By	Chk	Comment
A	16.09.11	RKC	JAS	Status change - Issued for CONSTRUCTION

BRINGING IDEAS TO LIFE



FRANKHAM

Frankham Consultancy Group Limited  
21 Perryman Road  
Haywards Heath RH16 3TP  
t 01444 444900 f 01444 455642  
enquire@frankham.com  
www.frankham.com

Client  
**WILLMOTT DIXON CONSTRUCTION**

Project Title  
Wealden District Council  
Hailsham Head Quarters  
Refurbishments and Alterations

Drawing Title  
New Doors / Side Screen / Louver Infill  
Reception (G15)  
Details

Drawn by: RKC	Scale: 1:5 + 1:10 @A1	Date: 20.05.11
Designed by: FCG	Checked by: JAS	Approved by: AC

File Ref.: X:\FRANKHAM\CG\2011\16\WALDEN\DOOR\456\_460\_DETAL\_SCHMATIC\_521185-A-416.dwg - 20/05/11 16:22:08

Drawing No. 521185-A-416	Rev. A
-----------------------------	-----------