

These drawings have been edited in accordance with Willmott Dixon's instructions. All material, product, volume, dimension and performance information is indicative only. FCG repudiate any and all liability for failure or non performance of any of the above mentioned items as indicated on this or any other FCG documentation.

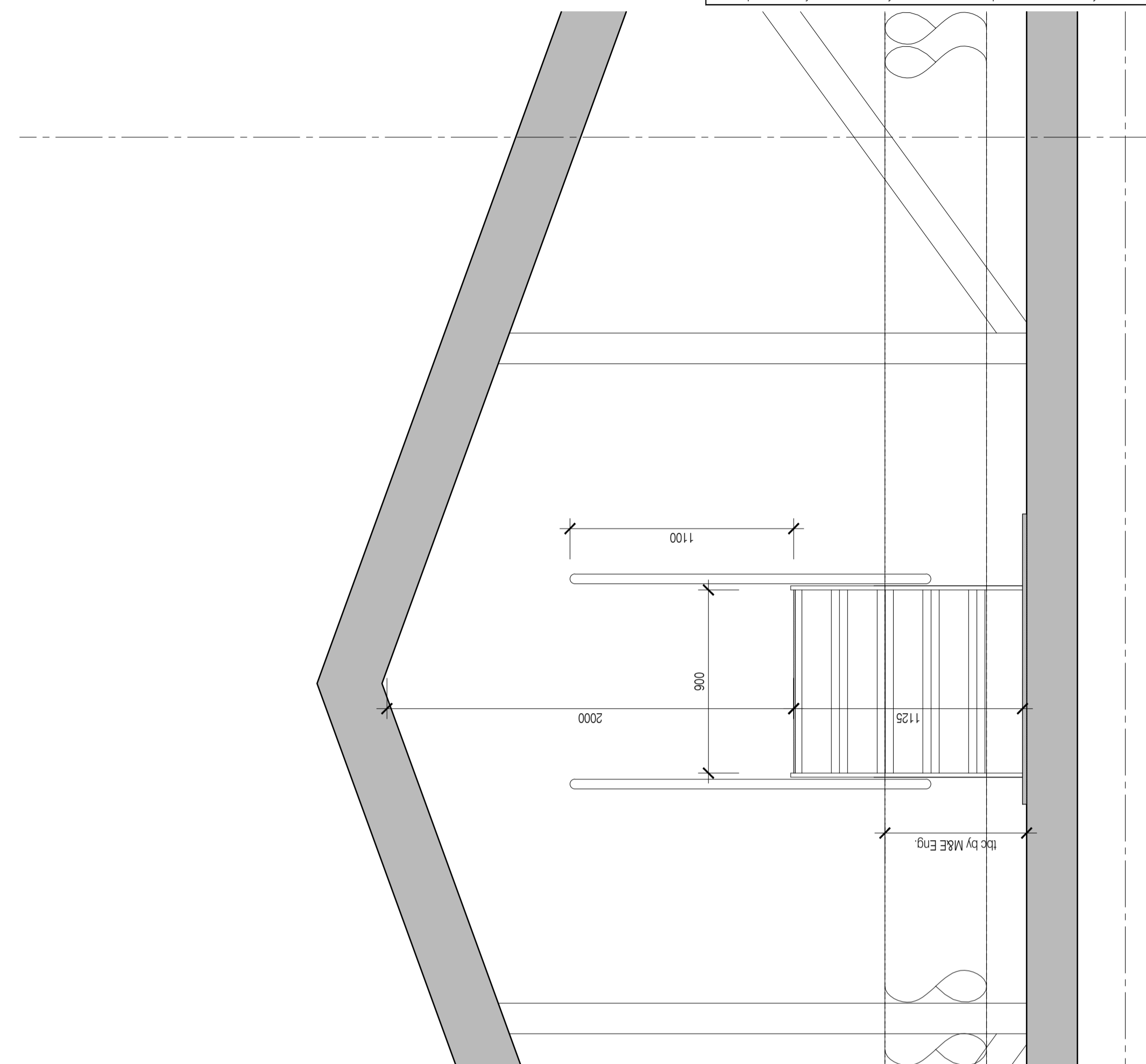

01 Partial Third Floor Plan
Scale:1:20



03 Partial Section 01 (Existing)
Scale:1:20

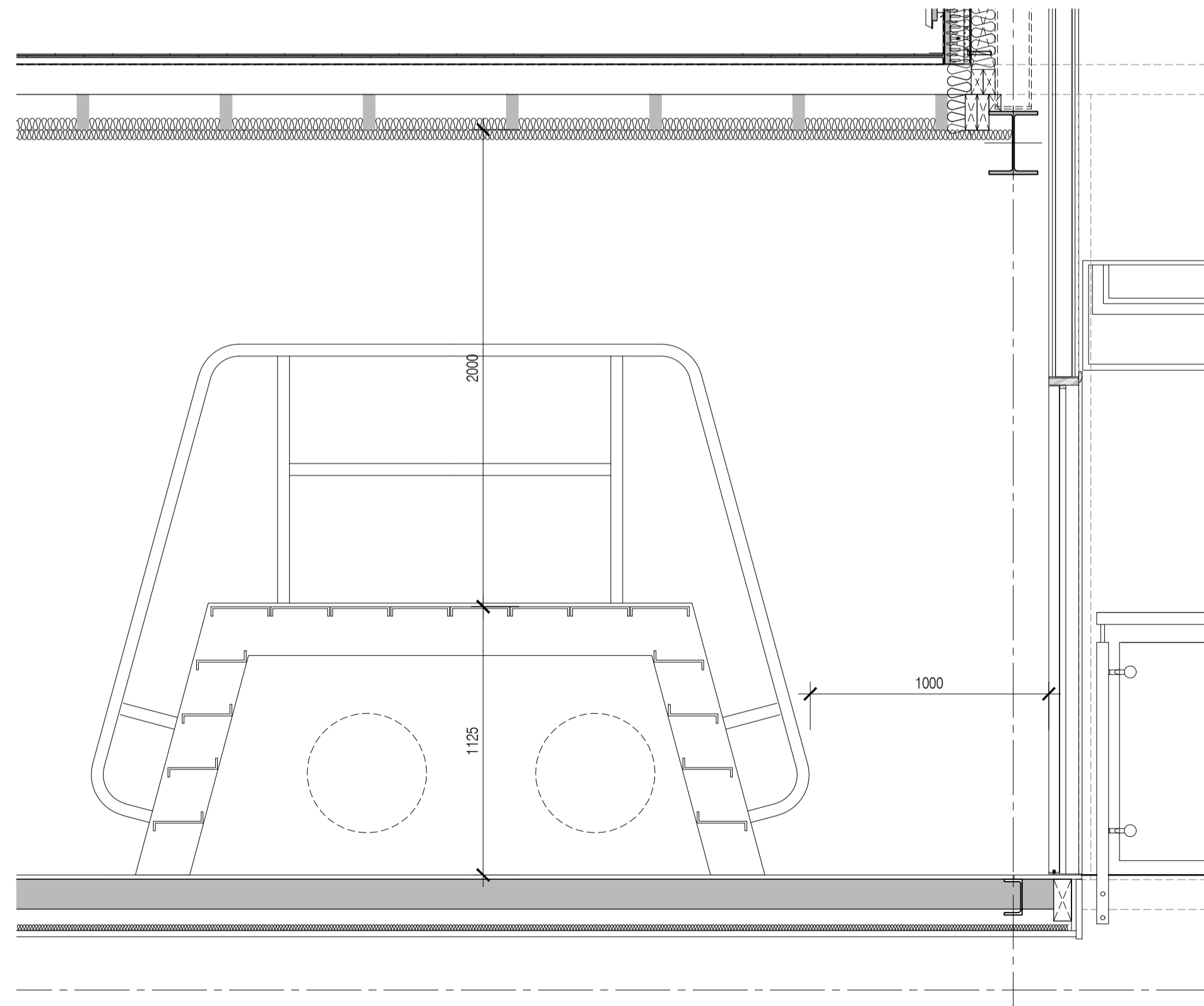

02 Partial Section 03
Scale:1:20

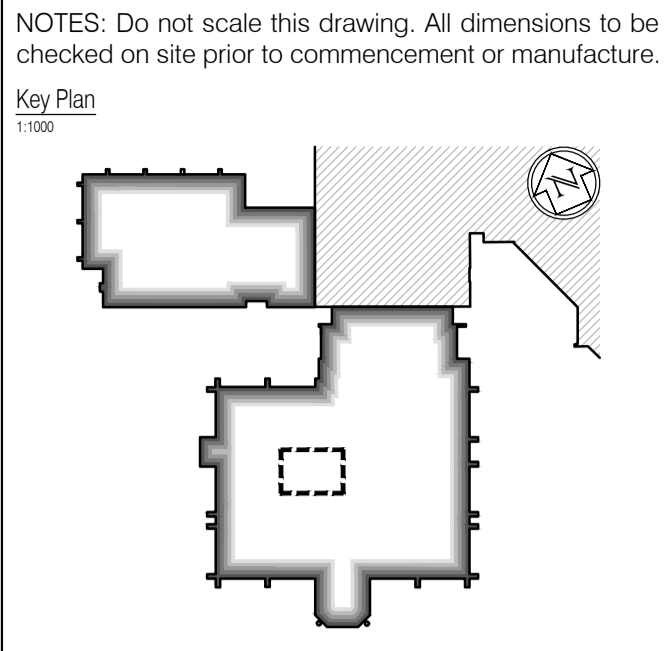

NOTES: Do not scale this drawing. All dimensions to be checked on site prior to commencement or manufacture.

Key Plan
1:1000

**STAGE - D
DESIGN ISSUE**

NB: - Solid gray hatch denotes existing building fabric.

Rev	Date	By	Chk	Comment

01 06.10.11 RKC JAS Issued for APPROVAL

Rev Date By Chk Comment

BRINGING IDEAS TO LIFE

FRANKHAM

Frankham Consultancy Group Limited
21 Parnmount Road
Haywards Heath RH16 3TP
t 01444 444900 f 01444 455642
enquire@frankham.com
www.frankham.com

Client

**WILLMOTT DIXON
CONSTRUCTION**

Project Title

Wealden District Council
Hailsham Head Quarters
Refurbishments and Alterations

Drawing Title

"Up & Over" Gantry
Detail

Drawn by: RKC	Scale: 1:20@A1	Date: 06.10.11
Designed by: FCG	Checked by: JAS	Approved by: AC
File Ref.: X:\FRANKHAM\2011\185\WALDEN\CONSTRUCTION\40 DETAIL SCHEMATIC\201104-4-21 DWG - 20111029		20.06.11:16:22:50

Drawing No. 521185-A-421	Rev. 01
------------------------------------	-------------------

NB: All information based on supplied third party survey information. All discrepancies to be reported to FCG immediately upon discovery.

All Mechanical & Electrical and Structural information shown indicative only. Please refer to Mechanical & Electrical and Structural documentation.