

16 Non-slip Vinyl Type 1 / Vinyl Type 2 Interface
Scale:1:1

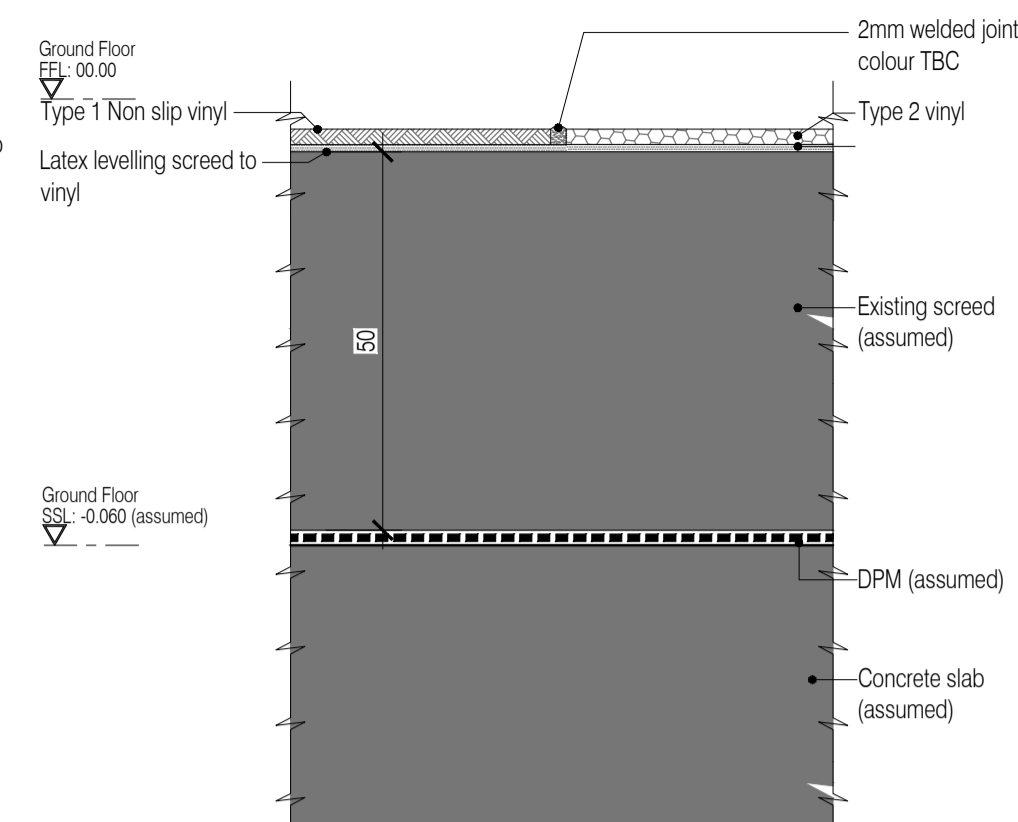

17 Non-slip Vinyl Type 2 / Vinyl Type 2 Interface
Scale:1:1

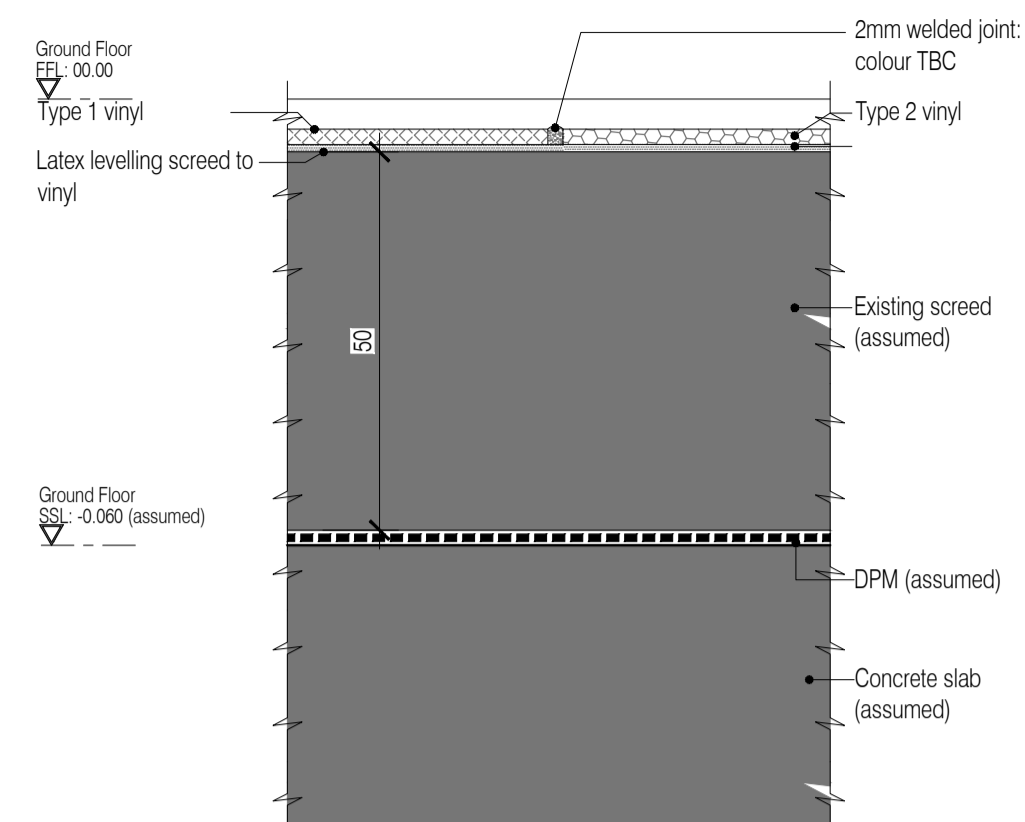

18 Vinyl Type 1 / Vinyl Type 2 Interface
Scale:1:1

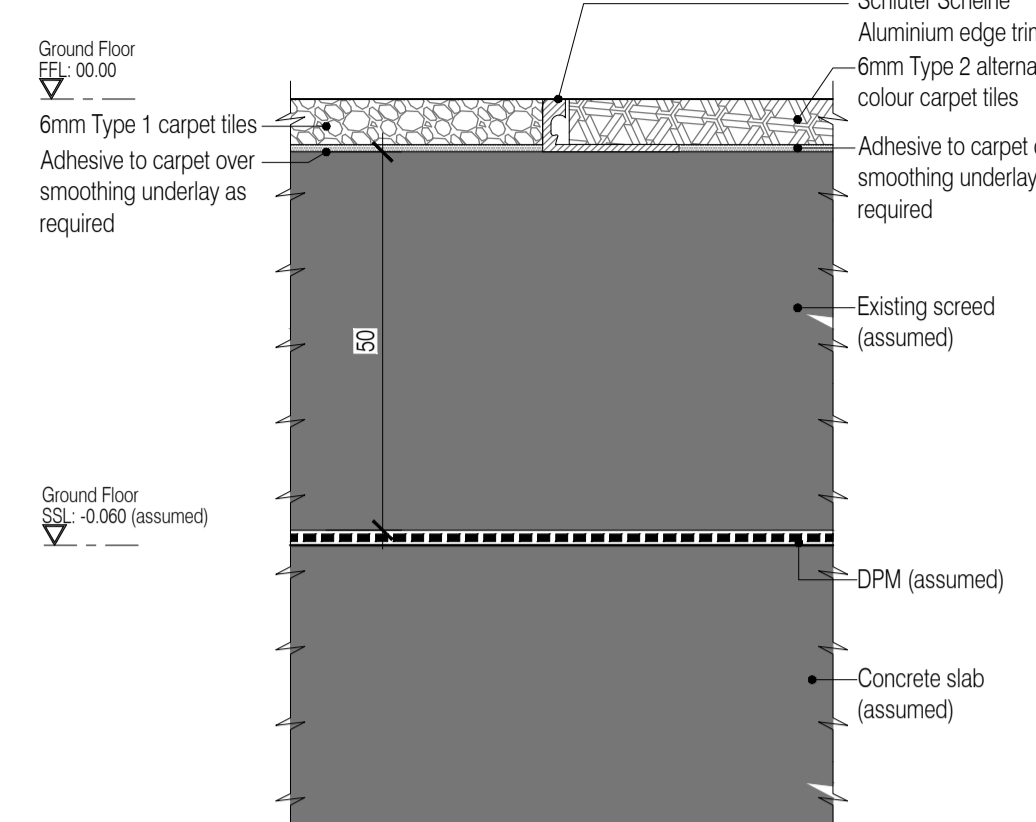

19 Carpet tiles Type 1 / Circulation & Stair Carpet Interface
Scale:1:1

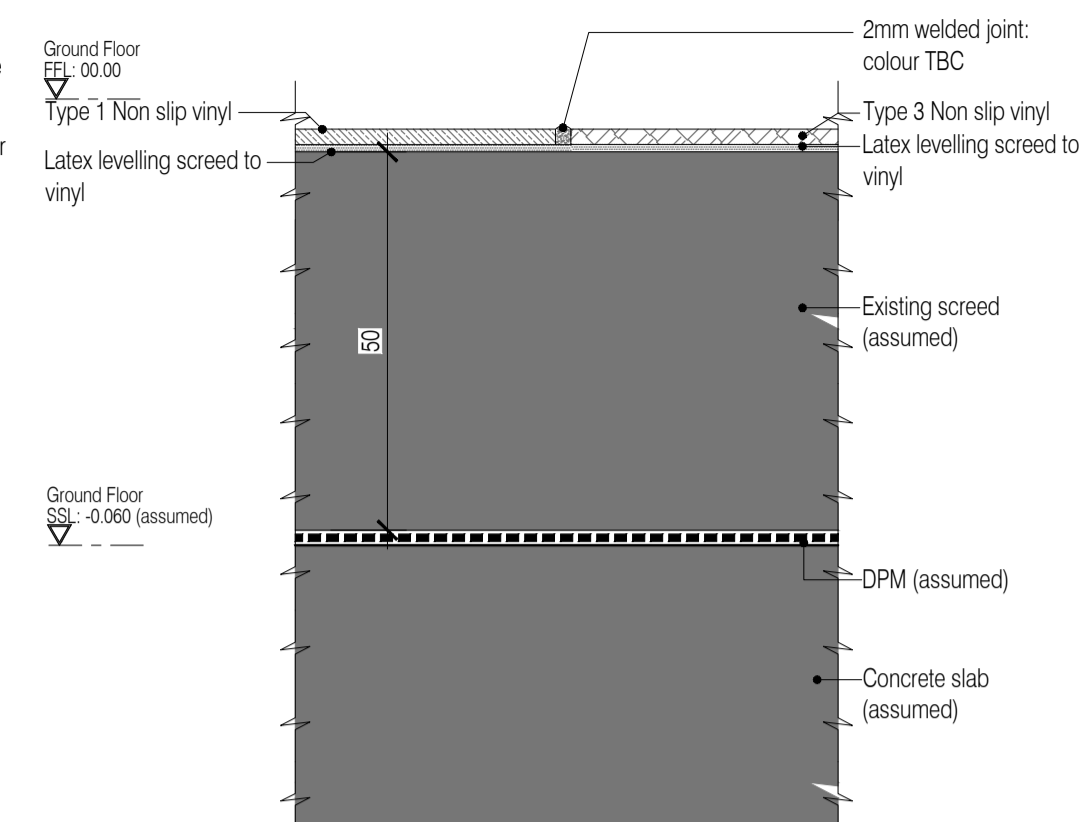

20 Non slip vinyl Type 1 / Non slip vinyl Type 3 Interface
Scale:1:1

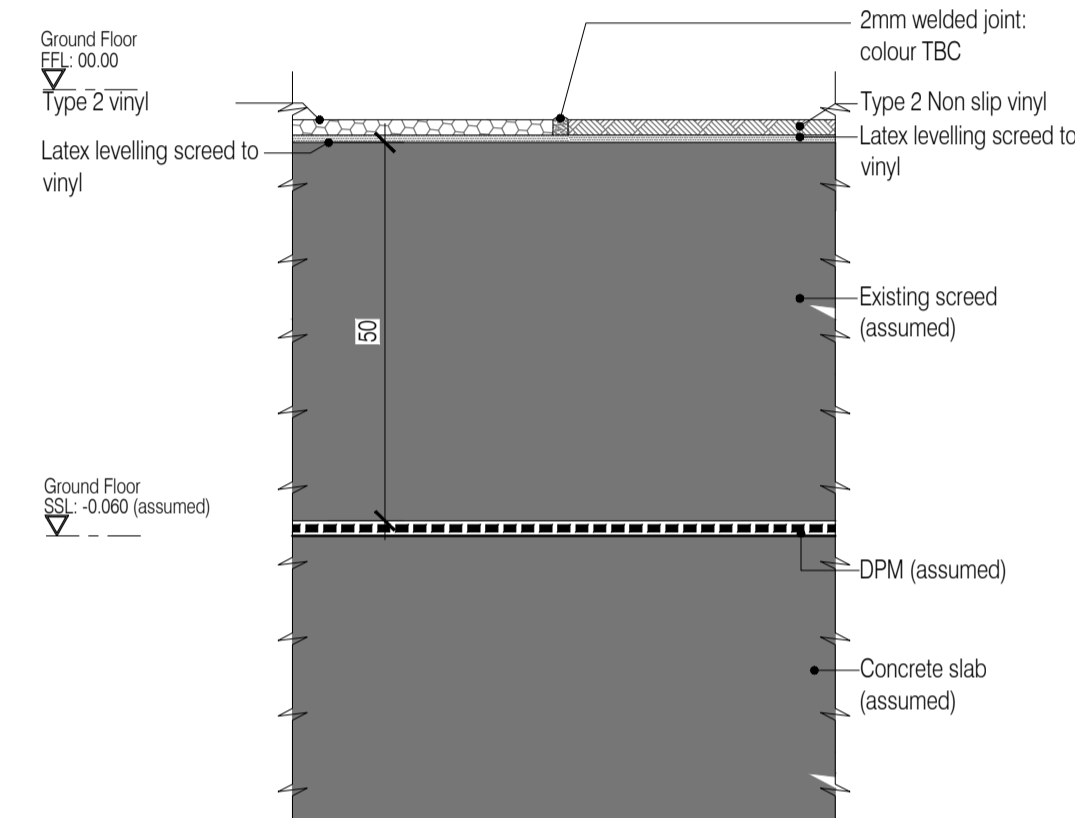

21 Vinyl Type 2 / Non slip vinyl Type 2 Interface
Scale:1:1

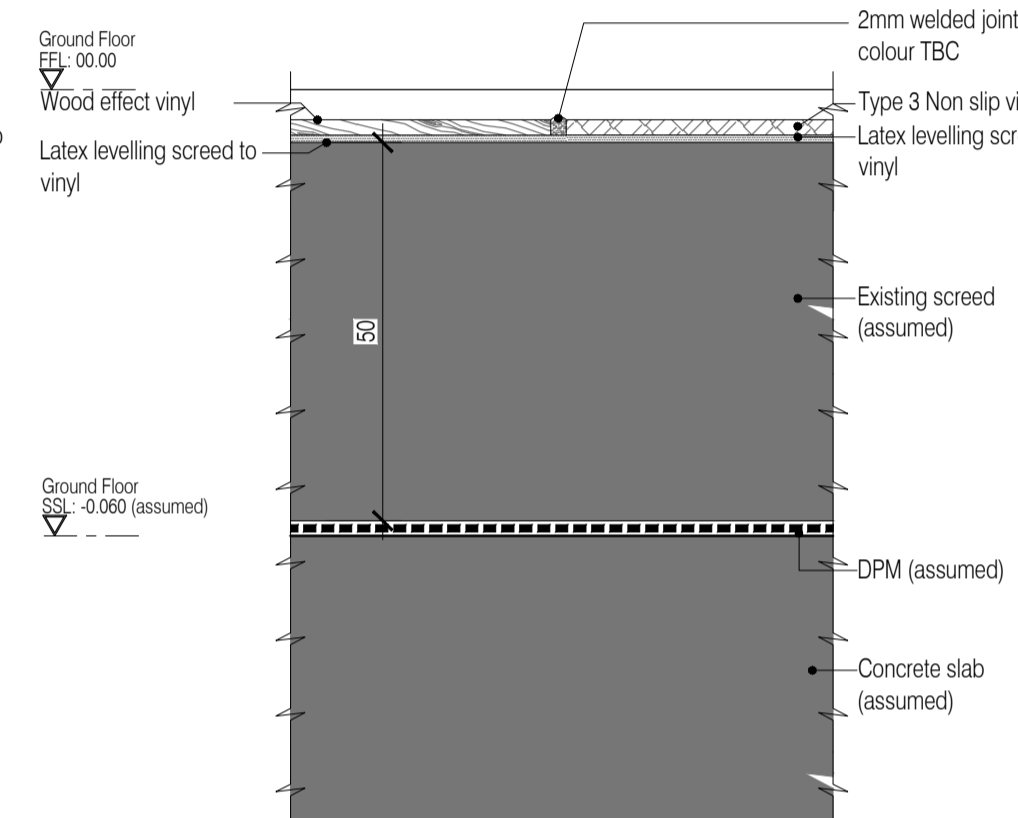

22 Wood effect vinyl / Non slip vinyl Type 3 Interface
Scale:1:1

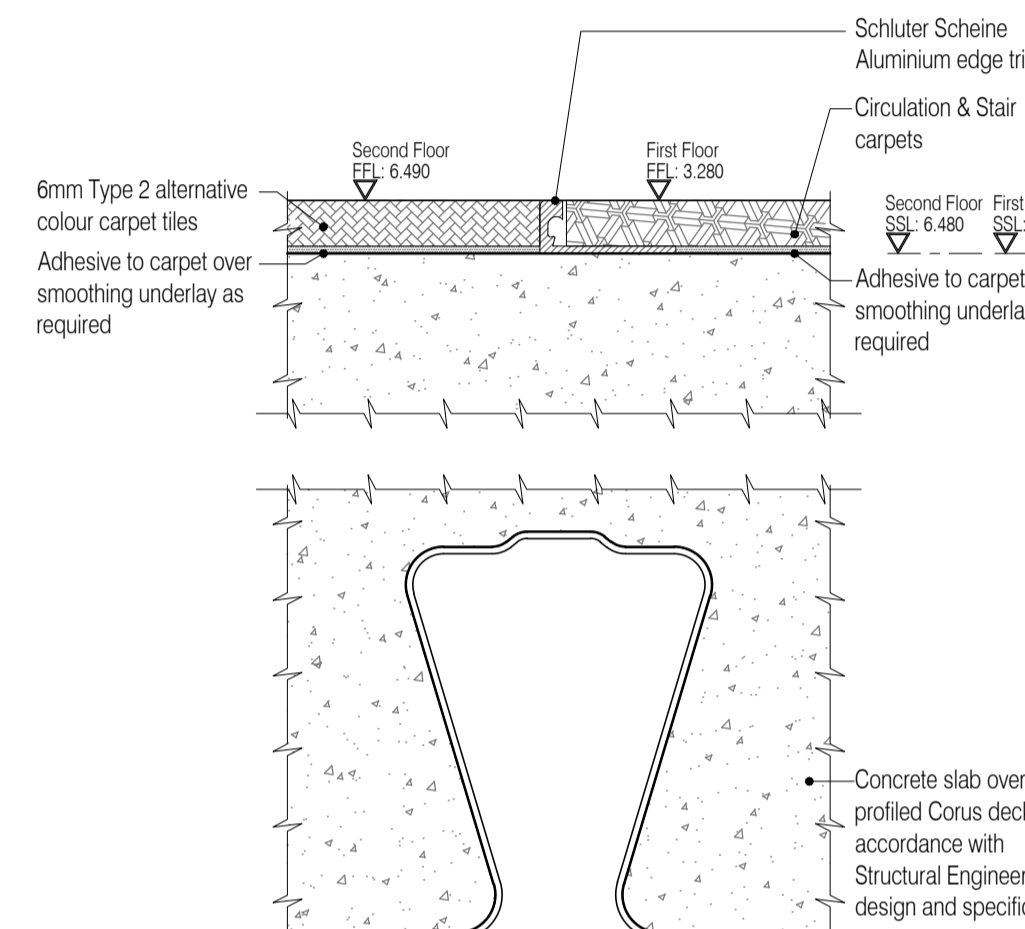

24 Carpet tiles Type 2 / Circulation & Stair carpet Interface
Scale:1:1

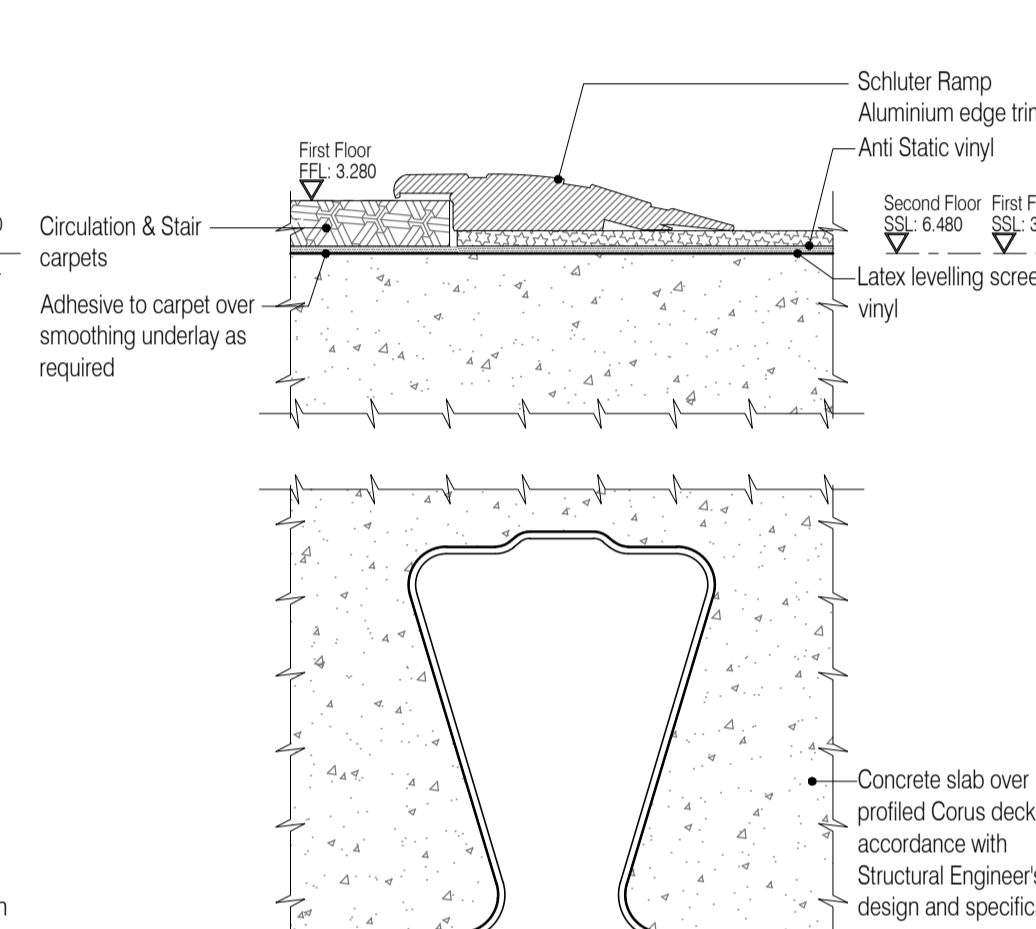

25 Circulation & Stair carpet / Anti Static Vinyl Interface
Scale:1:1

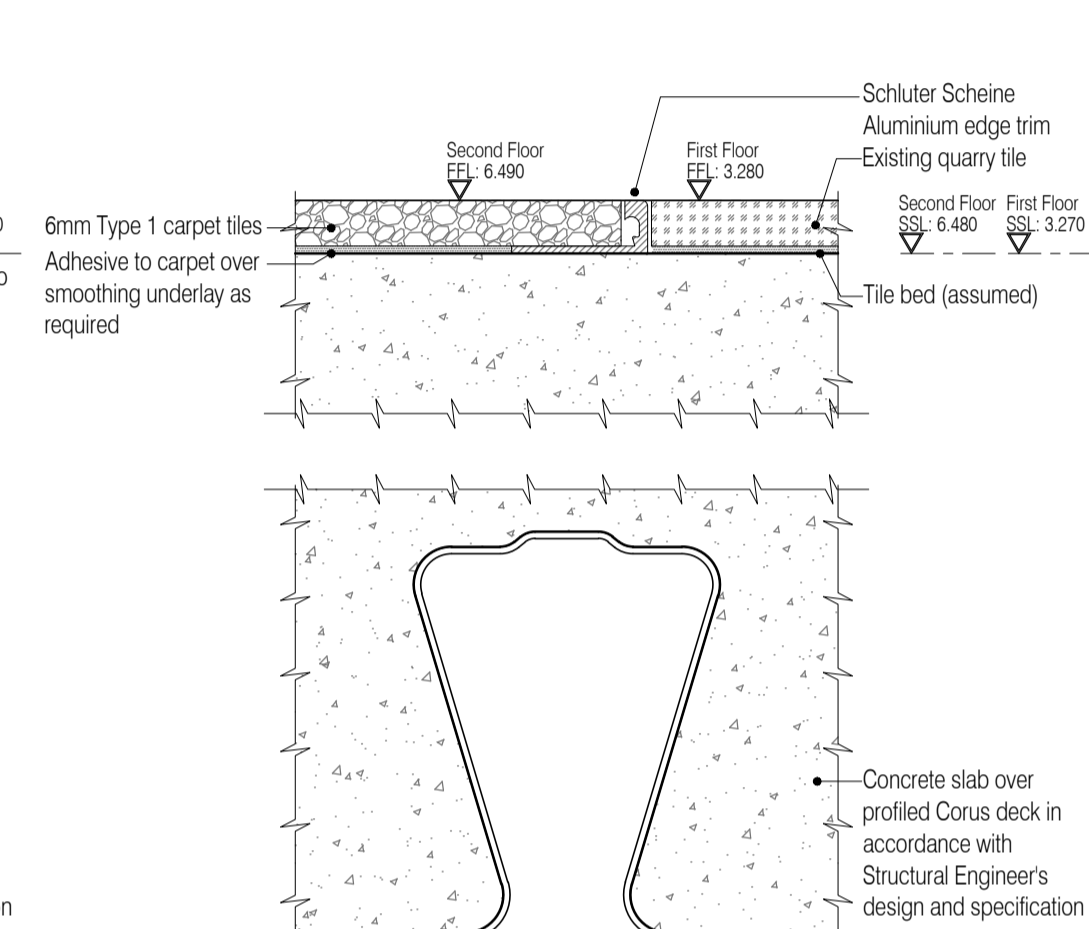

27 Carpet tiles Type 1 / Existing Flooring Interface
Scale:1:1

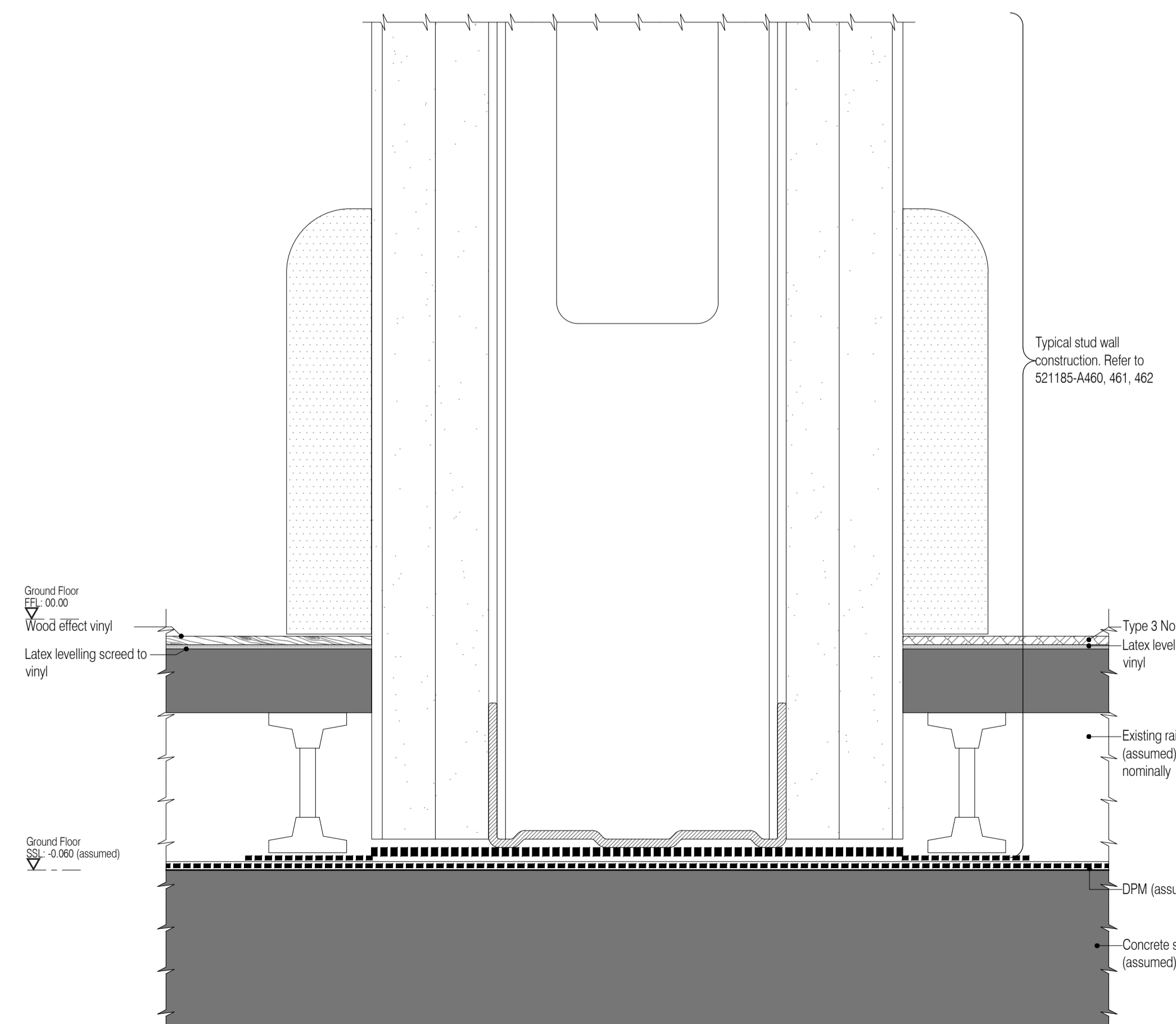

28 Typical Raised Floor Wood effect vinyl / Non slip vinyl Type 3 Interface
Scale:1:1

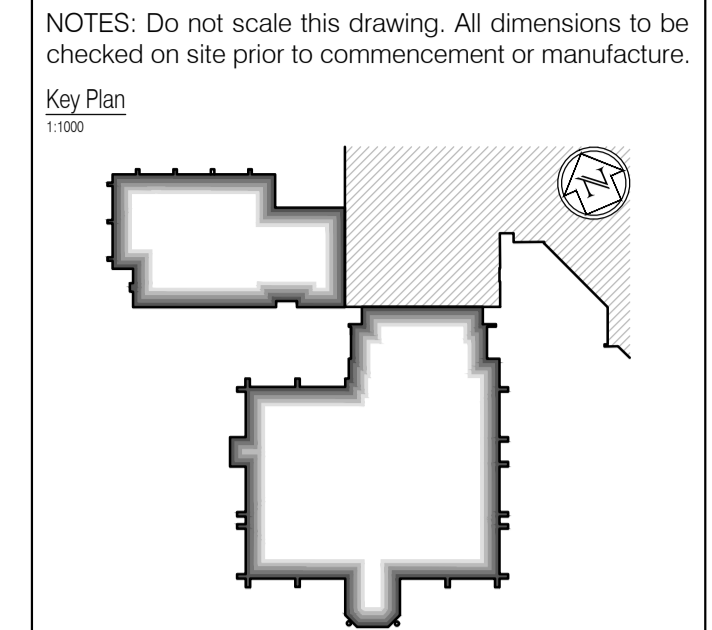

NOTES: Do not scale this drawing. All dimensions to be checked on site prior to commencement or manufacture.

Key Plan
1:1000

Screed depths may vary depending on floor finish and location. Main Contractor to determine screed depth required for each location to accommodate floor finish, underlay, membranes, paints, fixings, etc to maintain finished floor levels.

ISSUED FOR CONSTRUCTION

NB: - Solid gray hatch denotes existing building fabric.

Rev	Date	By	Chk	Comment
A	16.09.11	FRK	JAS	Status change - Issued for CONSTRUCTION

BRINGING IDEAS TO LIFE

FRANKHAM

Frankham Consultancy Group Limited
21 Perrymount Road
Haywards Heath RH16 3TP
t 01444 444000 f 01444 455642
enquiries@frankham.com
www.frankham.com

Client

WILLMOTT DIXON CONSTRUCTION

Project Title

Wealden District Council
Hailsham Head Quarters
Refurbishments and Alterations

Drawing Title

Floor Finishes
Interface Details
Sheet 2 of 2

Drawn by: FRK	Scale: 1:1@A1	Date: 01.07.11
Designed by: FCG	Checked by: JAS	Approved by: AC

File Ref.: X:\FRANKHAM\2011\16\25\26\521185-A-441-001.DWG 20.06.11 16:25:26

Drawing No. 521185-A-441 Rev. A

NB: All information based on supplied third party survey information. All discrepancies to be reported to FCG immediately upon discovery.

All Mechanical & Electrical and Structural information shown indicative only. Please refer to Mechanical & Electrical and Structural documentation.