

All builders works (cutting, coring, penetrating, etc.) to be in accordance with M&E Engineers dwgs. No builders works to proceed without confirmation by Structural Engineer to maintain integrity of structure. NB: All levels are approximate and are subject to further site investigation prior to construction. All discrepancies to be reported to FCG immediately.

NOTES: Do not scale this drawing. All dimensions to be checked on site prior to commencement or manufacture.
Key Plan (r/s)

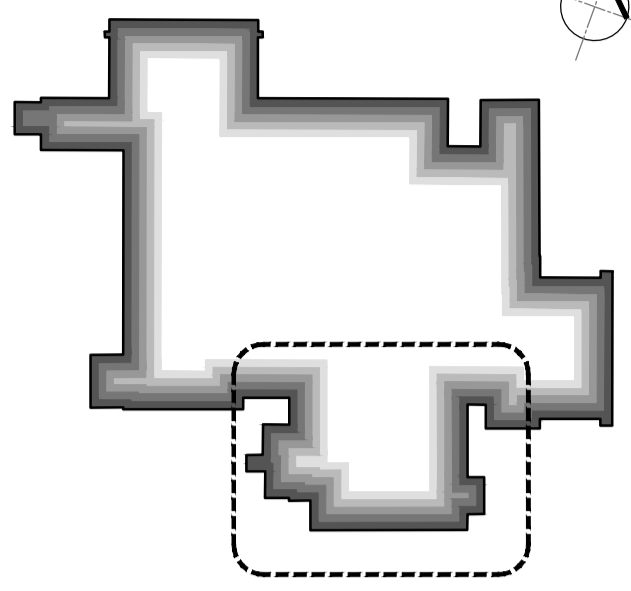

General Builder's Works Notes

- All square ductwork ventilation holes to be sized and set-out in strict accordance with the Structural Engineer's drawings - those shown on this drawing relate to those holes over-head.
- All holes set-out on this drawing for drainage are dimensioned to the centre of the holes - all hole diameters to be as confirmed by the Mechanical Engineer's drawings, and to the satisfaction of the Structural Engineer.
- Dashed lines indicate pipe-routes tracking from hole / outlet positions at floor above. For final 'exact' routing requirements, refer to Mechanical and Electrical Engineer's design drawings.
- All concrete / steelwork shown indicative sizes / locations only, and to be confirmed by Structural Engineer.
- All structural information generally to be in accordance with Structural Engineer's design, details and specification.
- Plant layouts shown here are taken directly from the Mechanical and Electrical Engineers, or Specialist Sub-contractor's design drawings, and are therefore included for reference only.
- All mechanical, electrical, plumbing and ventilation information to be in accordance with Mechanical and Electrical Engineer's design, details and specification.
- For references to soil + vent pipes / rain water pipes / stub-stacks / gulleys / drainage channels / etc; refer to the Mechanical and Electrical Engineer's design drawings.
- All screed butting existing masonry walls which have been removed, to be made good and level to match existing.

ISSUED FOR CONSTRUCTION

All details referenced in call outs supercede general arrangement or larger depictions.

| Rev | Date | By | Chk | Comment |
|-----|----------|-----|-----|-------------------------|
| 01 | 29.03.12 | RKC | JAS | Issued for CONSTRUCTION |

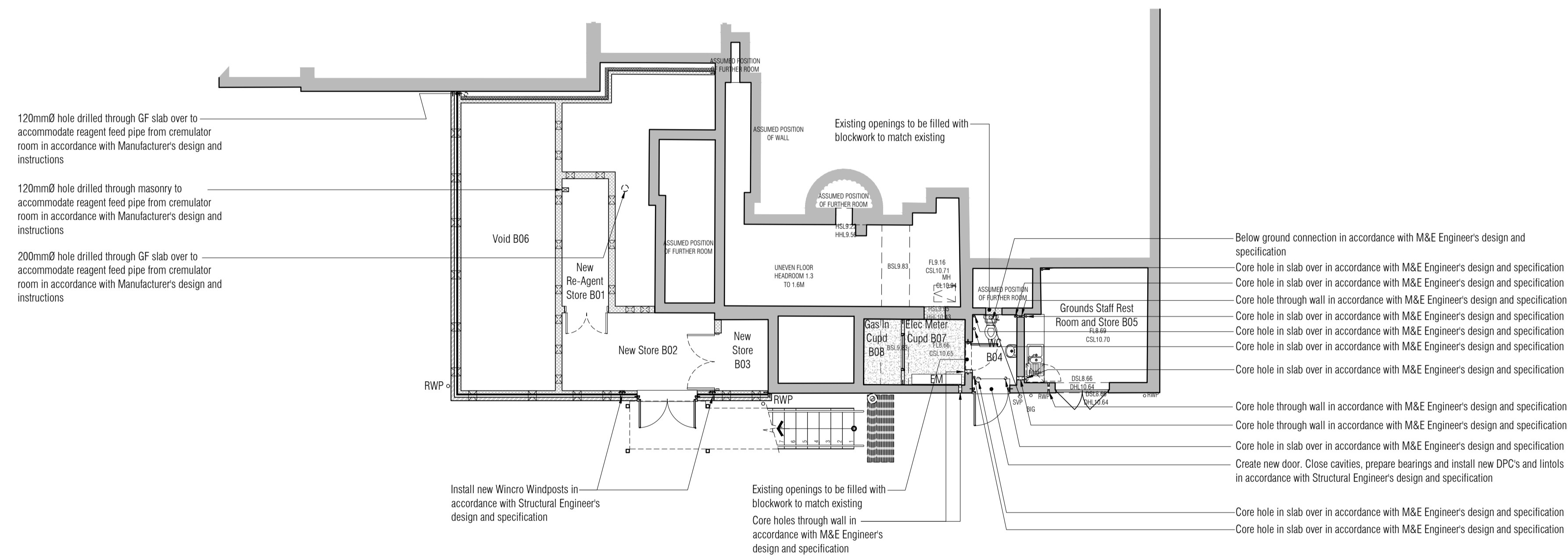

NB: All information based on supplied third party survey information. All discrepancies to be reported to FCG immediately upon discovery.

NB: Contractor to fully investigate and determine load bearing capacity of all building elements and materials and consult with Architect and Structural Engineer prior to commencement of demolition works. All discrepancies to be reported to FCG immediately upon discovery.

NB: All waste to be recycled where possible and/or disposed of in accordance with the Contractor's Site Waste Management Plan and all in accordance with current legislation, particularly, but not excluding, all hazardous materials.

BRINGING IDEAS TO LIFE

FRANKHAM

Frankham Consultancy Group Limited
21 Plympton Road
Haywards Heath RH16 3TP
t 01444 444900 f 01444 455642
enquire@frankham.com
www.frankham.com

Client

Mansell
Contract N°: MC0269

Project Title

Eastbourne & Worthing
Crematoria
Refurbishments and Alterations

Drawing Title

EASTBOURNE
Eastbourne Crematorium
Lower Ground Floor
Builders Works Plan

| | | |
|---------------------|--------------------|--------------------|
| Drawn by: RKC | Scale: 1:100@A1 | Date: 01.11.11 |
| Designed by: FCG | Checked by: JAS | Approved by: AC |

File Ref.: X:\FRANKHAM\2\061112\00 CREMATORIA\ARCH\106-109-LOCATOR PLANS AND DWG - 20081117.DWG 20.06.11.12.10.35

| | |
|-------------------------------|------------|
| Drawing No. 521260-A-120-E | Rev. C1 |
|-------------------------------|------------|