

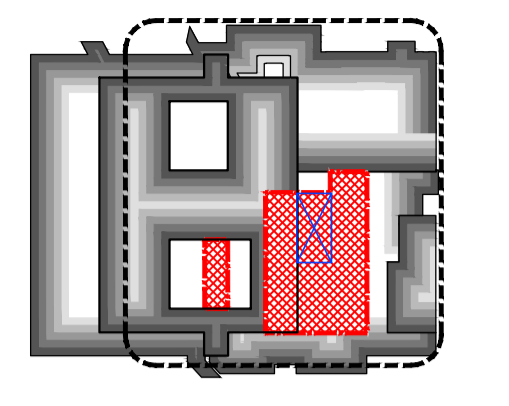

NB: All levels are approximate and are subject to further site investigation prior to construction. All discrepancies to be reported to FCG immediately.

NOTES: Do not scale this drawing. All dimensions to be checked on site prior to commencement or manufacture. Key Plan (nts)



Existing Drainage Legend
 - Green line: Denotes existing below ground foul water drainage
 - Yellow line: Denotes existing below ground surface water drainage

Typical General Arrangement DWG N° Key
 Stage: 1-Existing, 2-Demolition
 3+-Proposals
 Job N°: 621717-A-100
 Discipline: Level N°
 Sheet series N°:
 0= Extents
 1-5= Zones
 Dwg Series

BUILDING REGS ISSUE

All details referenced in call outs supercede general arrangement or larger depictions.

Rev	Date	By	CHK	Comment
P3	24.03.14	RKC	ADM	Issued for Building Regulations Approval
P2	22.11.13	RKC	ADM	Refs added
P1	01.11.13	RKC	AGC	Preliminary Issue for Information



FRANKHAM

Frankham Consultancy Group Limited
 21 Perryman Road
 Heywards Heath, RH16 3TP
 t 01444 444900 f 01444 455642
 enquiry@frankham.com
 www.frankham.com

Client
St George's Healthcare NHS Trust

Project Title
 General Intensive Care Unit Extension
 St. James Wing
 St. Georges Hospital
 London

Drawing Title
 Existing Ground Floor
 General Arrangement
 Plan

Drawn by: RKC	Scale: 1:100@A1	Date: 03.10.13
Designed by: FCG	Checked by: MDK	Approved by: AGC

File Ref: K:\FRANKHAM\2013\031717\11\02\04\03\10-04-13\521717-A-100.dwg	20.06.12:13:54:37
Drawing No: 521717-A-100	Rev: P3

NB: All information based on supplied third party survey information. All discrepancies to be reported to FCG immediately upon discovery.

All Mechanical & Electrical and Structural information shown indicative only. Please refer to Mechanical & Electrical and Structural documentation.