



NB: All information based on supplied third party survey information. All discrepancies to be reported to FCG immediately upon discovery.

All Mechanical & Electrical and Structural information shown indicative only. Please refer to Mechanical & Electrical and Structural documentation.

NB: All levels are approximate and are subject to further site investigation prior to construction. All discrepancies to be reported to FCG immediately.

NOTES: Do not scale this drawing. All dimensions to be checked on site prior to commencement or manufacture. Key Plan (nts)

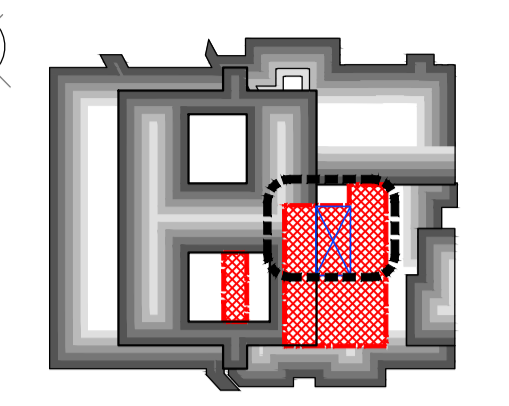

- Existing Drainage Legend**
- Denotes existing below ground foul water drainage
 - Denotes existing below ground surface water drainage
- Proposed Drainage Legend**
- Denotes new inspection chamber to be constructed
 - Denotes new foul water drainage pipe/route
 - Denotes new surface water drainage pipe/route
 - Denotes new vertical drainage pipe/route
 - Denotes new below slab drainage pipe/route
 - Denotes new overhead / ceiling void drainage pipe/route
 - Denotes new drainage pipe/route from above
 - Denotes new fitting outlet pipe (shower/WC/basin/sink)

- Window Reference Legend**
- Denotes floor level: 01 or 02
 - Denotes Window opening
 - Denotes elevation: W, S, or E.
 - Denotes opening n°
- Door & Screen Reference Legend**
- Denotes floor level
 - Denotes opening type: Door or Screen
 - Denotes room n°
 - Denotes opening n°
- Typical General Arrangement DWG N° Key**
- Stage: 1-Existing, 2-Demolition
 - 3+-Proposals
 - Job N°: 621717-A-121-0
 - Discipline
 - Level N°
 - Sheet series N°: 0= Extents, 1-5= Zones, Dwg Series

PRELIMINARY ISSUE

All details referenced in call outs supersede general arrangement or larger depictions.

Rev	Date	By	CHK	Comment
P2	04.11.14	RKC	AJM	Preliminary Issue for Information
P1	24.03.14	RKC	AGC	Issued for Building Regulations Approval

BRINGING IDEAS TO LIFE

FRANKHAM

Frankham Consultancy Group Limited
 21 Perrymount Road
 Haywards Heath RH16 3TP
 t 01444 444000 f 01444 455642
 enquiry@frankham.com
 www.frankham.com

Client: **St George's Healthcare NHS Trust**

Project Title: General Intensive Care Unit Extension
 St. James Wing
 St. Georges Hospital
 London

Drawing Title: Proposed Ground Floor General Arrangement Plan North East Quadrant

Drawn by: RKC	Scale: 1:50@A1	Date: 17.03.14
Designed by: FCG	Checked by: MDK	Approved by: AGC

File Ref: 521717-A-120-2

Drawing No: 521717-A-120-2

Rev: P2