

All Disabled and Ambulant Disabled facilities to comply with Approved Document Part M - "Access to and use of buildings", Equality Act and BS83000 as required.

NB: All levels are approximate and are subject to further site investigation prior to construction. All discrepancies to be reported to FCG immediately.

NOTES: Do not scale this drawing. All dimensions to be checked on site prior to commencement or manufacture. Key Plan (nts)

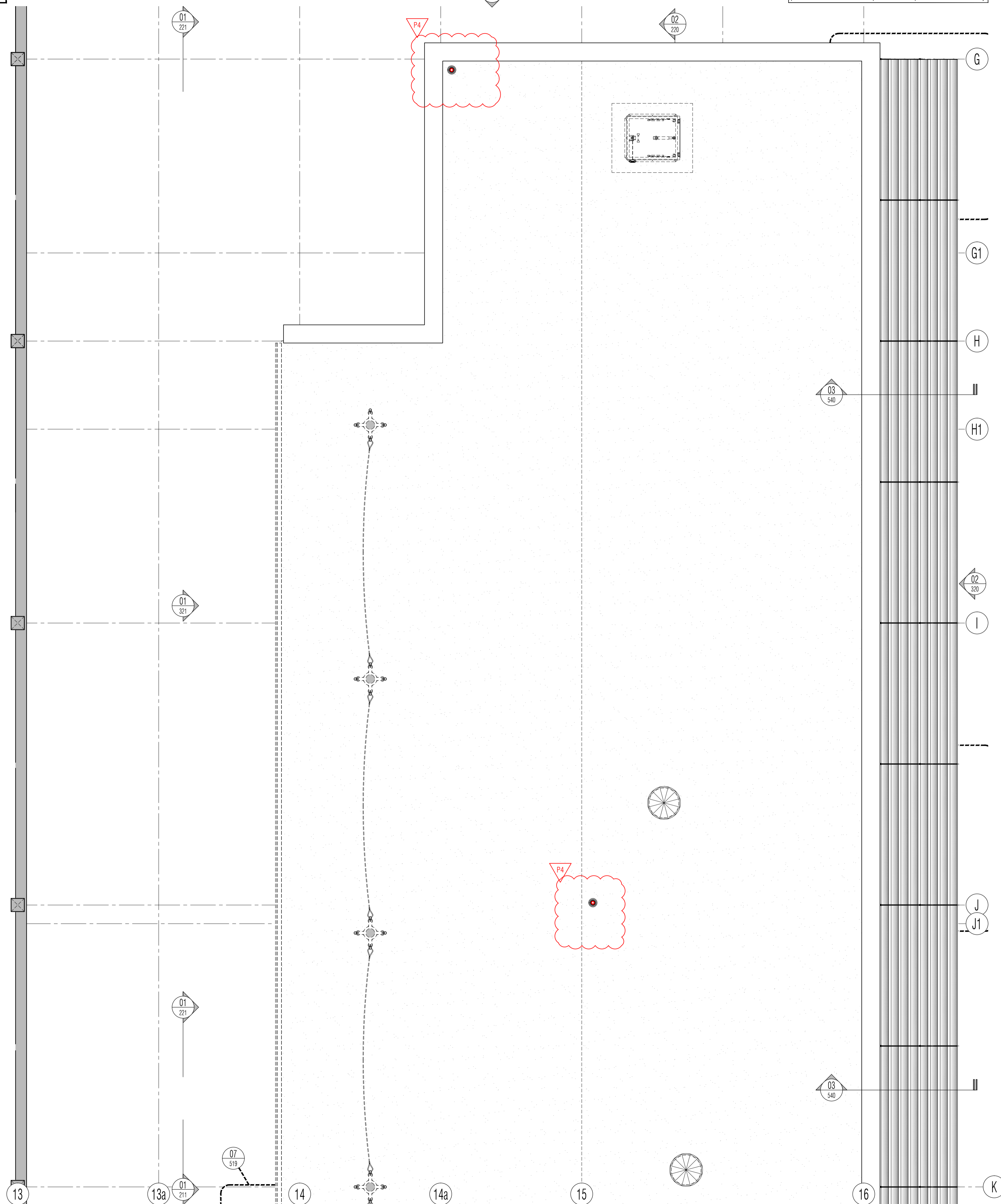
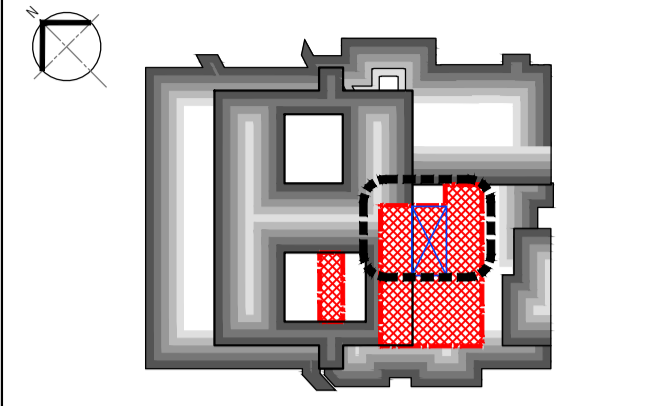

Window Reference Legend
 Denotes floor level: 01 or 02
 Denotes Window opening
 Denotes elevation: W, S, or E.
 Denotes opening n°

Door & Screen Reference Legend
 Denotes floor level
 Denotes opening type: 01
 Denotes room n°
 Denotes opening n°

Typical General Arrangement DWG N° Key
 Stage: 1-Existing, 2-Demolition
 3+-Proposals
 Job N°: 521717-A-123-2
 Discipline: 01
 Level N°
 Sheet series N°:
 0= Extents
 1-5= Zones
 Dwg Series

BUILDING REGS ISSUE

All details referenced in call outs supersede general arrangement or larger depictions.

Rev	Date	By	CHK	Comment
P4	24.03.14	RKC	AJM	Issued for Building Regulations Approval
P3	21.01.14	RKC	AJM	Refs added
P2	22.11.13	RKC	AJM	General update
P1	04.11.13	RKC	AGC	Preliminary Issue for Information

BRINGING IDEAS TO LIFE



FRANKHAM

Frankham Consultancy Group Limited
 21 Perrymount Road
 Hayward Heath RH16 3TP
 t 01444 444900 f 01444 455642
 enquiry@frankham.com
 www.frankham.com

Client
St George's Healthcare NHS Trust

Project Title
 General Intensive Care Unit Extension
 St. James Wing
 St. Georges Hospital
 London

Drawing Title
 Proposed
 Third Floor / Roof
 General Arrangement Plan
 North East Quadrant

Drawn by: RKC	Scale: 1:50@A1	Date: 03.10.13
Designed by: FCG	Checked by: MDK	Approved by: AGC

File Ref.: 521717-A-123-2-DWG - 2008174081
 20.06.12:14:38:43

Drawing No:
521717-A-123-2

Rev:
P4

NB: All information based on supplied third party survey information. All discrepancies to be reported to FCG immediately upon discovery.

All Mechanical & Electrical and Structural information shown indicative only. Please refer to Mechanical & Electrical and Structural documentation.