

NB: All levels are approximate and are subject to further site investigation prior to construction. All discrepancies to be reported to FCG immediately.

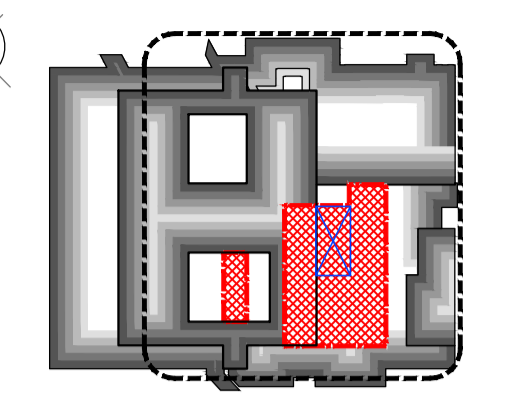

NOTES: Do not scale this drawing. All dimensions to be checked on site prior to commencement or manufacture. Key Plan (nts)



- Reflected Ceiling Plan Legend**
- Denotes existing ceiling. Visible flat ceilings and soffits to be made good and painted if applicable. NBS:
  - Denotes external plant deck and structure in accordance with Structural Engineers design and specification.
  - Denotes brise soleil fixed at parapet level. NBS:
  - Denotes suspended ceiling system with Bioguard Acoustic ceiling tile 600 x 600 grid. NBS: K40/115
  - Denotes suspended ceiling system with Hydroboard ceiling tile 600 x 600 grid. NBS: K40/115A
  - Denotes plasterboard bulkhead on metal frame system. NBS: K40/385
  - Denotes MF ceiling system to u/s structural frame above suspended ceiling system. NBS: K10/220
  - Denotes Acoustic MF ceiling system to u/s structural frame above suspended ceiling system. NBS: K10/220A
  - Denotes Fire rated MF ceiling system to u/s structural frame above suspended ceiling system. NBS: K10/220B
  - Denotes unconfirmed proposed medical pendant locations. Ref. M&E dwgs. NBS: K10/220B
  - Denotes Setting Out point with ceiling height above finished floor level in millimetres. No dims shown for solid finishes.

All colours to be confirmed. Refer to schedule: 521717-A-640. Only new soffits and ceiling installations are shown. Existing ceilings may require making good, repair, upgrading and/or replacement during the construction process if these areas are disturbed, renovated and/or demolished to accommodate new erections, replacements, additions and/or installations. It is the Main Contractors duty to make prior arrangements and agreements to these ends. All beams which are intersected by partitions are to be encased along its length and sealed at intersecting elements (beam, wall, etc.) to ensure integrity of room volume and prevent the passage of airborne spectra of physics including but not limited to heat, smoke, fire, vapour, sound, odour, biologics, contaminants, etc.

Typical General Arrangement DWG N° Key  
Stage: 1-Existing, 2-Demolition  
3+-Proposals  
Job N°: 521717-A-121-0  
Discipline: Dwg Series

# PRELIMINARY ISSUE

Rev	Date	By	Chk	Comment
P1	12.06.20	RKC	AGC	Preliminary Issue for Information

BRINGING IDEAS TO LIFE



FRANKHAM

Frankham Consultancy Group Limited  
21 Pymms Road  
Haywards Heath RH16 3TP  
t 01444 444000 f 01444 455642  
enquiry@frankham.com  
www.frankham.com

Client: St George's Healthcare NHS Trust

Project Title: General Intensive Care Unit Extension  
St. James Wing  
St. Georges Hospital  
London

Drawing Title: Proposed Ground Floor Reflected Ceiling Plan

Drawn by: RKC Scale: 1:100@A1 Date: 03.10.13  
Designed by: FCG Checked by: MDK Approved by: AGC

File Ref: X:\FRANKHAM\2013\11\02\04\13\10-04-13\521717-A-121-0-01.dwg 20.06.12:15:14:38

Drawing No: 521717-A-150 Rev: P1

NB: Grid patterns with red perimeter denote areas where work is likely to be under taken requiring breaking out or removal of existing ceilings. These areas are indicated as proposed ceilings being made good or replaced, the extent of which is yet to be determined by the NHS Trust and are indicated for the purpose of tendering information.

NB: All information based on supplied third party survey information. All discrepancies to be reported to FCG immediately upon discovery.

All Mechanical & Electrical and Structural information shown indicative only. Please refer to Mechanical & Electrical and Structural documentation.