

NB: All levels are approximate and are subject to further site investigation prior to construction. All discrepancies to be reported to FCG immediately

NOTES: Do not scale this drawing. All dimensions to be checked on site prior to commencement or manufacture. Key Plan (nts)

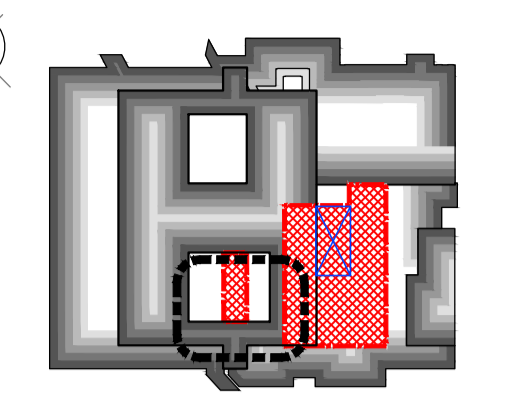

Typical General Arrangement DWG N° Key  
 Stage: 1-Existing, 2-Demolition  
 3+-Proposals  
 Job N°: 521717-A-192-3  
 Discipline: Level N°  
 Sheet series N°:  
 0= Extents  
 1-5= Zones  
 Dwg Series

**PRELIMINARY ISSUE**

All details referenced in call outs supersede general arrangement or larger depictions.

Rev	Date	By	Chk	Comment
P2	12.06.20	RKC	AJM	Isolation Ward added
P1	03.12.13	CMH	MDK	Preliminary Issue for Comment

**BRINGING IDEAS TO LIFE**

**FRANKHAM**

Frankham Consultancy Group Limited  
 21 Plympton Road  
 Haywards Heath, RH16 3TP  
 t 01444 444000 f 01444 455642  
 enquiry@frankham.com  
 www.frankham.com

Client  
**St George's Healthcare NHS Trust**

Project Title  
 General Intensive Care Unit Extension  
 St. James Wing  
 St. Georges Hospital  
 London

Drawing Title  
 Proposed  
 Second Floor  
 Fitted Furniture & Equipment Plan  
 South West Quadrant

Drawn by: RKC	Scale: 1:50@A1	Date: 28.11.13
Designed by: FCG	Checked by: MDK	Approved by: AGC

File Ref.: X:\FRANKHAM\2\0801111\02\ARCH\100-04\101717-A-192-03-DWG - 20081700001	20.06.12:16:31:13
Drawing No. 521717-A-192-3	Rev. P2

NB: All information based on supplied third party survey information. All discrepancies to be reported to FCG immediately upon discovery.

All Mechanical & Electrical and Structural information shown indicative only. Please refer to Mechanical & Electrical and Structural documentation.