

NB: All levels are approximate and are subject to further site investigation prior to construction. All discrepancies to be reported to FCG immediately

NOTES: Do not scale this drawing. All dimensions to be checked on site prior to commencement or manufacture.
Key Plan (nts)

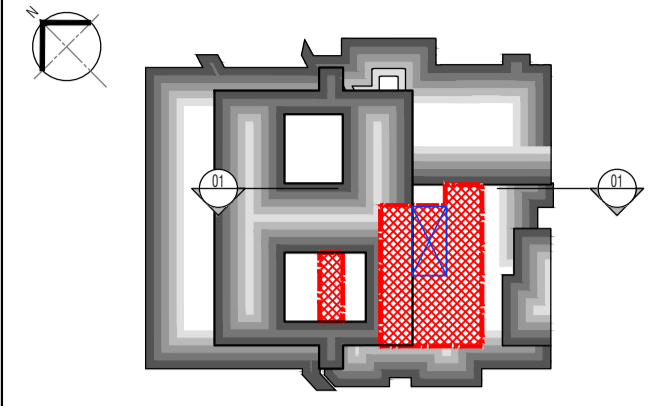

**BUILDING
REGS ISSUE**

All details referenced in call outs supersede general arrangement or larger depictions.

Rev	Date	By	CHK	Comment
P2	24.03.14	RKC	AJM	Issued for Building Regulations Approval
P1	21.01.14	RKC	AGC	Preliminary Issue for Information

BRINGING IDEAS TO LIFE



FRANKHAM

Frankham Consultancy Group Limited
21 Parnymount Road
Haywards Heath RH16 3TP
t 01444 444900 f 01444 455642
enquire@frankham.com
www.frankham.com

Client
St George's Healthcare NHS Trust

Project Title
General Intensive Care Unit Extension
St. James Wing
St. Georges Hospital
London

Drawing Title
Proposed
Section 04
Demolition and Builders Works

Drawn by: RKC	Scale: 1:50@A1	Date: 03.10.13
Designed by: FCG	Checked by: MDK	Approved by: AGC

File Ref.: X:\FRANKHAM\2-2085\011717\02\ARCH\0306-001-521717-A-218.dwg 20.06.12:16:37:46

Drawing No.
521717-A-218

Rev.
P2

01 Proposed Secio 04 Demolition & Builders Works
Scale: 1:50

NB: All information based on supplied third party survey information. All discrepancies to be reported to FCG immediately upon discovery.

All Mechanical & Electrical and Structural information shown indicative only. Please refer to Mechanical & Electrical and Structural documentation.