

NOTES: Do not scale this drawing. All dimensions to be checked on site prior to commencement or manufacture.  
Key Plan (mts)

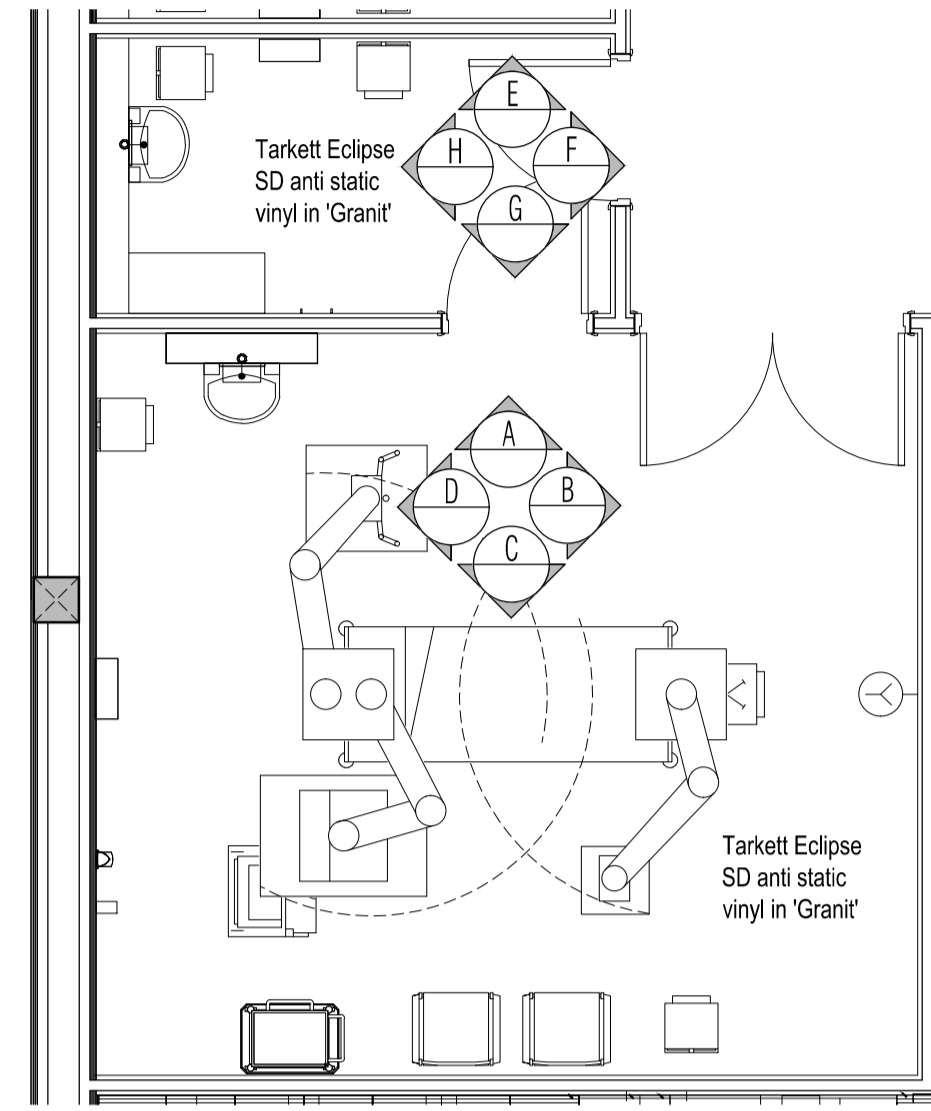

01 1.959a & 1.961a Isolation Room & Lobby  
Scale: 1:50

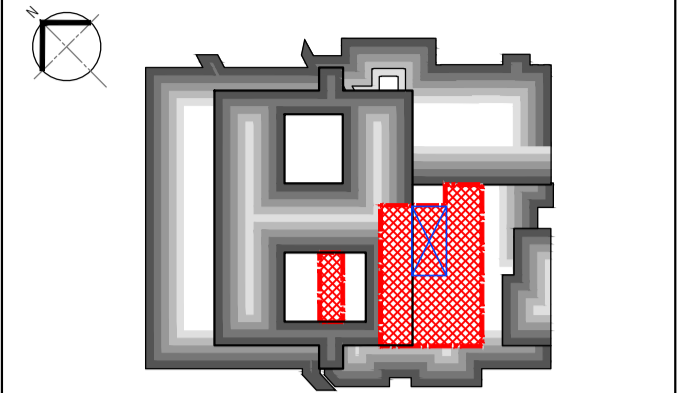
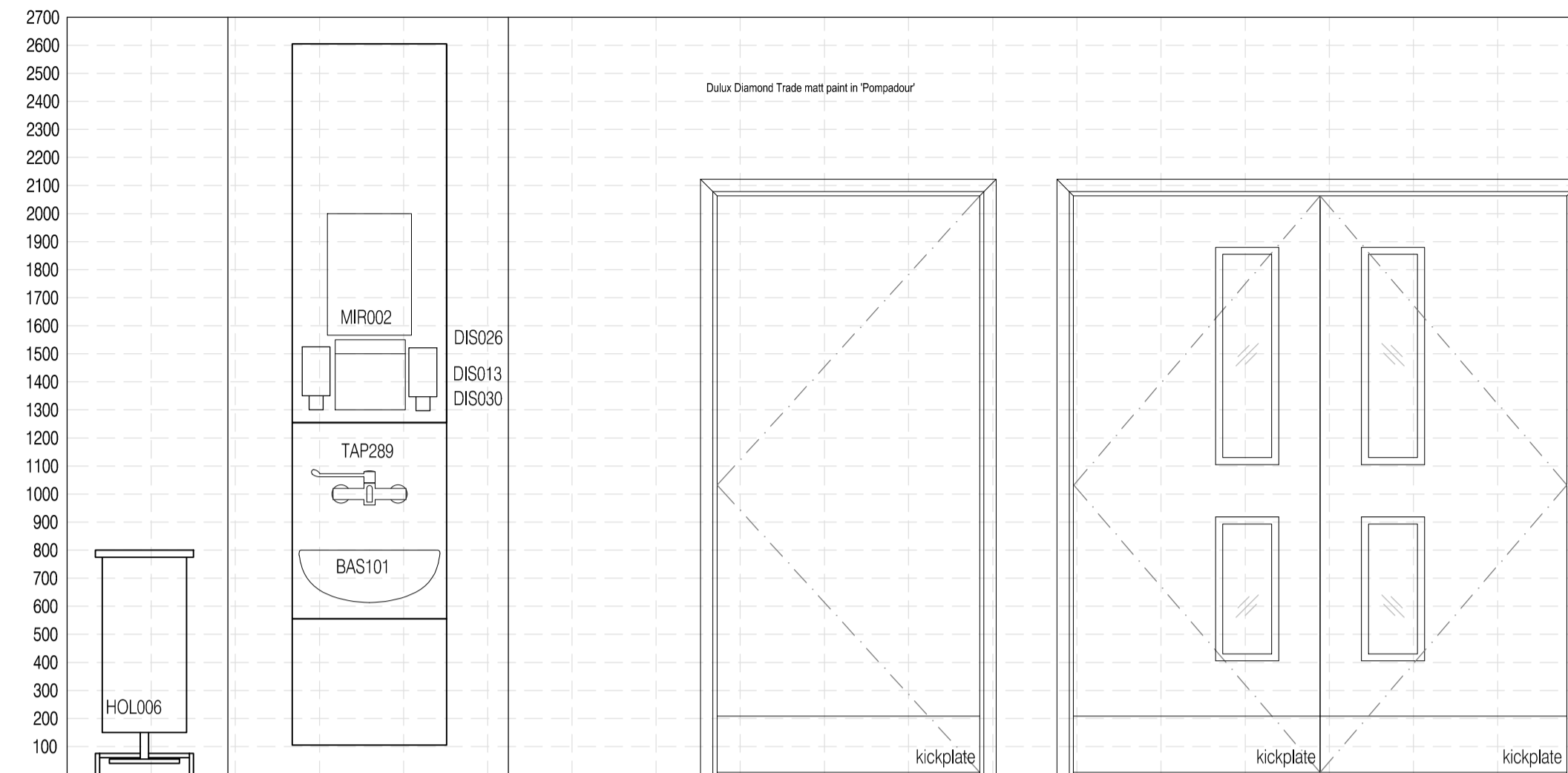

02 Elevation A  
Scale: 1:20

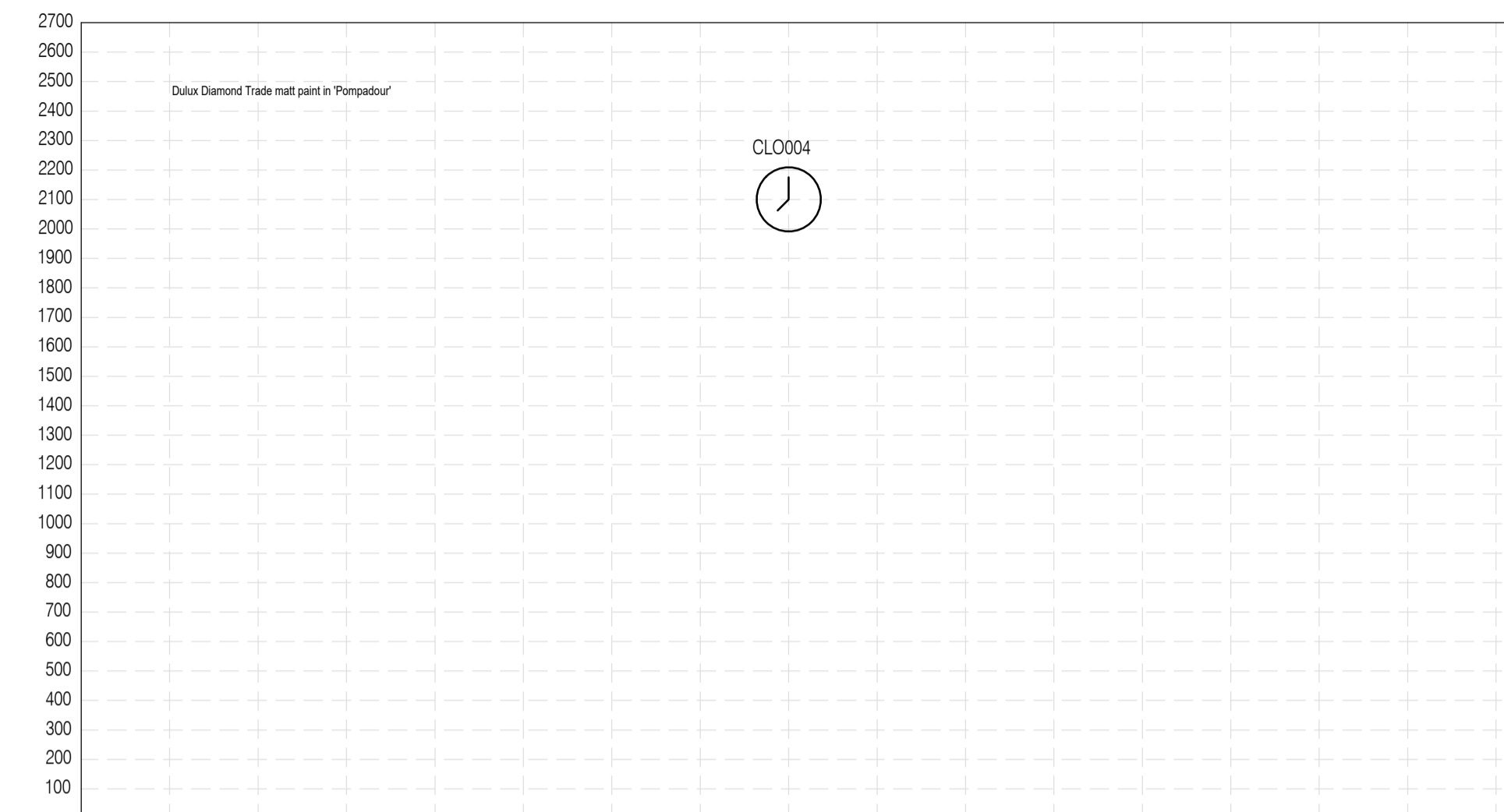

03 Elevation B  
Scale: 1:20

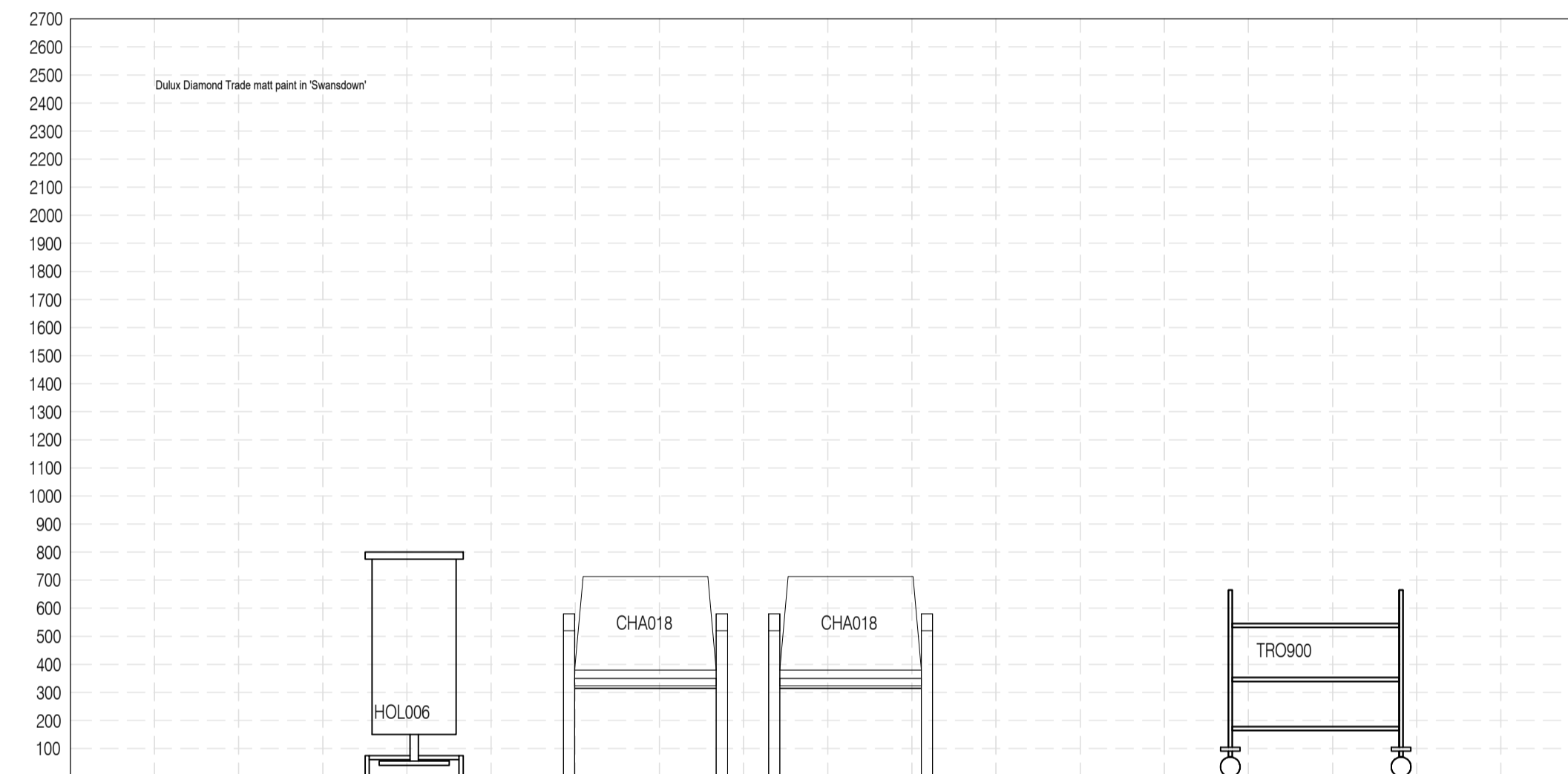

04 Elevation C  
Scale: 1:20

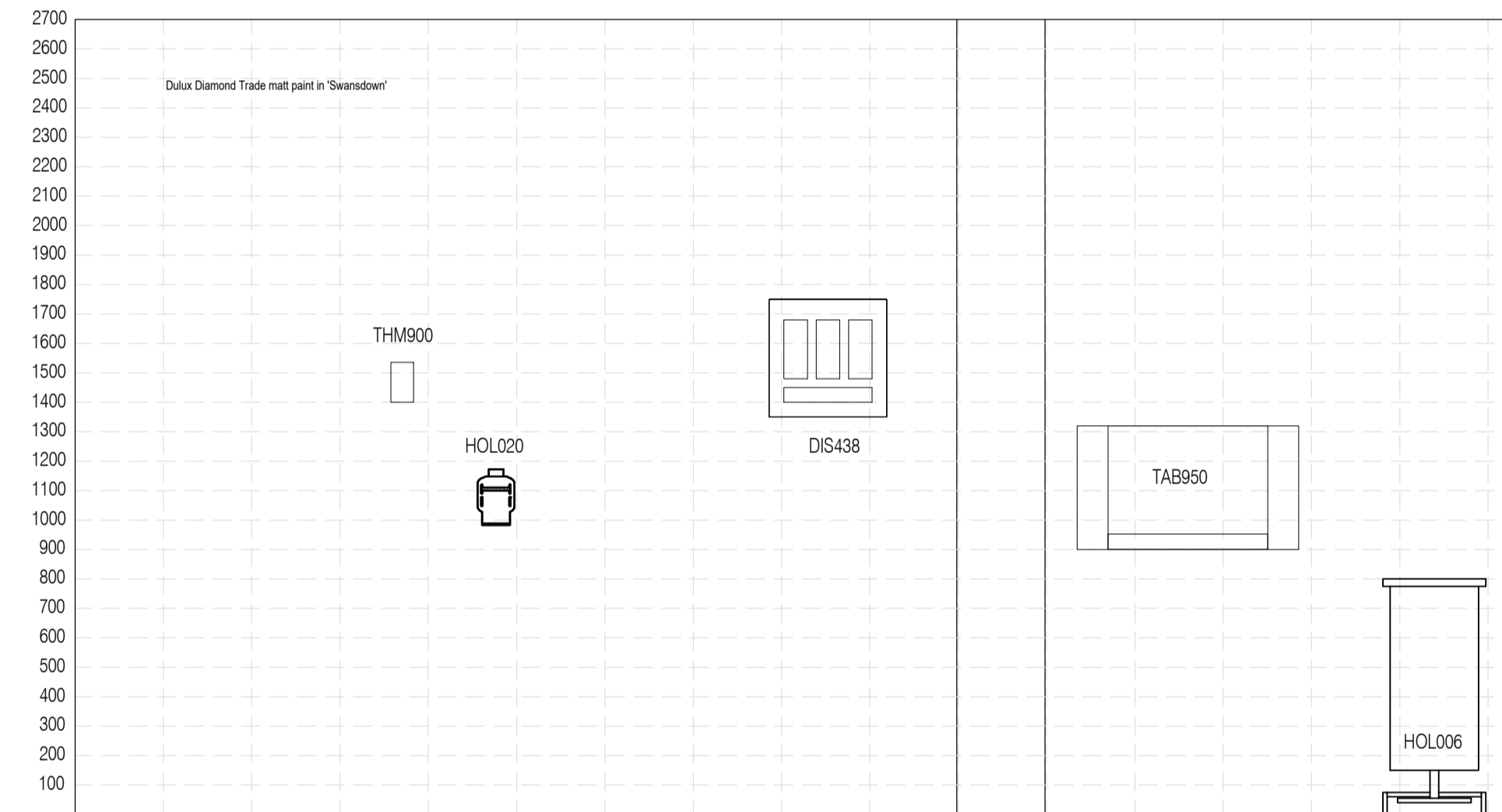

05 Elevation D  
Scale: 1:20

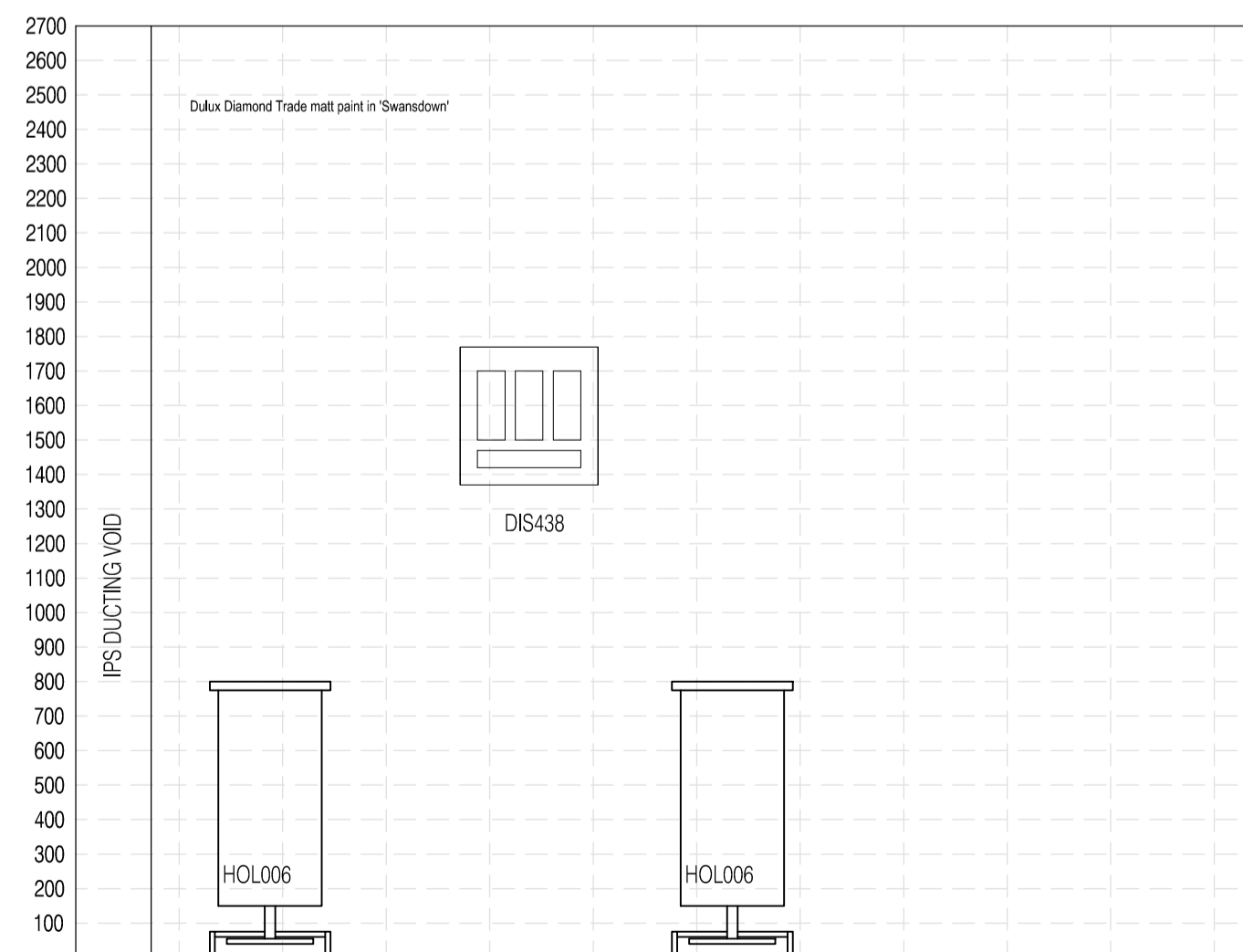

06 Elevation E  
Scale: 1:50

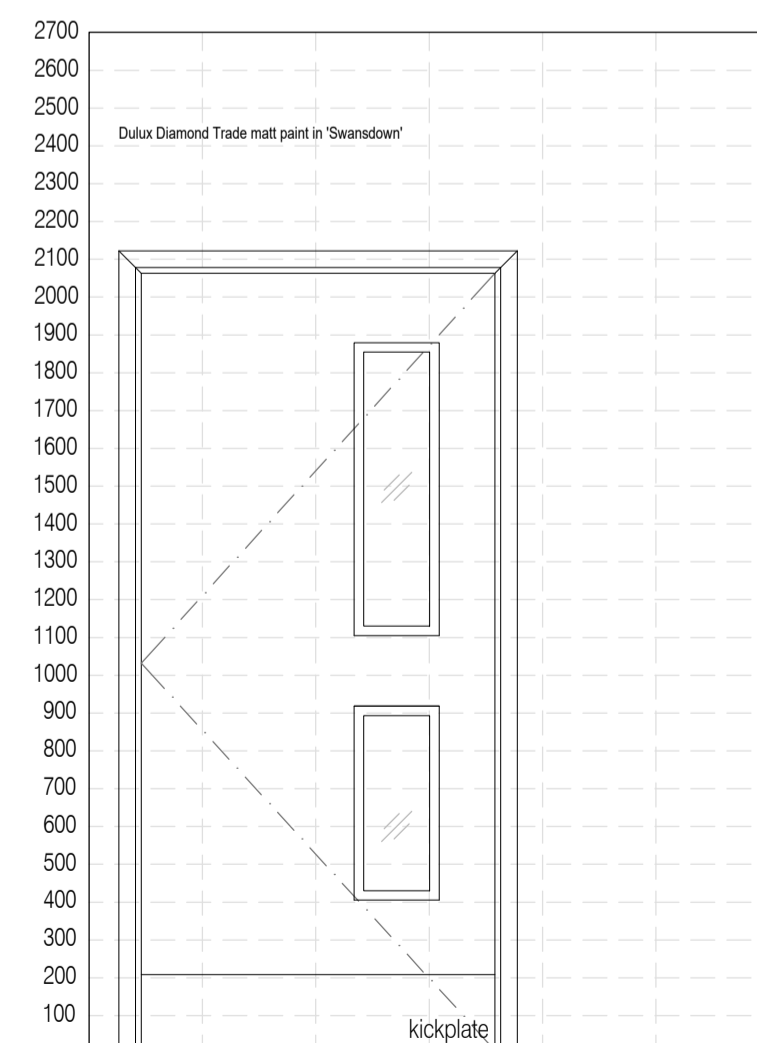

07 Elevation F  
Scale: 1:50

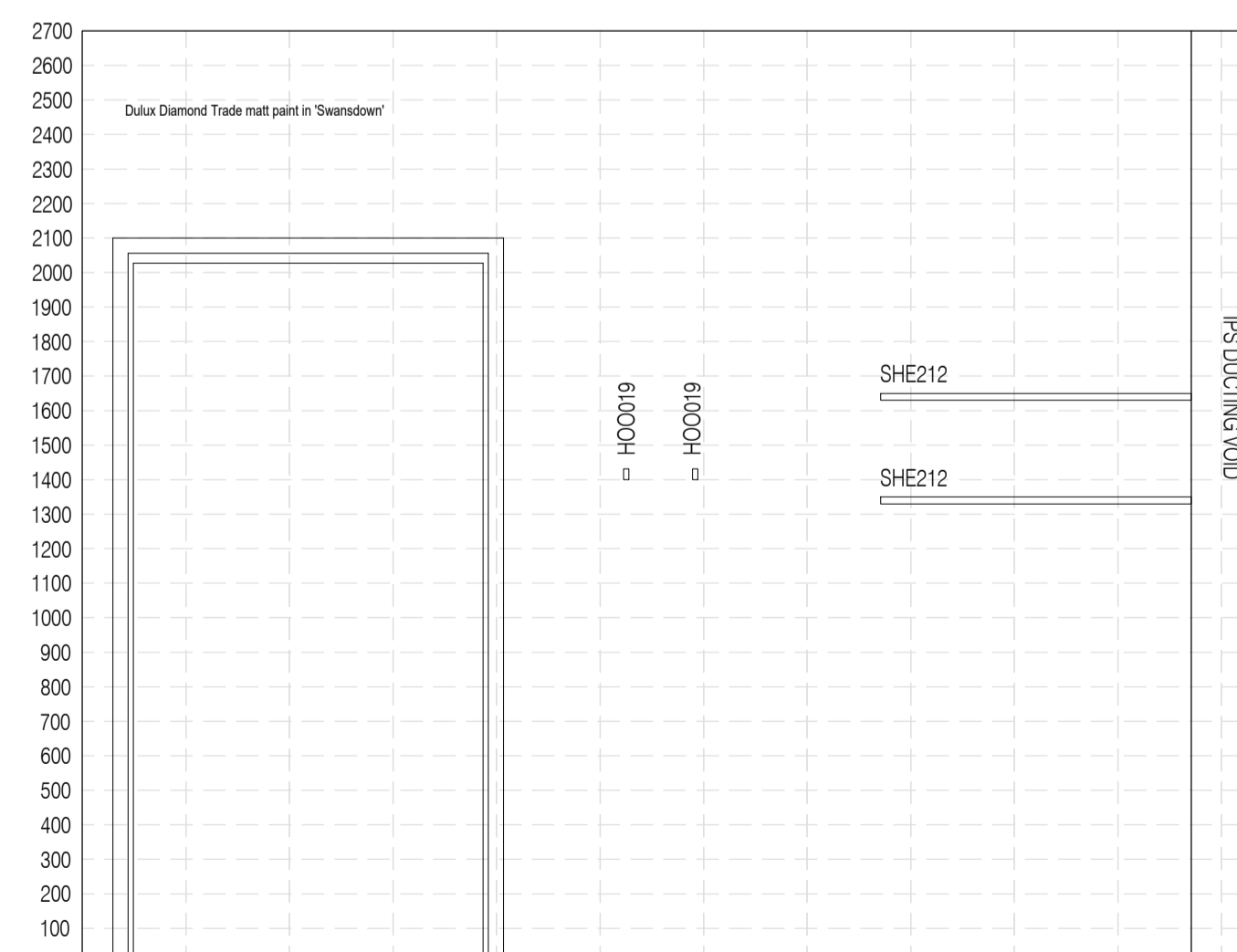

08 Elevation G  
Scale: 1:50

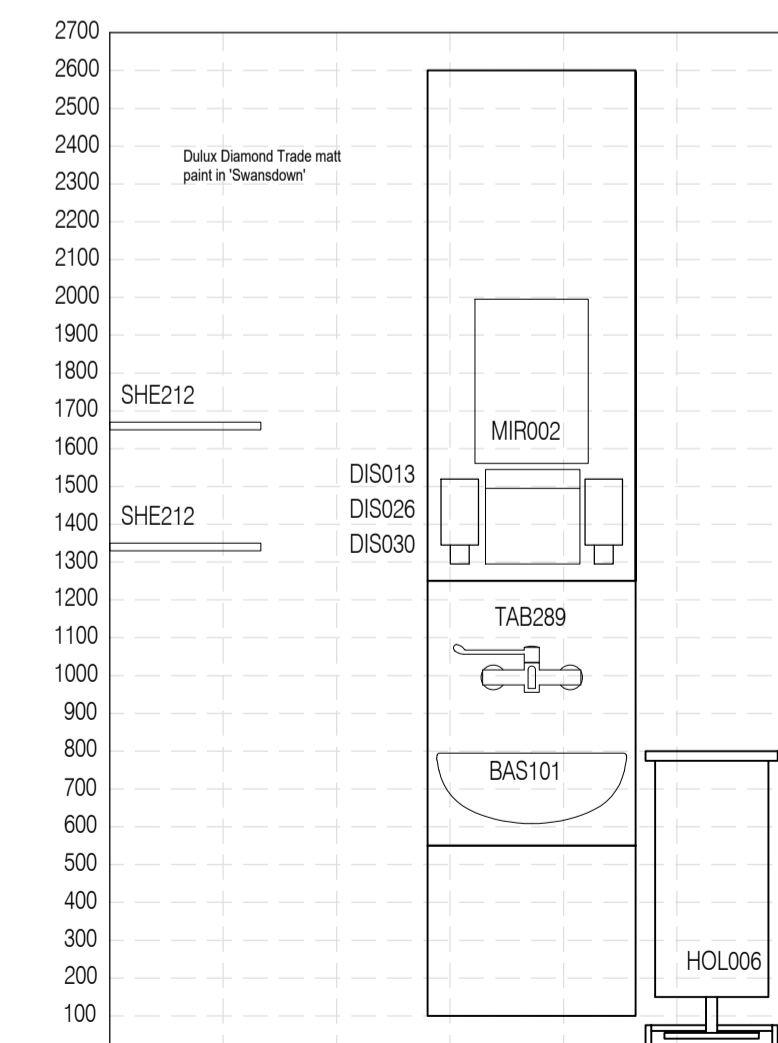

09 Elevation H  
Scale: 1:50

APPROVAL  
ISSUE

Rev	Date	By	CHK	Comment
P2	12.06.20	RKC	AJM	Amended following client comments
P1	09.01.14	RKC	AGC	Preliminary Issue for Approval

BRINGING IDEAS TO LIFE

**FRANKHAM**

Frankham Consultancy Group Limited  
21 Perrymount Road  
Haywards Heath RH18 3TP  
t 01444 444900 f 01444 455642  
enquiries@frankham.com  
www.frankham.com

Client  
**St George's Healthcare NHS Trust**

Project Title  
General Intensive Care Unit Extension  
St. James Wing  
St. Georges Hospital  
London

Drawing Title  
1.959a & 1.961a  
Isolation Room 3 and Lobby 3  
Proposed Room Elevations

Drawn by: RKC	Scale: 1:20, 1:50@A1	Date: 05.12.13
Designed by: FCG	Checked by: MDK	Approved by: AGC

File Ref.: X:\FRANKHAM\2-2013\1111\02\04\03\00-05.DWG 20.06.12:17:49:01

Drawing No. 521717-A-337	Rev. 12.06.20
-----------------------------	------------------