

NB: All levels are approximate and are subject to further site investigation prior to construction. All discrepancies to be reported to FCG immediately

NOTES: Do not scale this drawing. All dimensions to be checked on site prior to commencement or manufacture. Key Plan (nts)

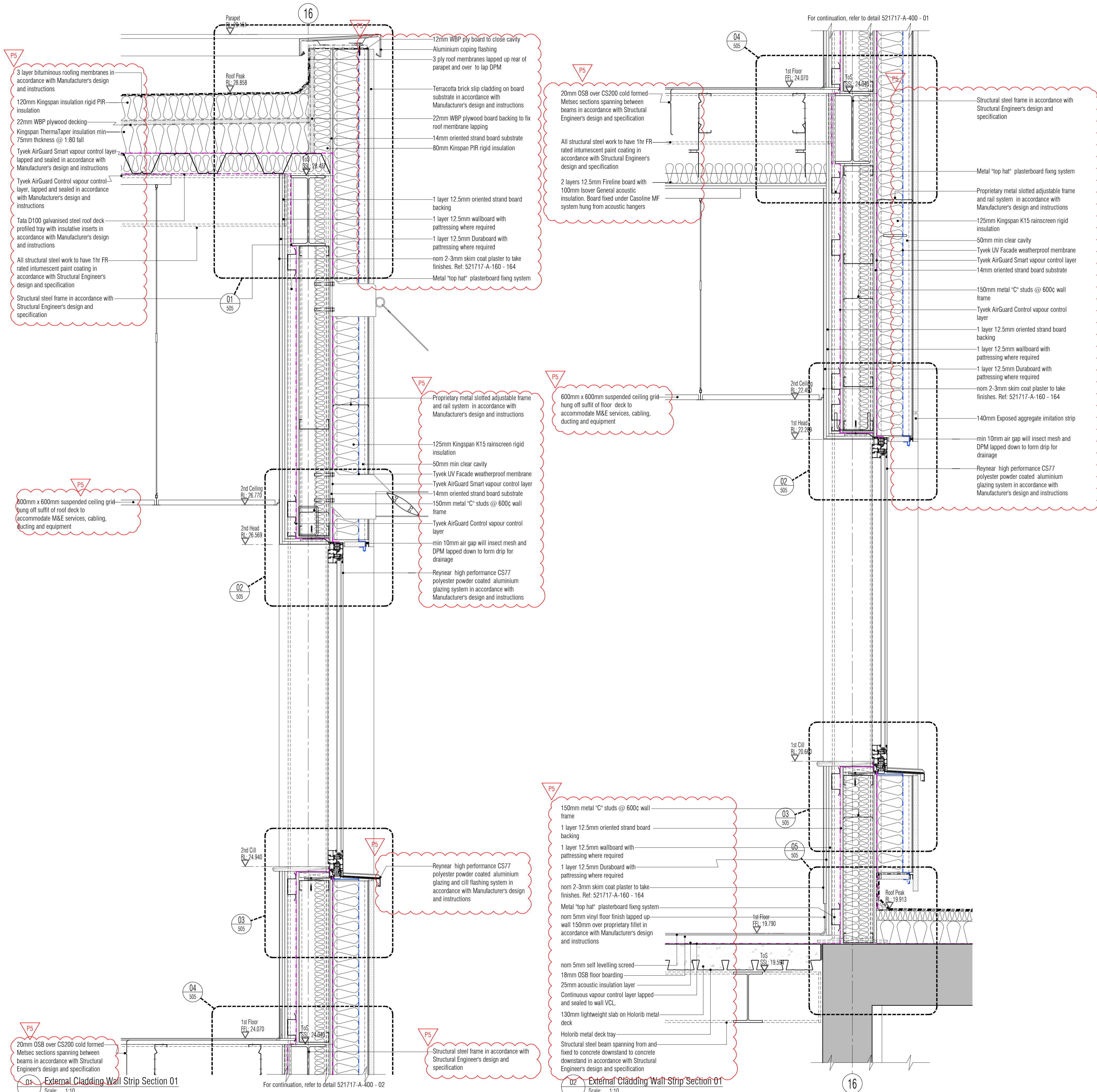
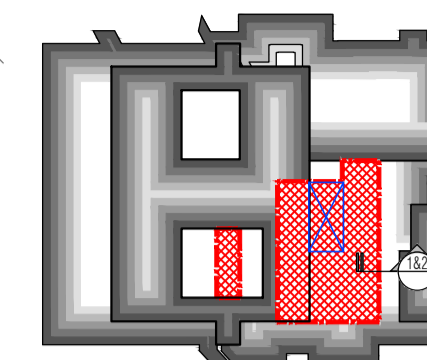

NB: All information based on supplied third party survey information. All discrepancies to be reported to FCG immediately upon discovery.

All Mechanical & Electrical and Structural information shown indicative only. Please refer to Mechanical & Electrical and Structural documentation.

**PRELIMINARY ISSUE**

All details referenced in call outs supercede general arrangement or larger depictions.

Rev	Date	By	CHK	Comment
P5	04.11.14	RKC	AJM	Notes added
P4	24.03.14	RKC	AJM	Issued for Building Regulations Approval
P3	22.11.13	RKC	AJM	Levels added. Gen update
P2	01.11.13	RKC	AJM	Preliminary Issue for Information. Gen update
P1	28.10.13	RKC	AGC	Preliminary Issue for Information

**BRINGING IDEAS TO LIFE**

**FRANKHAM**

Frankham Consultancy Group Limited  
 21 Perrymount Road  
 Haywardes Heath RH16 3TP  
 t 01444 444900 f 01444 455642  
 enquiry@frankham.com  
 www.frankham.com

Client  
**St George's Healthcare NHS Trust**

Project Title  
 General Intensive Care Unit Extension  
 St. James Wing  
 St. Georges Hospital  
 London

Drawing Title  
 External Wall Strip Section 01

Drawn by: RKC	Scale: 1:10@A1	Date: 03.10.13
Designed by: FCG	Checked by: MDK	Approved by: AGC

File Ref: X:\FRANKHAM\2-05012117\02\ARCH\400 STRIPS 20.06.12.18.01.06

Drawing No:  
**521717-A-400**

Rev:  
**P5**