

NB: All levels are approximate and are subject to further site investigation prior to construction. All discrepancies to be reported to FCG immediately

NOTES: Do not scale this drawing. All dimensions to be checked on site prior to commencement or manufacture. Key Plan (nts)

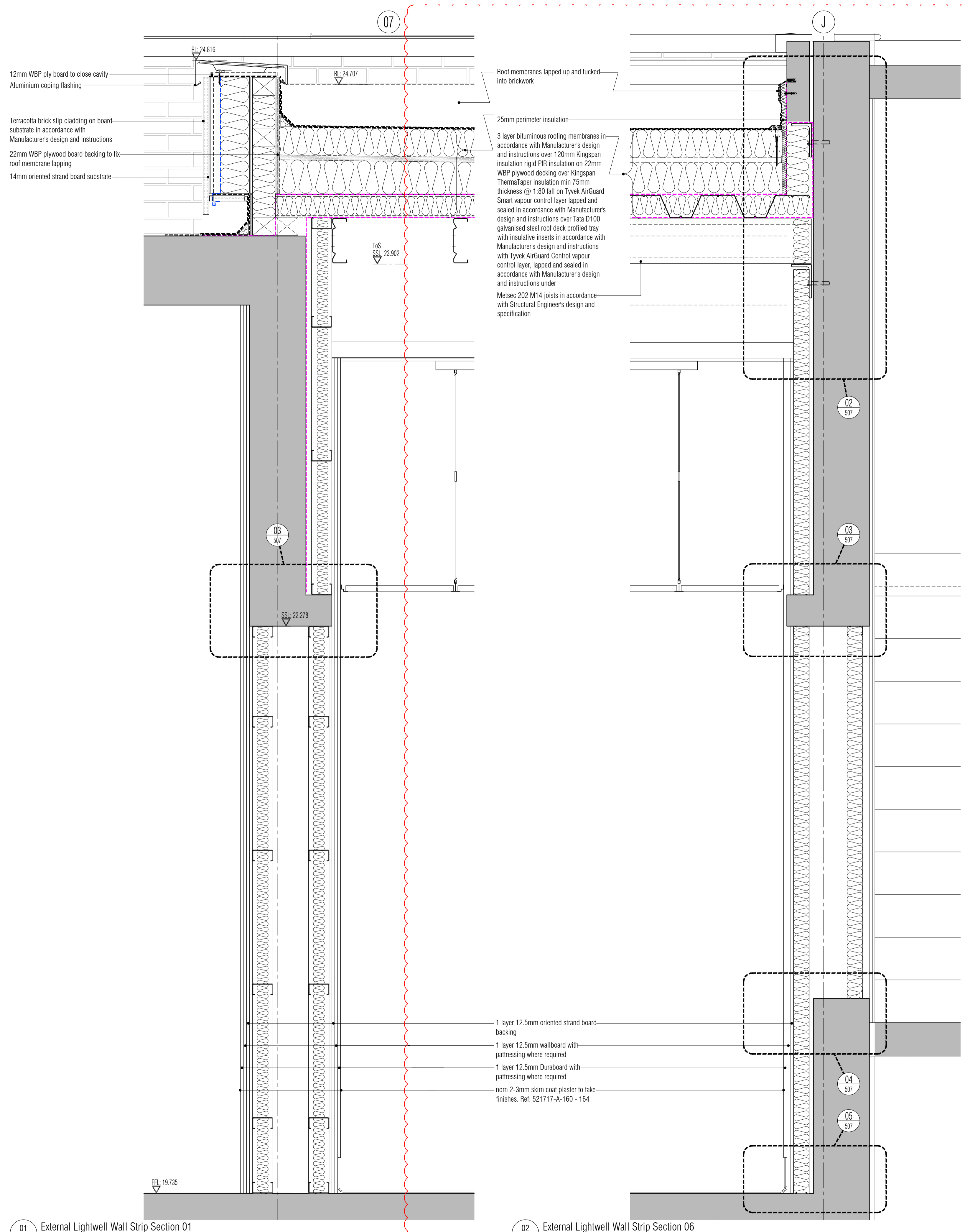
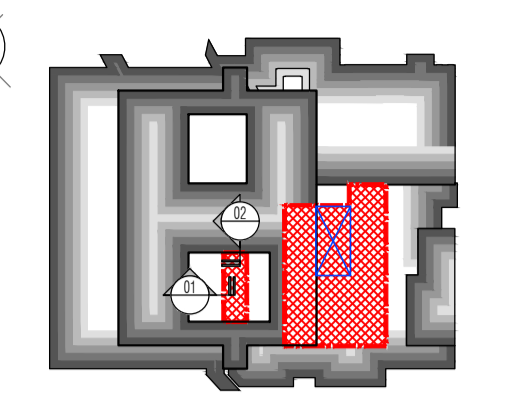

- 12mm WBP ply board to close cavity
- Aluminium coping flashing
- Terracotta brick slip cladding on board substrate in accordance with Manufacturer's design and instructions
- 22mm WBP plywood board backing to fix roof membrane lapping
- 14mm oriented strand board substrate

- Roof membranes lapped up and tucked into brickwork
- 25mm perimeter insulation
- 3 layer bituminous roofing membranes in accordance with Manufacturer's design and instructions over 120mm Kingspan insulation rigid PIR insulation on 22mm WBP plywood decking over Kingspan ThermaTaper insulation min 75mm thickness @ 1:80 fall on Tyvek AirGuard Smart vapour control layer lapped and sealed in accordance with Manufacturer's design and instructions over Tata D100 galvanised steel roof deck profiled tray with insulative inserts in accordance with Manufacturer's design and instructions with Tyvek AirGuard Control vapour control layer, lapped and sealed in accordance with Manufacturer's design and instructions under Metsec 202 M14 joists in accordance with Structural Engineer's design and specification

- 1 layer 12.5mm oriented strand board backing
- 1 layer 12.5mm wallboard with patressing where required
- 1 layer 12.5mm Duraboard with patressing where required
- nom 2-3mm skim coat plaster to take finishes. Ref: 521717-A-160 - 164

01 External Lightwell Wall Strip Section 01  
Scale: 1:10

02 External Lightwell Wall Strip Section 06  
Scale: 1:10

NB: All information based on supplied third party survey information. All discrepancies to be reported to FCG immediately upon discovery.

All Mechanical & Electrical and Structural information shown indicative only. Please refer to Mechanical & Electrical and Structural documentation.

**PRELIMINARY ISSUE**

All details referenced in call outs supercede general arrangement or larger depictions.

Rev	Date	By	CHK	Comment
P3	04.11.14	RKC	ADM	Preliminary Issue for Information
P2	24.03.14	RKC	AGC	Issued for Building Regulations Approval
P1	21.01.14	RKC	AGC	Preliminary Issue for Information

**BRINGING IDEAS TO LIFE**

**FRANKHAM**

Frankham Consultancy Group Limited  
21 Parnymount Road  
Haywards Heath RH16 3TP  
t 01444 444900 f 01444 455642  
enquire@frankham.com  
www.frankham.com

Client  
**St George's Healthcare NHS Trust**

Project Title  
General Intensive Care Unit Extension  
St. James Wing  
St. Georges Hospital  
London

Drawing Title  
External  
Wall Lightwell  
Strip  
Section 01 & 06

Drawn by: RKC	Scale: 1:10@A1	Date: 17.12.13
Designed by: FCG	Checked by: MDK	Approved by: AGC

File Ref.: X:\FRANKHAM\2-2013\011717\02\ARCH\400 STRIPS	20.06.12:18.01.30
Drawing No. 521717-A-402	Rev. P3