

NB: All levels are approximate and are subject to further site investigation prior to construction. All discrepancies to be reported to FCG immediately

NOTES: Do not scale this drawing. All dimensions to be checked on site prior to commencement or manufacture.
Key Plan (nts)

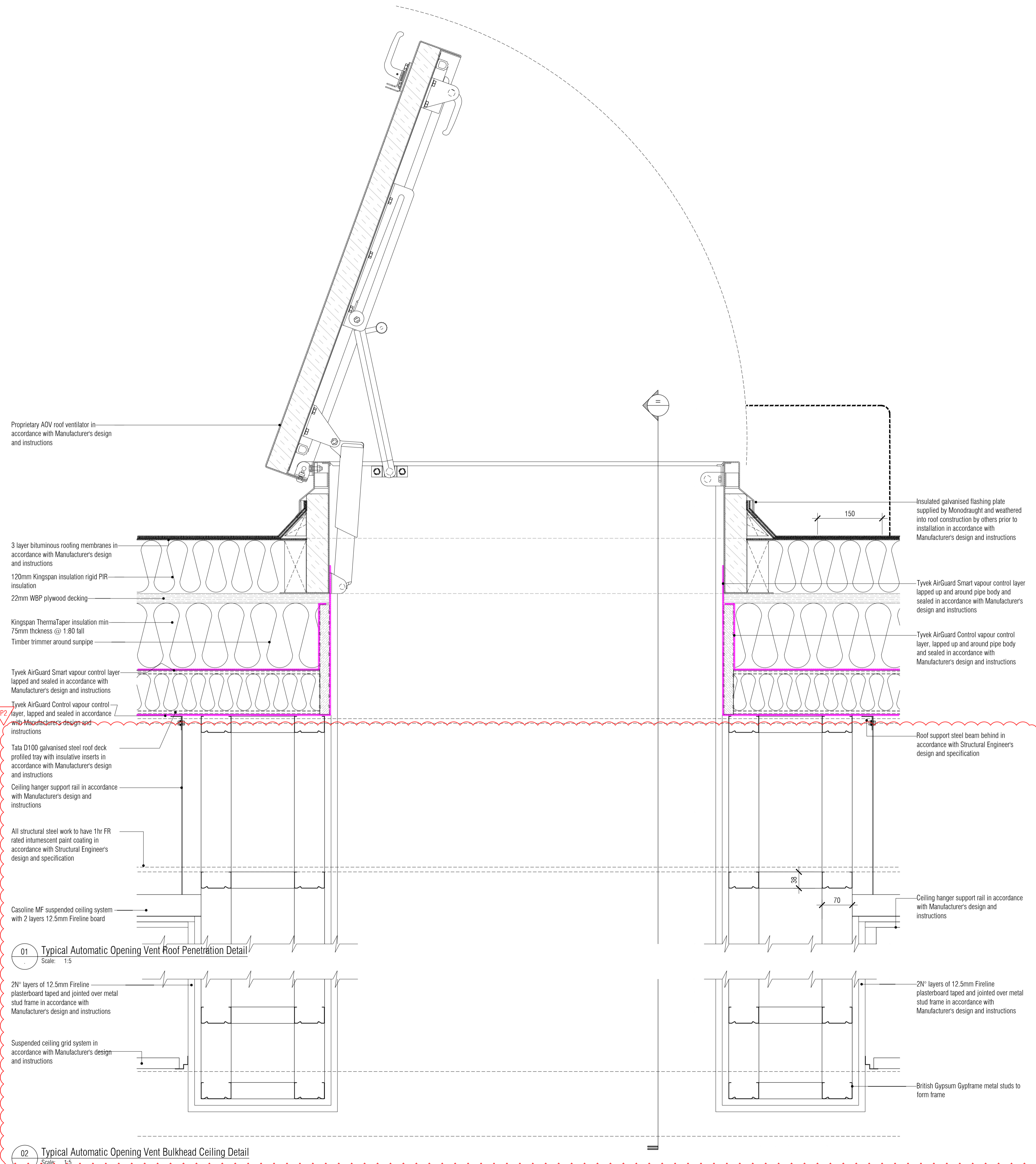
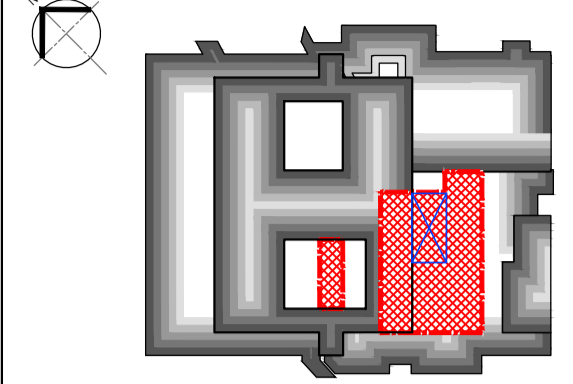

01 Typical Automatic Opening Vent Roof Penetration Detail
Scale: 1:5

02 Typical Automatic Opening Vent Bulkhead Ceiling Detail
Scale: 1:5

NB: All information based on supplied third party survey information. All discrepancies to be reported to FCG immediately upon discovery.

All Mechanical & Electrical and Structural information shown indicative only. Please refer to Mechanical & Electrical and Structural documentation.

PRELIMINARY ISSUE

All details referenced in call outs supersede general arrangement or larger depictions.

Rev	Date	By	CHK	Comment
P2	04.11.14	JM	AGC	Preliminary Issue for Information
P1	21.01.14	JM	AGC	Preliminary Issue for Information

BRINGING IDEAS TO LIFE

FRANKHAM

Frankham Consultancy Group Limited
21 Perrymount Road
Haywards Heath RH16 3TP
t 01444 444000 f 01444 455642
enquire@frankham.com
www.frankham.com

Client
St George's Healthcare NHS Trust

Project Title
General Intensive Care Unit Extension
St. James Wing
St. Georges Hospital
London

Drawing Title
Proposed
Typical Automatic Opening Vent
Roof Penetration with Plasterboard Bulkhead Tunnel
Details

Drawn by: RKC	Scale: 1:5@A1	Date: 09.01.14
Designed by: FCG	Checked by: MDK	Approved by: AGC

File Ref.: X:\FRANKHAM\2-2012\1171717\02\ARCH\000-001-101717-A-530-005 - 20091210032	20.06.15.15.36.43
Drawing No. 521717-A-536	Rev. P2