

NB: All levels are approximate and are subject to further site investigation prior to construction. All discrepancies to be reported to FCG immediately

NOTES: Do not scale this drawing. All dimensions to be checked on site prior to commencement or manufacture.  
Key Plan (nts)

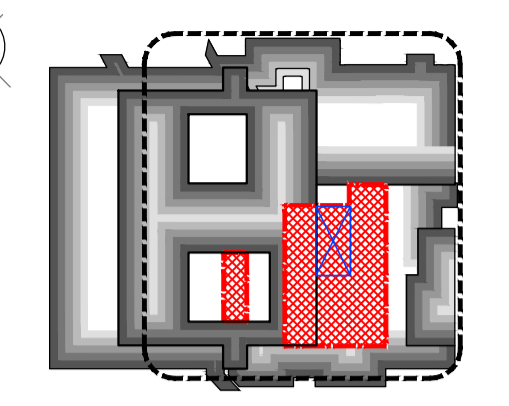

**PRELIMINARY ISSUE**

All details referenced in call outs supersede general arrangement or larger depictions.

Rev	Date	By	CHK	Comment
P1	15.06.20	JM	AGC	Preliminary Issue for Information

**BRINGING IDEAS TO LIFE**



**FRANKHAM**

Frankham Consultancy Group Limited  
 21 Perrymount Road  
 Haywardes Heath RH16 3TP  
 t 01444 444900 f 01444 455642  
 enquiry@frankham.com  
 www.frankham.com

Client  
**St George's Healthcare NHS Trust**

Project Title  
 General Intensive Care Unit Extension  
 St. James Wing  
 St. Georges Hospital  
 London

Drawing Title  
 Existing External Arrangement Plan

Drawn by: RKC	Scale: 1:100@A1	Date: 03.10.13
Designed by: FCG	Checked by: MDK	Approved by: AGC

File Ref.: 521717-A-800-001-001  
 20.06.15.15:39:37

Drawing No.  
**521717-A-800**

NB: All information based on supplied third party survey information. All discrepancies to be reported to FCG immediately upon discovery.

All Mechanical & Electrical and Structural information shown indicative only. Please refer to Mechanical & Electrical and Structural documentation