

NOTES: Do not scale this drawing. All dimensions to be checked on site prior to commencement or manufacture.

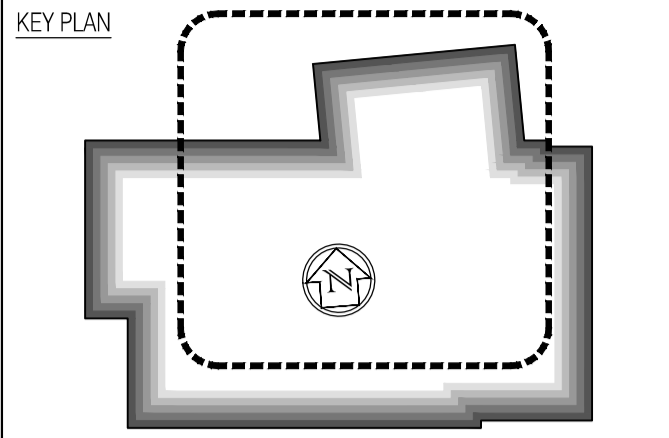

- Suspended Ceiling Types Key**
 NOTE: Where nothing shown assume painted concrete soffit as M60/150A.
- Type A
Corridors Ecophon Focus A
K40/115A
 - Type B
WC/Cleaner's Store Ecophon Hygiene Performance A
K40/120
 - Type C
Classrooms Ecophon Combison Duo A
K40/115B
 - Type D
Plasterboard finish
K10/225
 - Type E
Perforated Plasterboard finish
K10/225A
 - Type F
Pressed metal trim to under-side of suspended external walls
H72/480
 - Type G
Insulated soffit-liner to external under-crofts
K10/246

ISSUED FOR CONSTRUCTION

Rev	Date	By	Clk	Comment
B	11.10.10	RKC	CJ	Apollo Issue - Final Coordination by Apollo
A	17.08.10	RKC	CJ	Gen update

BRINGING IDEAS TO LIFE

FRANKHAM

Frankham Consultancy Group Limited
 21 Parnmount Road
 Haywards Heath, RH16 3TP
 t 01444 444900 f 01444 455642
 enquiry@frankham.com
 www.frankham.com

Client

Project Title

Woodside
Inclusive Learning Campus

Drawing Title

Reflected Ceiling Plan
Ground Floor
Block W

Drawn by: RKC	Scale: 1:50@A1	Date: 03.06.10
Designed by: FCG	Checked by: CJ	Approved by: AC

File Ref.: 0100000208-4002020208-0004 WHICH REL. LOCATION AND NO. 14.04.23.14.16.15
 222586-AW-112-REV-B-14.04.23.14.16.15

Drawing No. 222586-AW-112	Rev. B
-------------------------------------	------------------

For continuation, refer to dwg: 222586-AW-111