

NOTES: Do not scale this drawing. All dimensions to be checked on site prior to commencement or manufacture.

KEY PLAN

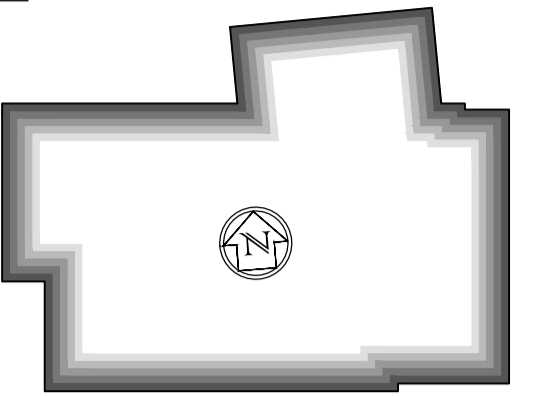

Floor Finishes Legend

- Denotes no new covering or no treatment or finished concrete surface
- Denotes entrance matting M50/130a
- Denotes non slip vinyl safety floor with covered skirting M50/155
- Denotes terrazzo M41/120a and 150a (staircases)
- Denotes painted screed M60/150
- Denotes carpet tiling M50/130
- Denotes inoleum finish M50/150

NOTE: Flush thresholds are required throughout campus. Allow for reduced screed or lowered slab locally to accommodate varying depths of flooring.
For floor transition details, refer to floor interface details drawing

ISSUED FOR CONSTRUCTION

| Rev | Date | By | CHK | Comment |
|-----|----------|-----|-----|---|
| C | 11.10.10 | RKC | CJ | Apollo Issue - Final Coordination by Apollo |
| B | 17.08.10 | RKC | CJ | General revisions |
| A | 03.08.10 | RKC | CJ | Legend revid, Det refs added. |

BRINGING IDEAS TO LIFE



FRANKHAM

Frankham Consultancy Group Limited
21 Parramount Road
Haywards Heath RH18 3TP
t 01444 444900 f 01444 455642
enquiries@frankham.com
www.frankham.com

Client

Project Title
Woodside
Inclusive Learning Campus

Drawing Title
Floor Finishes Plan
Ground Floor
Block W

| | | |
|---------------------|-------------------|--------------------|
| Drawn by: RKC | Scale: NTS@A1 | Date: 03.06.10 |
| Designed by: FCG | Checked by: CJ | Approved by: AC |

File Ref.: 0225586-AW-0001 (BLOCK W) FLOOR FINISHES PLAN AND GA
2225586-AW-03.06.10 - REV C (14/02/14) 14/02/14 14:16:41

| | |
|------------------------------|-----------|
| Drawing No. 222586-AW-120 | Rev. C |
|------------------------------|-----------|

