

NOTES: Do not scale this drawing. All dimensions to be checked on site prior to commencement or manufacture.

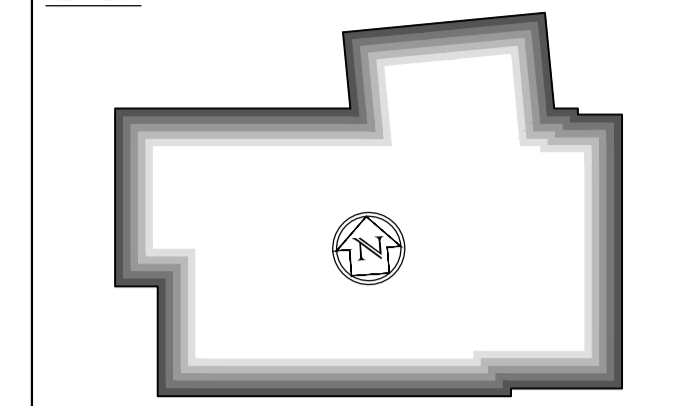

- General Notes**
- All secondary steel to be in accordance with Manufacturer's design, details and specification.
 - All concrete / steelwork shown indicative sizes / locations only.
 - All concrete / steelwork to be confirmed by Structural Engineer.
 - All structural information generally to be in accordance with Structural Engineer's design, details and specification.
 - All mechanical, electrical, plumbing and ventilation information to be in accordance with Mechanical and Electrical Engineer's design, details and specification.
 - Some insulation omitted for clarity. Refer to partition detail drawings for details.
 - Roof Mansafe System is required and shall be the responsibility of the Roofing Contractor. System to be installed in accordance with Manufacturer's design and specifications.

ISSUED FOR CONSTRUCTION

Rev	Date	By	Chk	Comment
C	11.10.10	RKC	CJ	Apollo Issue - Final Coordination by Apollo
B	17.08.10	RKC	CJ	General revisions
A	02.08.10	RKC	CJ	Issued for Building Regulation Approval

BRINGING IDEAS TO LIFE

FRANKHAM

Frankham Consultancy Group Limited
 21 Pennymount Road
 Hayward Heath RH16 3TP
 t 01444 444900 f 01444 455642
 enquiry@frankham.com
 www.frankham.com

Client	
Project Title	Woodside Inclusive Learning Campus
Drawing Title	Builders Works Plans Ground Floor Plan Block W

Drawn by: RKC	Scale: N. T. S. @ A1	Date: 06.07.10
Designed by: FCG	Checked by: CJ	Approved by: AC
File Ref.: 0208030266-WOODSIDE-Block W-ARCH-RL-REGULATORY-PLANS-REV-GA 222586-AW-135-REV-G-141712		14/04/23 14:17:22
Drawing No. 222586-AW-135	Rev. C	