

01 Section 04  
Scale: 1:50

**ISSUED FOR CONSTRUCTION**

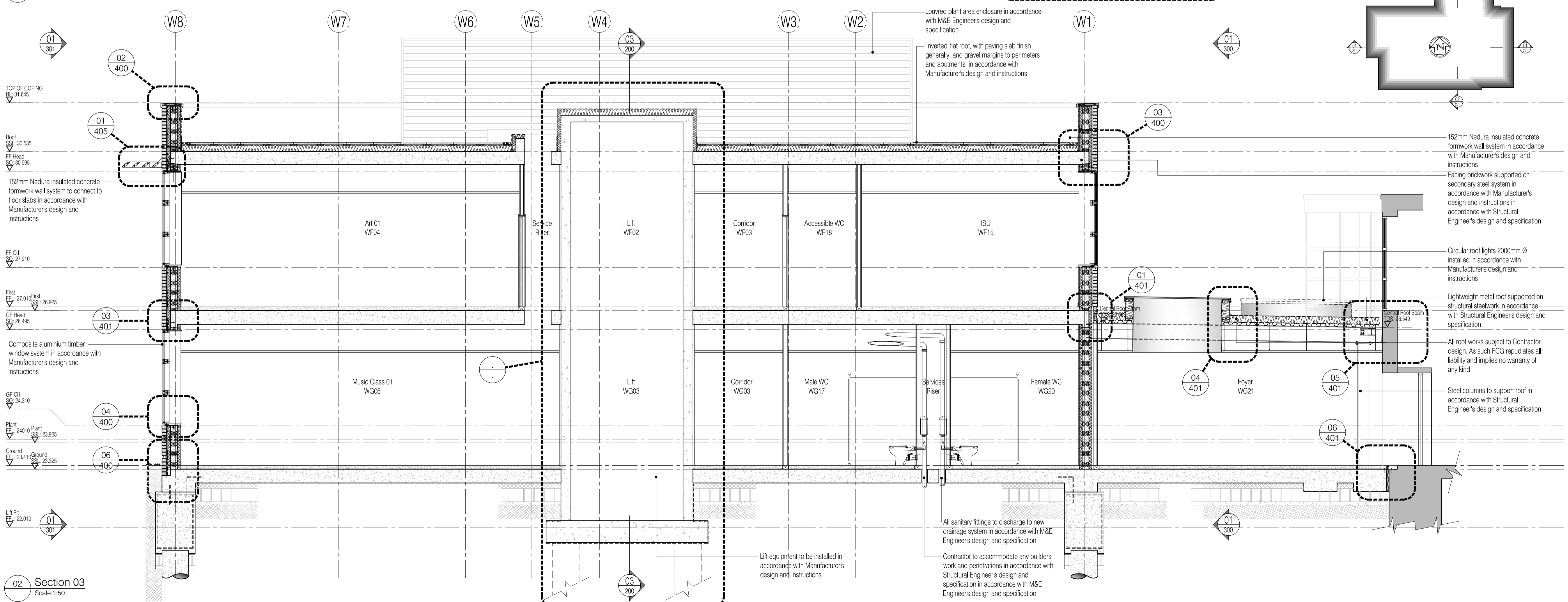

02 Section 03  
Scale: 1:50

Rev	Date	By	Clk	Comment
D	11.10.10	RKC	CJ	Apollo Issue - Final Coordination by Apollo
C	06.09.10	RKC	CJ	General revisions
B	17.08.10	RKC	CJ	General revisions
A	02.08.10	RKC	CJ	Issued for Building Regulation Approval

**BRINGING IDEAS TO LIFE**

**FRANKHAM**

Frankham Consultancy Group Limited  
 21 Pennymount Road  
 Haywards Heath RH16 3TP  
 t 01444 444900 f 01444 455642  
 enquiry@frankham.com  
 www.frankham.com

Client:

Project Title:  
 Woodside  
 Inclusive Learning Campus

Drawing Title:  
 General Arrangement  
 Sections 04 & 03  
 Block W

Drawn by: RKC	Scale: 1:50@A1	Date: 21.06.10
Designed by: FCG	Checked by: CJ	Approved by: AC

File Ref.: 0100002586-AW02586-SECTION 04 & 03-SECTION 03	14/04/23 14:19:13
Drawing No. 222586-AW-201	Rev. D