

NOTES: Do not scale this drawing. All dimensions to be checked on site prior to commencement or manufacture.

KEY PLAN

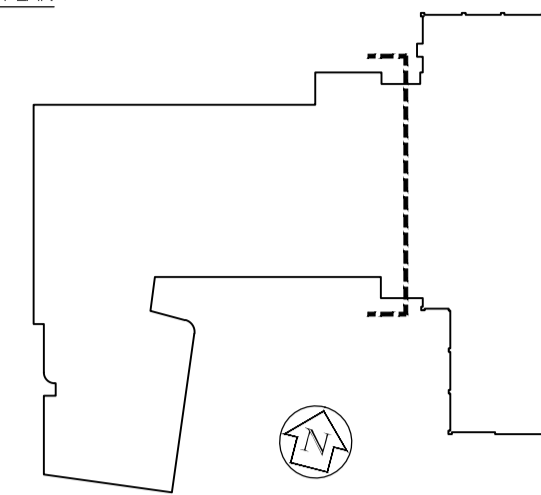

- General Notes**
- All concrete/steelwork to be confirmed by Structural Engineer.
 - All concrete/steelwork shown indicative of sizes and locations only.
 - All structural information to be in strict accordance with the Structural Engineer's design, details and specification.
 - All mechanical, electrical, plumbing and ventilation information to be in strict accordance with the Mechanical and Electrical Engineer's design, details and specification.

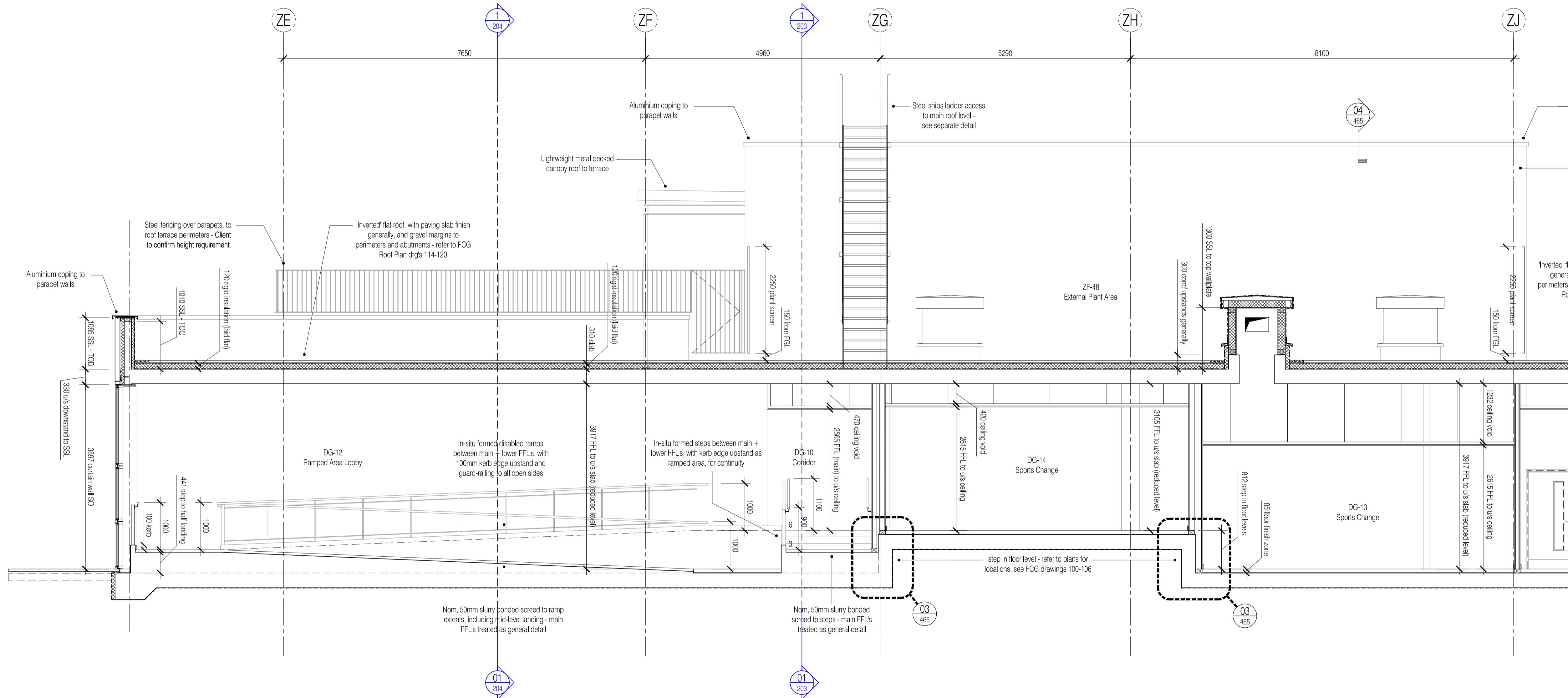

For continuation, please refer to DWG 222586-AZ-214

ISSUED FOR CONSTRUCTION

Rev	Date	By	CHK	Comment
03	19.11.10	RKC	CJ	Refs added as part of partition package
02	11.10.10	RKC	CJ	Apollo Issue - Final Coordination by Apollo
01	08.06.10	JAS	CJ	Nudura ICF walls / inverted roofs / slab fins

BRINGING IDEAS TO LIFE

FRANKHAM



Frankham Consultancy Group Limited
21 Perrymount Road
Haywards Heath RH16 3TP
t 01444 444900 f 01444 455642
enquiries@frankham.com
www.frankham.com

Client
APOLLO EDUCATION

Project Title
Woodside
Inclusive Learning Campus

Drawing Title
General Arrangement Section
Section 11 (Facing Grid-line Z9) Part 1 of 2
Block Z

Drawn by: RKC	Scale: 1:50@A1	Date: 14.04.10
Designed by: FCG	Checked by: CJ	Approved by: AC

File Ref.: C:\026022286-40026028\BLOC\222586-AZ-214_SECTION11	14.04.23.15:12.33
Drawing No. 222586-AZ-213	Rev. 03