

NOTES: Do not scale this drawing. All dimensions to be checked on site prior to commencement or manufacture.

KEY PLAN

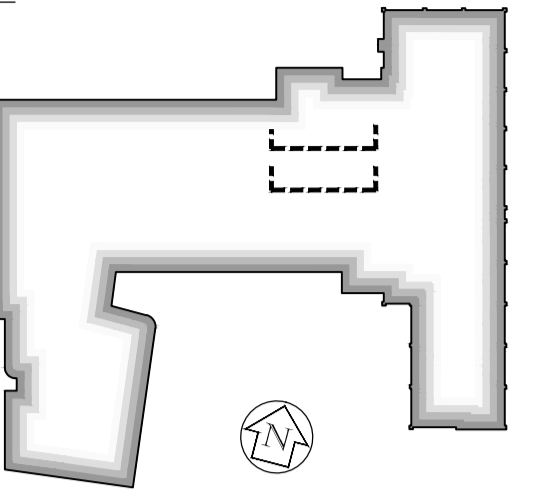

- General Notes**
- All concrete/steel frame elements are shown for reference only - All to be in strict accordance with 'Clark Smith Partnership' Structural Engineer's for designs, details and specifications.
  - All general Contractor Design' elements are shown indicative on these drawings; they shall be as designed by the Specialist Sub-contractor, and their designs, details and specifications shall be to the prior approval of the Apollo Construction'. Specific reference should be made to the 'Nudura' Design Specification Manual, for the external envelope ICF wall system.
  - All mechanical, electrical, plumbing, ventilation, air conditioning, etc. are shown for reference only - All to be in strict accordance with 'Imtech Aqua' Mechanical + Electrical Engineer's designs, details and specifications.
  - The Hydrotherapy Pool and its associated plant is shown for reference only - All to be in strict accordance with Rainbow Pools' drawings; and to the prior approval of both the Mechanical + Electrical, and Structural Engineer's.
  - The FF + E layouts have been included for reference only - All to be in strict accordance with 'Eurotek' drawings; and to the prior approval of the Structural Engineer regarding slab loadings.
  - The hoist layouts have been included for reference only - All to be in strict accordance with 'Arjo' drawings; and to the prior approval of both the Structural Engineer and the Acoustic Consultant, regarding slab loadings and transmission of sound; respectively.
  - For Fire Strategy, refer to FCG dwg's 'AZ-160/1'.
  - For Acoustic Strategy, refer to FCG dwg's 'AZ-165/6'.
  - For 'Builder's Work + Drainage', refer to FCG dwg's 'AZ-170/1/2'.
  - For 'Partition Strategy', refer to FCG dwg's 'AZ-180/1/2'.
  - Some insulation omitted for clarity. Refer to FCG detailed drawings - 'AZ-400' series, generally.
  - Denotes major steps in floor slab construction

ISSUED FOR CONSTRUCTION

02	11.10.10	RKC	CJ	Apollo Issue - Final Coordination by Apollo
01	30.07.10	JAS	CJ	Updated as Structural Engineer's details.

Rev. Date By Ck Comment

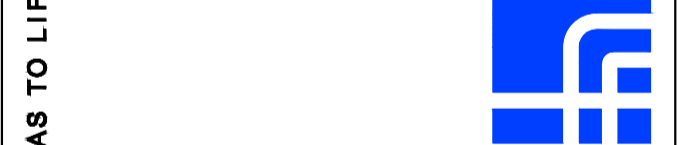

FRANKHAM

Frankham Consultancy Group Limited  
21 Perryman Road  
Haywards Heath RH16 3TP  
t 01444 444900 f 01444 455642  
enquire@frankham.com  
www.frankham.com

Client  
APOLLO EDUCATION

Project Title  
Woodside  
Inclusive Learning Campus

Drawing Title  
'Sports Change' Flooring Details  
(including drainage channel / gully req'ts)  
Block Z

Drawn by: RKC Scale: 1:10 + 1:25 @A1 Date: 16.07.10

Designed by: FCG Checked by: CJ Approved by: AC

File Ref.: 022586-AZ-431

Drawing No. 222586-AZ-431 Rev. 02