

NOTES: Do not scale this drawing. All dimensions to be checked on site prior to commencement or manufacture.  
 NB: All information based on supplied third party survey information. All discrepancies to be reported to FCG immediately upon discovery.

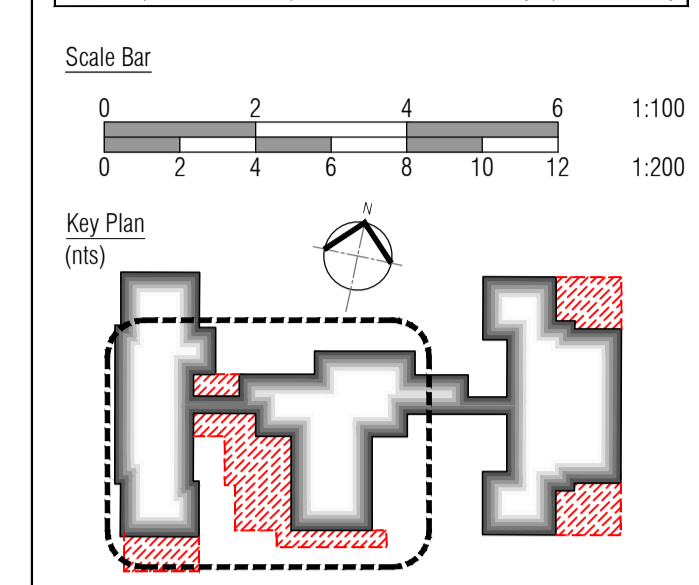

**AS BUILT  
DRAWING**

Rev	Date	By	Clk	Comment
AB1	17.04.14	RKC	AGC	DRAWING ISSUED - AS BUILT



**FRANKHAM**

**Frankham Consultancy Group Limited**  
 Frankham House Wootton Business Park  
 Besselsleigh Road Wootton Abingdon  
 Oxfordshire OX13 6FD  
 T 01865 322500 F 01865 327393  
 E enquiries@frankham.com  
 www.frankham.com

Client: **Leadbitter CONSTRUCTION**

Project Title: Whitehall Junior & Infant School  
 Refurbishment, Extension and New Build  
 Cowley Road  
 London Borough of Hillingdon

Drawing Title: Junior School  
 Proposed Ground Floor  
 Setting Out Plans  
 Sheet 2 of 2

Drawn by: RKC	Scale: 1:50@A1	Date: 31.07.12
Designed by: FCG	Checked by: JAS	Approved by: AC

File Ref: J:\00000188-16100200 SCHOOL - WHITEHALL JUNIOR & INFANT SCHOOL - LOCATION PLANS AND GA  
 14.04.24.10.33.18

Drawing No. <b>611869-A-134</b>	Rev. <b>AB1</b>
------------------------------------	--------------------

01 New Kitchen Extension and WC's Setting Out Plan  
 Scale: 1:50