

NOTES: Do not scale this drawing. All dimensions to be checked on site prior to commencement or manufacture.
 NB: All information based on supplied third party survey information. All discrepancies to be reported to FCG immediately upon discovery.

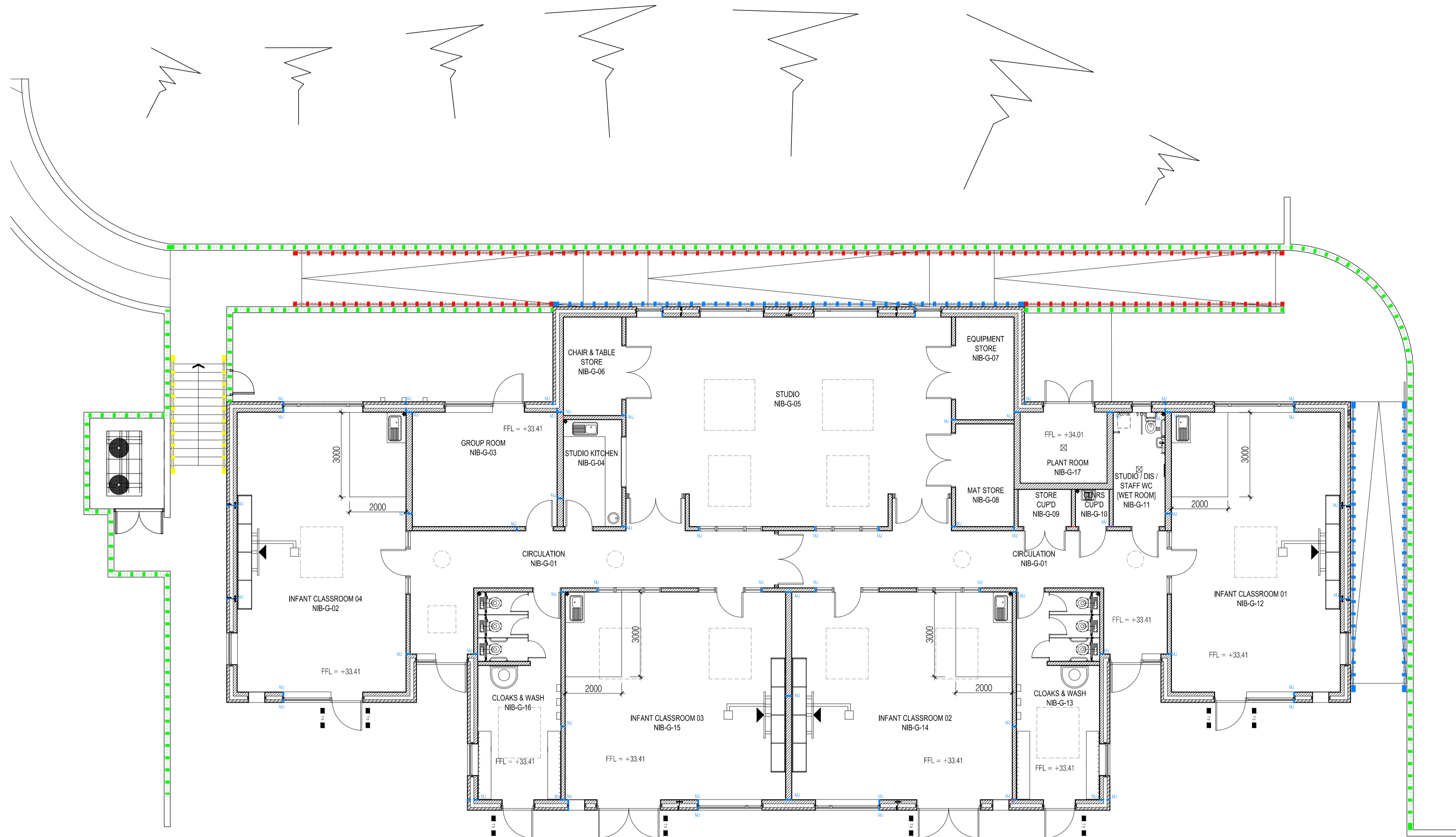

HANDRAIL / BALUSTRADE KEY

- Handrail / Balustrade Detail 1 - PPC Steel Balustrade on top of retaining wall, min. 1100mm high with infill panels between the posts to ensure that a 100mm dia. sphere cannot pass through any part of the guarding - all to comply with Building Regulations Part K. See Typical Elevation - A. Approximate Linear Meterage = 110m
- Handrail / Balustrade Detail 2 - PPC Steel Double Handrails either side of ramp, top handrail 900mm high, fixed to facing brick - heights / lengths etc. all to comply with Building Regulations Part K and Part M. See Typical Elevation - B. Approximate Linear Meterage = 40m
- Handrail / Balustrade Detail 3 - PPC Steel Double Handrails either side of ramp, top handrail 900mm high, bracketed off balustrade (see Detail 1 above) - heights / lengths etc. all to comply with Building Regulations Part K and Part M. See Typical Elevation - C. Approximate Linear Meterage = 55m
- Handrail / Balustrade Detail 4 - PPC Steel Double Handrails either side of stairs, fixed to facing brick - heights / lengths etc. all to comply with Building Regulations Part K and Part M. Approximate Linear Meterage = 10m
- Proprietary PPC Steel Door Protection Hoops

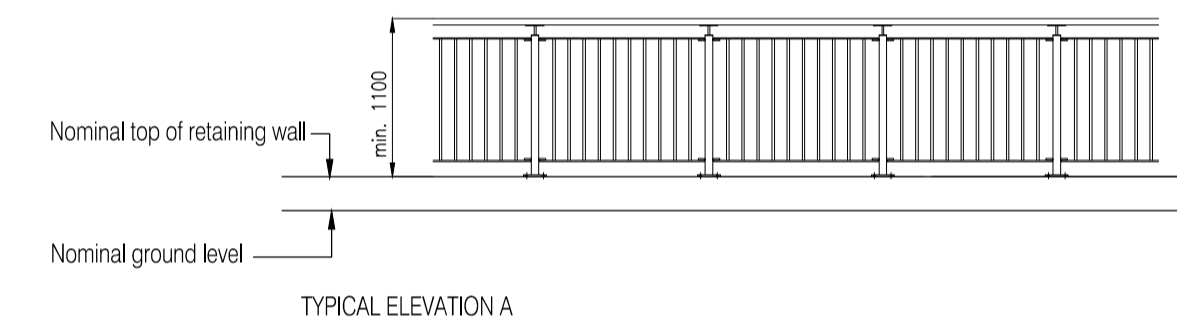

TYPICAL ELEVATION A

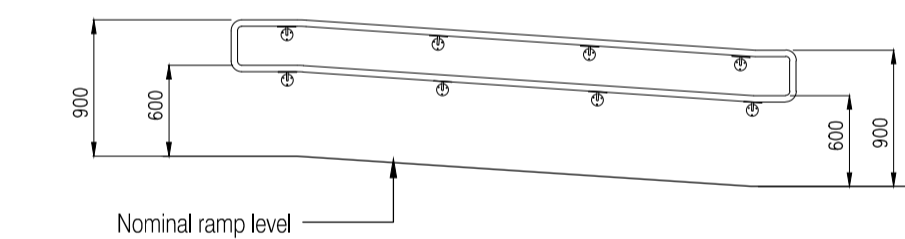

TYPICAL ELEVATION B

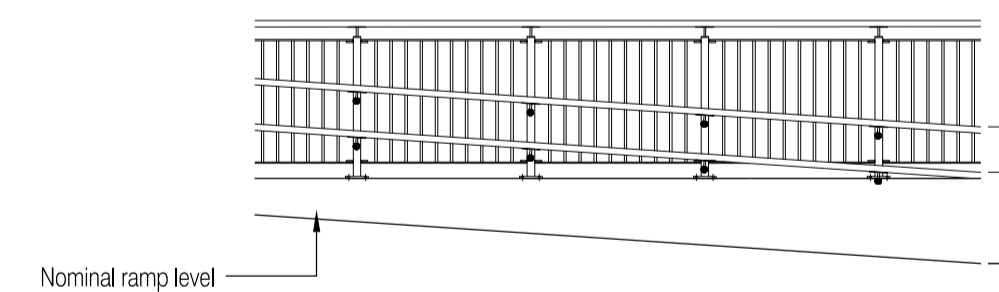

TYPICAL ELEVATION C

ISSUED FOR CONSTRUCTION

Rev	Date	By	Chk	Comment
C2	22.05.13	DOB	JAS	Fire Safety Updates
C1	15.02.13	ES	JAS	Issue for Construction
A2	09.10.12	SC	JAS	Issued for Stage F Approval
A1	17.08.12	SC	JAS	Stage E Issue

25 YEARS OF BRINGING IDEAS TO LIFE



FRANKHAM

Frankham Consultancy Group Limited

Frankham House Wootton Business Park
 Besselsleigh Road Wootton Abingdon
 Oxfordshire OX13 6FD
 T 01865 322500 F 01865 327393
 E enquiries@frankham.com
 www.frankham.com

Client

Leadbitter
CONSTRUCTION

Project Title

Whitehall Junior & Infant School
 Refurbishment, Extension and New Build
 Cowley Road
 London Borough of Hillingdon

Drawing Title

New Infants Block
 External Handrail / Balustrade Detail

Drawn by: RKC	Scale: 1:100/1:50@A1	Date: 17.08.12
Designed by: FCG	Checked by: JAS	Approved by: AC

File Ref: J:\000001\NIB - HILLINGDON SCHOOL - WHITEHALL JUNIOR & INFANT SCHOOL\410_DETALS\EXTERNAL HANDRAIL - (1)180812.DWG - REV:CH-180812

Drawing No. 611869-A-410	Rev. C2
-----------------------------	------------