

01 Typical Sunpipe Section Detail
Scale: 1:5

NBS Ref: H31/128 (EWA)
Element: Profiled coping
Material: PPC aluminium

NBS Ref: H31/127 (EWA)
Element: Profiled eaves
Material: PPC aluminium

NBS Ref: L10/495 (FCG)
Element: Proprietary Sunpipe
Material: Monodraft

NBS Ref: F30/211 (EWA)
Element: Wall ties
Material: Metal with clips

NBS Ref: J42/110 (EWA)
Element: Roof Membrane
Material: Single ply

NBS Ref: P10/149 (FCG)
Element: Flat Roof Insulation
Material: Rigid

NBS Ref: P10/310 (FCG)
Element: Vapour control layer
Material: Tyvek

22mm WBP ply over lay to firring pieces

NBS Ref: F10/113 (FCG)
Element: External wall
Material: Facing brickwork

NBS Ref: F30/155
Element: Cavity insulation
Material: Celotex Ventilation roed

NBS Ref: F10/360 (FCG)
Element: Internal wall
Material: Blockwork

02 Typical Verge Detail
Scale: 1:5

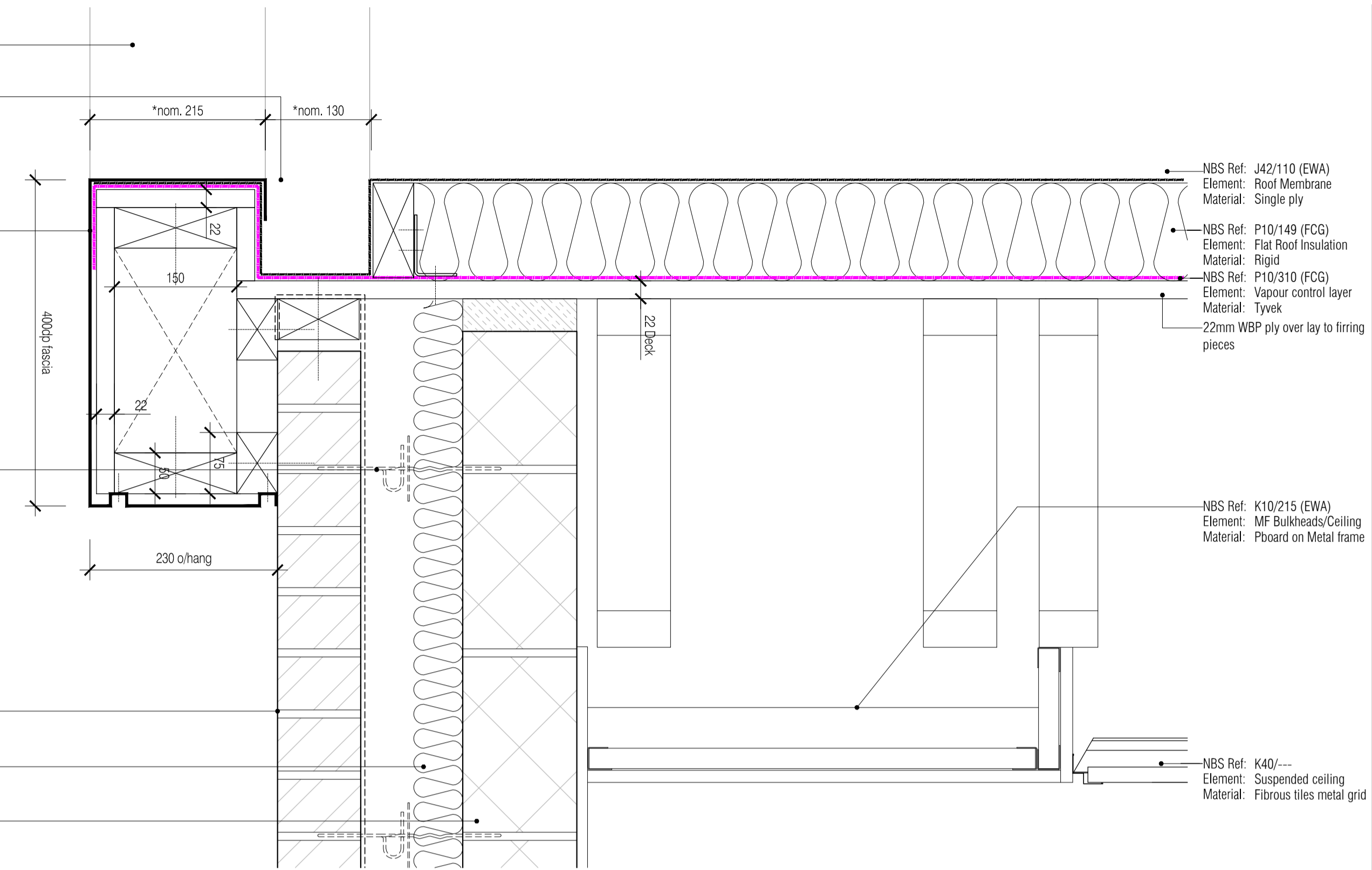

NBS Ref: J42/110 (EWA)
Element: Roof Membrane
Material: Single ply

NBS Ref: P10/149 (FCG)
Element: Flat Roof Insulation
Material: Rigid

NBS Ref: P10/310 (FCG)
Element: Vapour control layer
Material: Tyvek

22mm WBP ply over lay to firring pieces

NBS Ref: K10/215 (EWA)
Element: MF Bulkheads/Ceiling
Material: Pboard on Metal frame

NBS Ref: K40/---
Element: Suspended ceiling
Material: Fibrous tiles metal grid

NOTES: Do not scale this drawing. All dimensions to be checked on site prior to commencement or manufacture.

ISSUED FOR CONSTRUCTION

Rev	Date	By	Clk	Comment
C2	24.05.13	DOD	JAS	Client VE Amends and Gen. Details Added
C1	07.03.13	ES	JAS	Issued for Construction
A1	09.10.12	RKC	JAS	First Formal Issue. Stage F issue

25 YEARS OF BRINGING IDEAS TO LIFE

ANNIVERSARY
25
YEARS
1982-2007

FRANKHAM

Frankham Consultancy Group Limited
Frankham House Woolton Business Park
Besselsleigh Road Woolton Abingdon
Oxfordshire OX13 6FD
T 01865 322500 F 01865 327393
E enquire@frankham.com
www.frankham.com

Client
Leadbitter
CONSTRUCTION

Project Title
Whitehall Junior & Infant School
Refurbishment, Extension and New Build
Cowley Road
London Borough of Hillingdon

Drawing Title
New Infant Block
Typical Details
Sheet 3

Drawn by: RKC	Scale: 1:5@A1	Date: 03.10.12
Designed by: FCG	Checked by: JAS	Approved by: AC

File Ref: \\NBS004\NBS-HELP\2010\001-11\WHITEHALL JUNIOR & INFANT SCHOOL\DETAILS\BUILDING...
14.04.24.10.49.56

Drawing No. 611869-A-509	Rev. C2
-----------------------------	------------